

CONNECTOR MANUFACTURERS

TOPTek®
HARDWARE ELECTRONIC MANUFACTURER

www.toptek-co.com

Pin Header 5.08mm 1 Row H=2.5mm SMT / Stack SMT Type

Specifications
 Current Rate: 7 AMP
 Insulation Resistance: 1000MΩ Min.
 Contact Resistance: 20mΩ Max.
 Dielectric Voltage: 1000V AC for one minute
 Operation Temperature: -40°C to +105°C

Material
 Insulator: Polyester, UL 94V-0
 ©Standard: LCP
 Terminal: Copper Alloy
 Plating: Tin Plated

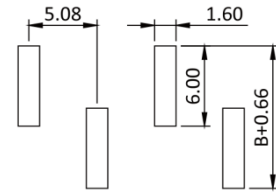
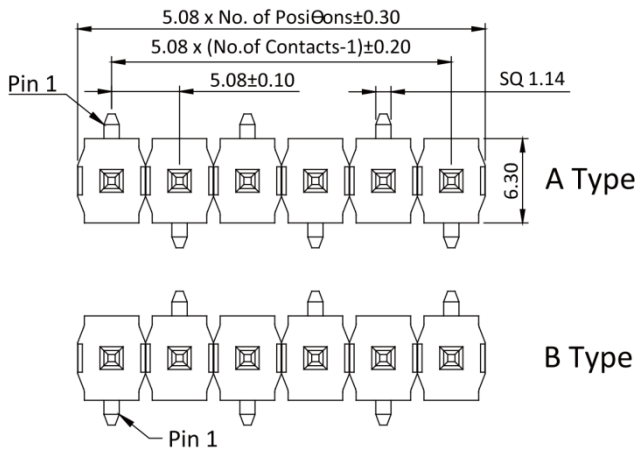
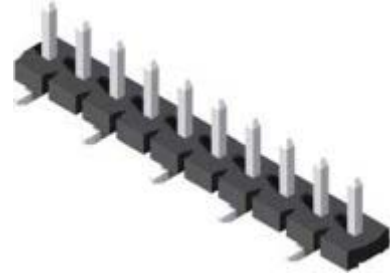

A Type

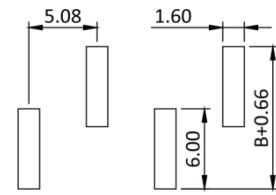

B Type

Recommended PCB Layout
(PCB TOLERANCE ±0.05)

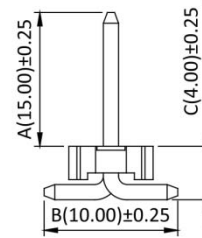
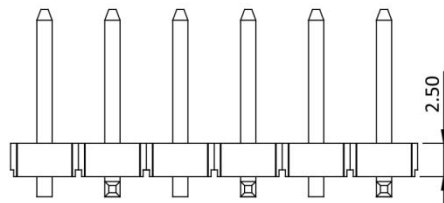

ORDER INFORMATION

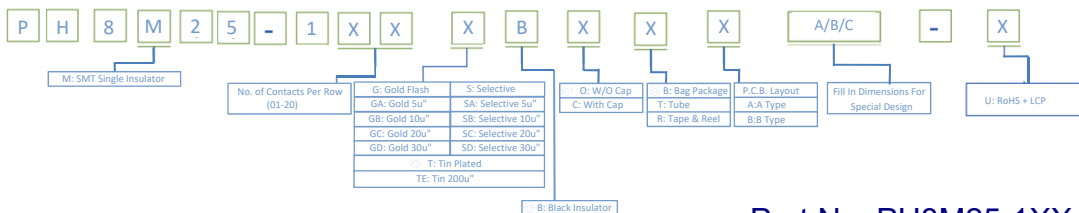

©: Standard Recommend

Part No.: PH8M25-1XX-X

www.toptek-co.com

info@toptek-co.com

