

REV.	DESCRIPTION	DRAWN	CHECKED	APPROVED
A	NEW RELEASE	TYF 06/03/04'	谭玉芬	

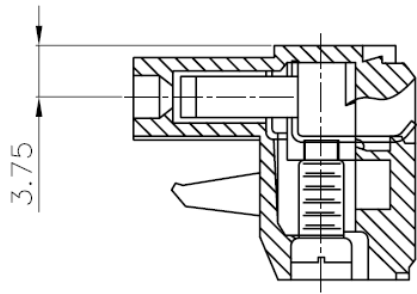

SECTION A-A

- MATERIAL
CONTACT : PHOSPHOR BRONZE
SCREWS : M2.5 STEEL ZINC PLATED
HOUSING : PA66, UL94V-0
- ELECTRICAL
RATED VOLTAGE : 300V
RATED CURRENT : 15A
CONTACT RESISTANCE : 20mΩ
INSULATION RESISTANCE : 5000MΩ/1000V
WITHSTANDING VOLTAGE : AC2000V/1Min
WIRE RANGE : 28-12AWG 2.5mm²
- MECHANICAL
TEMP.RANGE : -40°C~+105°C
MAX SOLDERING : +250°C, FOR 5 SEC.
TORQUE : 0.4Nm(3.6LB.IN)
STRIP LENGTH : 7-8mm

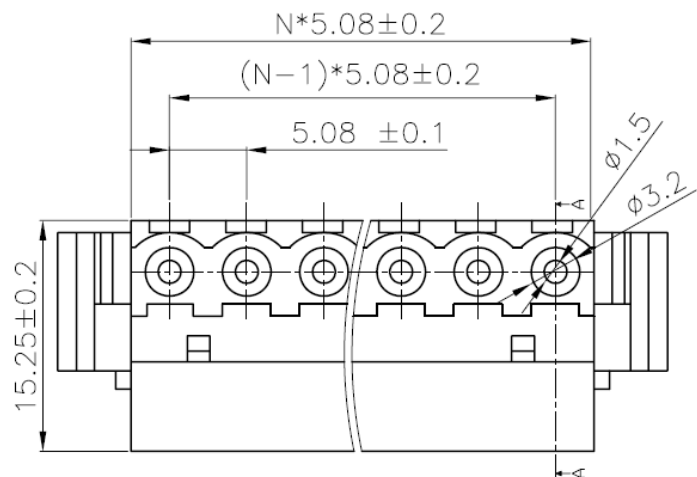
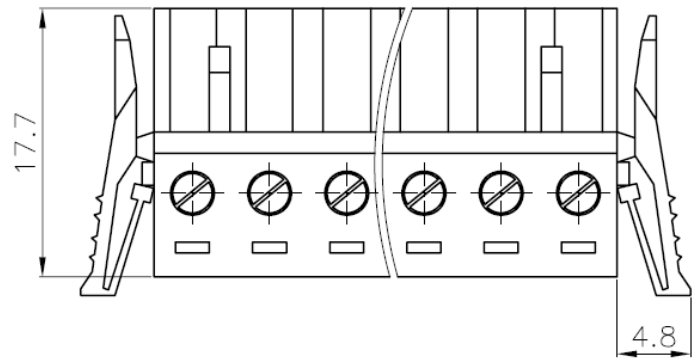

PRODUCT NUMBER CODE:
KF220 - X X
 No.OF CONTACTS
 02 03 08 16
 PITCH5.08MM
 SERIES No.
 F220

Disponibili con passo : 5.00, 7.5, 7.62MM

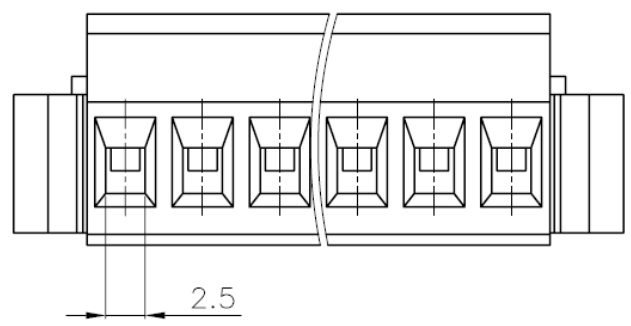

GENERAL TOLERANCE	ANGLE TOLERANCE	PROJECTION		TITLE	PLUGGABLE TERMINAL BLOCKS PITCH5.08MM
X. ±0.60	X. ±5°	UNITS	mm		
.X ±0.38	.X ±3°	SHEET SIZE	A4	SERIES	
.XX ±0.25	.XX ±2°	 www.toptek-co.com		SERIES	KF220 SERIES
DRAWING TYPE	CUSTOMER				
SCALE	1:1	SHEET	1 OF 1		
DRAWING NO.	F220-XXXX				