

CONNECTORS MANUFACTURER

Modular Jack Shielded Side Entry H=12.0 W=18.9

Material & Finish:
 Housing:Glass Fiber,PBT. UL94V-0
 Contact:0.35 mm Thickness Phosphor Bronze,
 Gold Plated Over Nickel on Contact Area,
 Tin Plated Over Nickel on Solder Area.

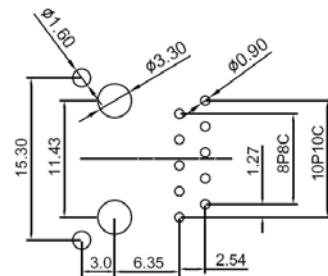
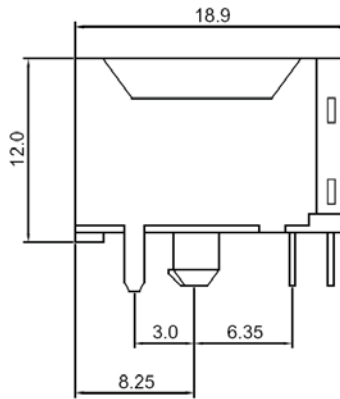
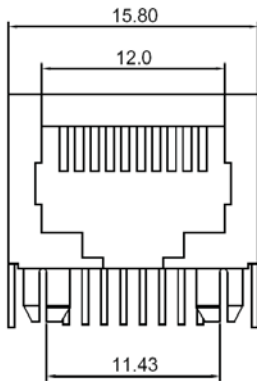
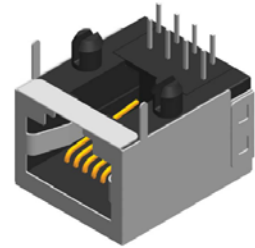

Recommended PCB Layout
 (PCB TOLERANCE ±0.05)

Order Information

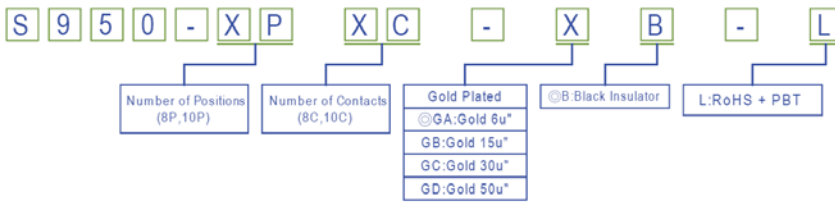

Modular Jack SMT Type Single Pory H=11.35 W=13.40

Material & Finish:
 Housing:Glass Fiber,LCP . UL94V-0
 Contact:0.35 mm Thickness Phosphor Bronze,
 Gold Plated Over Nickel on Contact Area,
 Tin Plated Over Nickel on Solder Area.

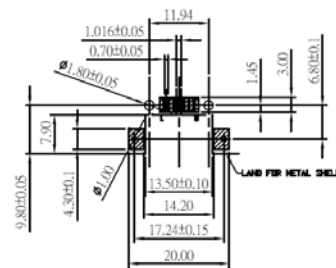
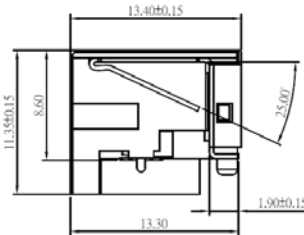
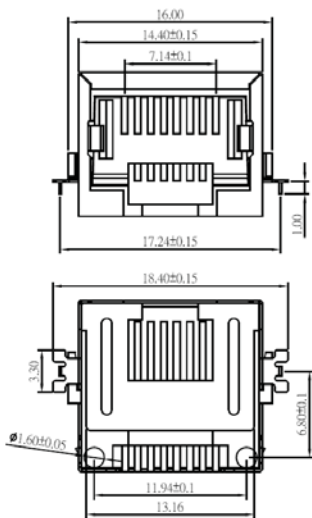
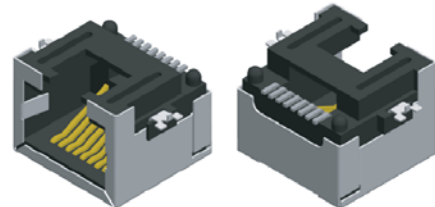

Recommended PCB Layout
 (PCB TOLERANCE ±0.05)

Order Information

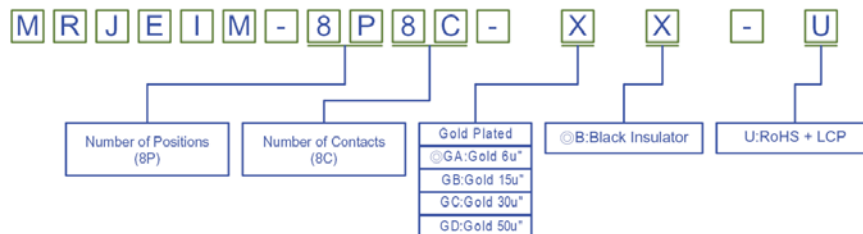

Modular Jack



RoHS