

## DVI Female Straight Dip Type 24Pin

### SPECIFICATION

Current Rate:1 AMP  
 Insulation Resistance:1000MΩ Min.  
 Contact Resistance:30mΩ Max.  
 Dielectric Voltage:250V AC for one minute  
 Operation Temperature:-55°C to +85°C

### MATERIAL

Insulator:Polyester,UL 94V-0  
 ◎Standard:Nylon 66  
 Contact Pin:Copper Alloy  
 Contact Plating:Selective

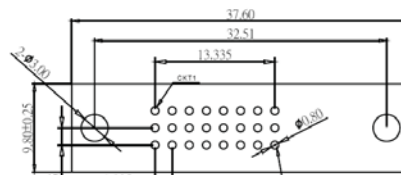
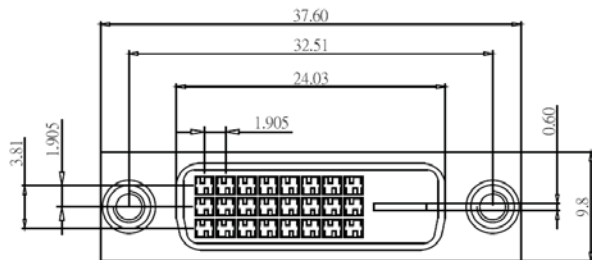
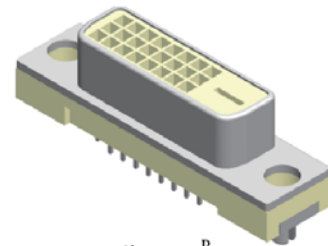

Recommended PCB Layout  
(PCB TOLERANCE ±0.05)

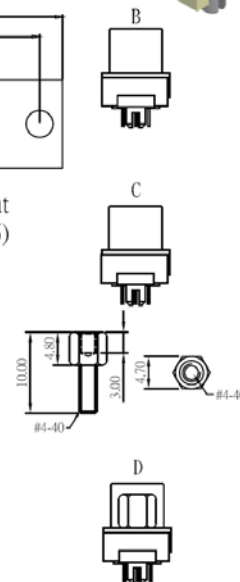
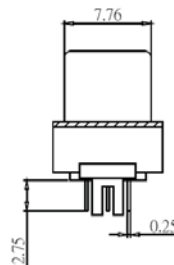
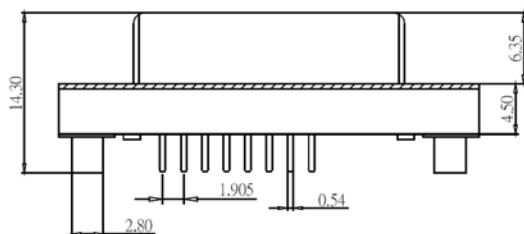

## DVI Female Straight Dip Type 29Pin

### SPECIFICATION

Current Rate:1 AMP  
 Insulation Resistance:1000MΩ Min.  
 Contact Resistance:30mΩ Max.  
 Dielectric Voltage:250V AC for one minute  
 Operation Temperature:-55°C to +85°C

### MATERIAL

Insulator:Polyester,UL 94V-0  
 ◎Standard:Nylon 66  
 Contact Pin:Copper Alloy  
 Contact Plating:Selective

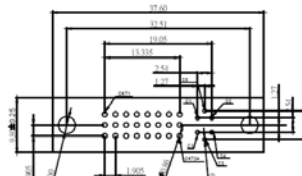
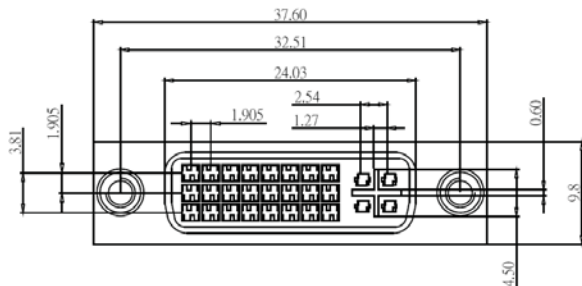
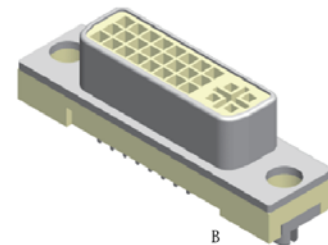

Recommended PCB Layout  
(PCB TOLERANCE ±0.05)

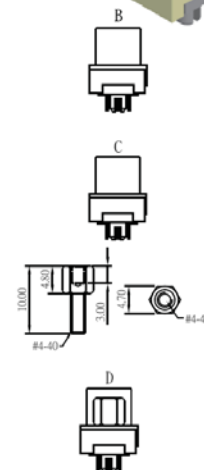
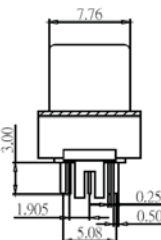
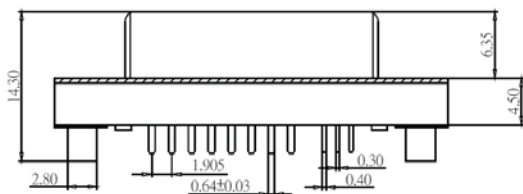

## ORDER INFORMATION

