

# Rocker Switch



Rating: 10A 125VAC ; 6A 250VAC  
 Contact Resistance: 35m Ω max  
 Insulation Resistance: 500VDC 100M Ω min

Dielectric Strength: 1500VAC, 1 Minute  
 Operating Temperature: -25°C~ +85°C  
 Electrical Life: ≥ 10,000 Cycles



## A-TOP1-101

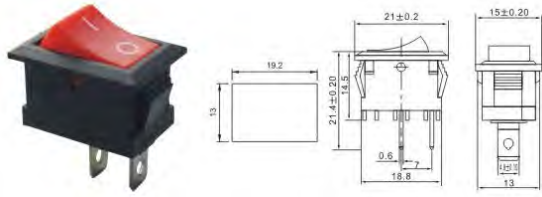

A-TOP1-101 ON-OFF

## A-TOP1-1-101

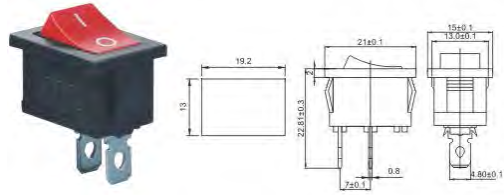

A-TOP1-1-101 ON-OFF

14  
\*  
9

## A-TOP1-102

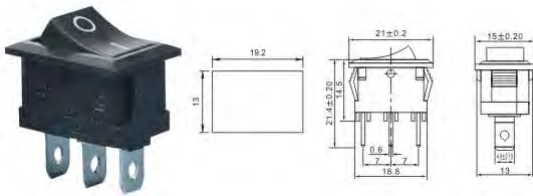

A-TOP1-102 ON-ON

## A-TOP1-1-102

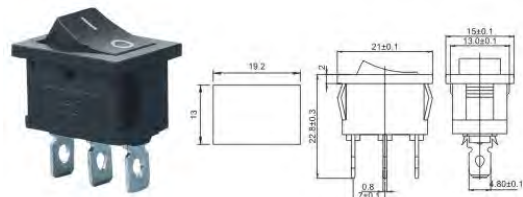

A-TOP1-1-102 ON-ON

## A-TOP1-2-101 / 111

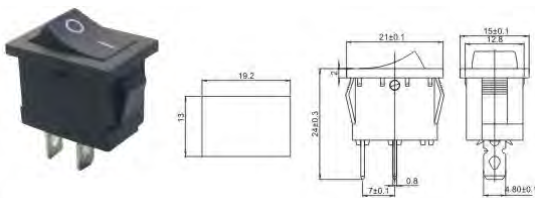

A-TOP1-2-101 ON-OFF  
 A-TOP1-2-111 OFF-(ON)

## A-TOP1-2-101N

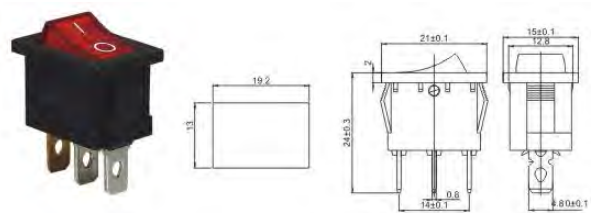

A-TOP1-2-101N ON-OFF

## A-TOP1-3-101EN

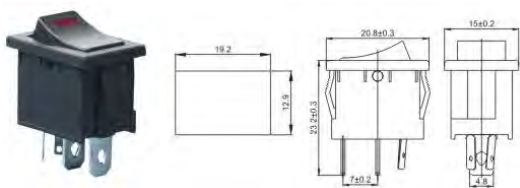

A-TOP1-3-101EN ON-OFF (3V LED)

## A-TOP1-4-201

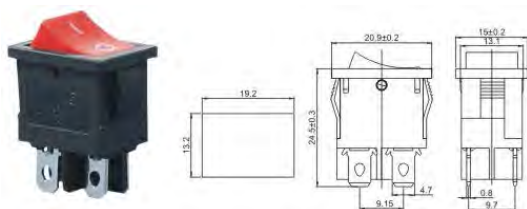

A-TOP1-4-201 ON-OFF

