

Anti-Vandal Switch

TOPTEK®

HARDWARE ELECTRONIC MANUFACTURER



www.toptek-co.com

TOPTEK srl
10015 - IVREA (TO) - ITALY
tel. +39 0125 251 211 - fax +39 0341 367 607
info@toptek-co.com

Ø 10 - 12 mm

TOPTek®
HARDWARE ELECTRONIC MANUFACTURER



C-TOP-12B



Diameter: Ø 12mm
Color: R, G, Y, O, B, W
Switch Rating: 2A/36VDC
Contact Configuration: 1NO
Operation Type: Momentary
The Crust Material: PC
IP Degree: IP67, IK08

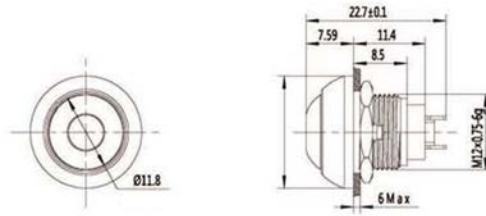

14
*
37

C-TOP-12B-DM



Diameter: Ø 12mm
Color: R, G, Y, O, B, W
Switch Rating: 2A/36VDC
Contact Configuration: 1NO
Operation Type: Momentary
The Crust Material: PC
IP Degree: IP67, IK08

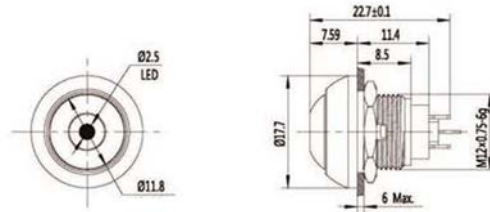

C-TOP-12B-L



Diameter: Ø 12mm
Color: R, G, Y, O, B, W
Switch Rating: 2A/36VDC
Contact Configuration: 1NO
Operation Type: Momentary
The Crust Material: PC
IP Degree: IP67, IK08

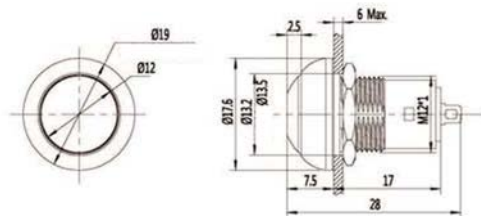

C-TOP-12B-DL



Diameter: Ø 12mm
Color: R, G, Y, O, B, W
Switch Rating: 2A/36VDC
Contact Configuration: 1NO
Operation Type: Momentary
The Crust Material: PC
IP Degree: IP67, IK08

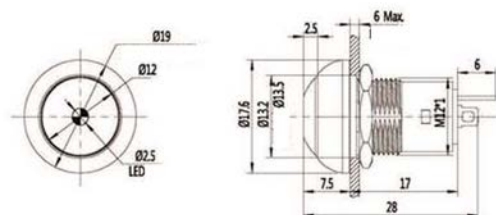

CONNECTOR MANUFACTURERS

TOPTEK®
HARDWARE ELECTRONIC MANUFACTURER

www.toptek-co.com

Ø 10 - 12 mm

W-TOP-12S



Diameter: Ø 12mm
Color: R, G, Y, O, B, W
Switch Rating: 2A/36VDC
Contact Configuration: 1NO
Operation Type: Momentary
The Crust Material: PC
IP Degree: IP67, IK08

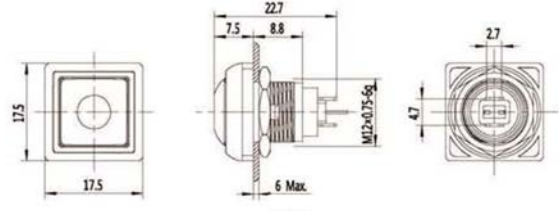

W-TOP-12S-DM



Diameter: Ø 12mm
Color: R, G, Y, O, B, W
Switch Rating: 2A/36VDC
Contact Configuration: 1NO
Operation Type: Momentary
The Crust Material: PC
IP Degree: IP67, IK08

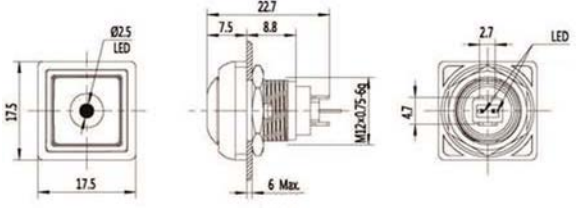

Z-TOP-10H-11



Diameter: Ø 10mm
Switch Rating: 3A/250VAC
Contact Configuration: 1NO 1NC
Operation Type:
• Momentary
• Maintained
The Front Shape: High
The Crust Material:
• Stainless steel
IP Degree: IP67, IK10

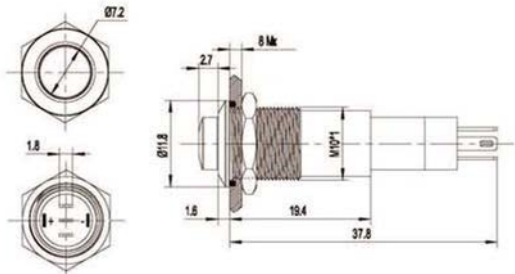

Z-TOP-10H-11E



Diameter: Ø 10mm
Switch Rating: 3A/250VAC
Contact Configuration: 1NO 1NC
Operation Type:
• Momentary
• Maintained
The Front Shape: High
Lamp type: Ring illuminated (LED)
The Crust Material:
• Stainless steel
IP Degree: IP67, IK10

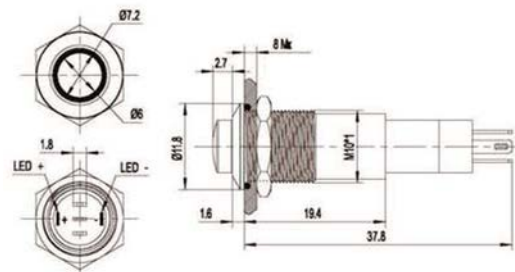

Ø 10 - 12 mm

TOPTek®
HARDWARE ELECTRONIC MANUFACTURER



www.toptek-co.com

Z-TOP-10H-11D



Diameter: Ø 10mm
 Switch Rating: 3A/250VAC
 Contact Configuration: 1NO 1NC
 Operation Type:
 • Momentary
 • Maintained
 The Front Shape: High
 Lamp type: Ring illuminated (LED)
 The Crust Material:
 • Stainless steel
 IP Degree: IP67, IK10

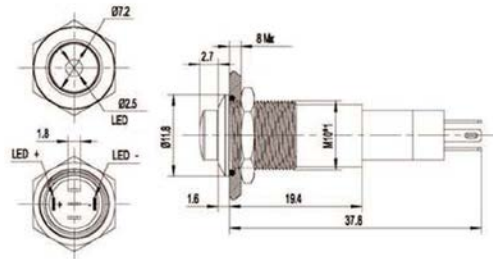

14
*
39

Z-TOP-12BJ-A



Diameter: Ø 12mm
 Color: R, G, Y, O, B, W
 Switch Rating: 2A/36VDC
 Contact Configuration: 1NO
 Operation Type: Momentary
 The Crust Material: Zinc alloy
 IP Degree: IP67, IK08

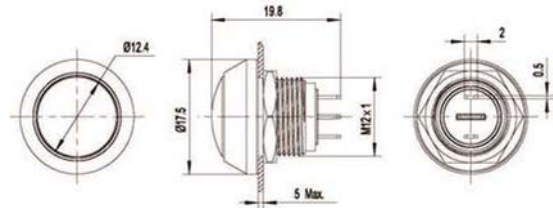

Z-TOP-12B-A



Diameter: Ø 12mm
 Color: R, G, Y, O, B, W
 Switch Rating: 2A/36VDC
 Contact Configuration: 1NO
 Operation Type: Momentary
 The Crust Material: Zinc alloy
 IP Degree: IP67, IK08

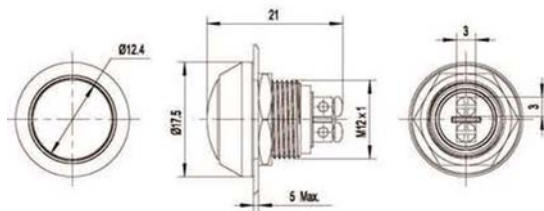

Z-TOP-12BJ-N



Diameter: Ø 12mm
 Color: R, G, Y, O, B, W
 Switch Rating: 2A/36VDC
 Contact Configuration: 1NO
 Operation Type: Momentary
 The Crust Material: Chromium plated brass
 IP Degree: IP67, IK08

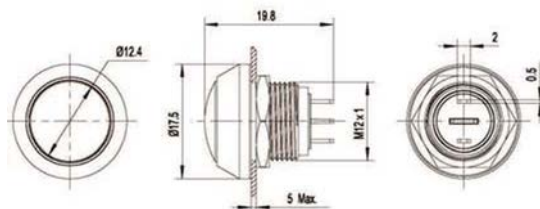

CONNECTOR MANUFACTURERS

TOPTEK®
HARDWARE ELECTRONIC MANUFACTURER

www.toptek-co.com

Ø 10 - 12 mm

Z-TOP-12B-N



Diameter: Ø 12mm
Color: R, G, Y, O, B, W
Switch Rating: 2A/36VDC
Contact Configuration: 1NO
Operation Type: Momentary
The Crust Material:
Chromium plated brass
IP Degree: IP67, IK08

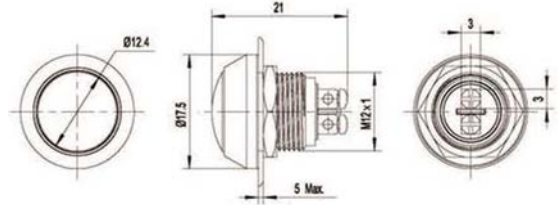

Z-TOP-12BJ



Diameter: Ø 12mm
Switch Rating: 2A/36VDC
Contact Configuration: 1NO
Operation Type: Momentary
The Crust Material:

- Stainless steel
- Copper plating

 IP Degree: IP67, IK08

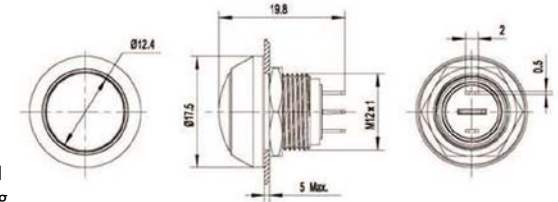

Z-TOP-Q12B



Diameter: Ø 12mm
Switch Rating: 2A/36VDC
Contact Configuration: 1NO
Operation Type: Momentary
The Crust Material:

- Stainless steel
- Copper plating

 IP Degree: IP67, IK08

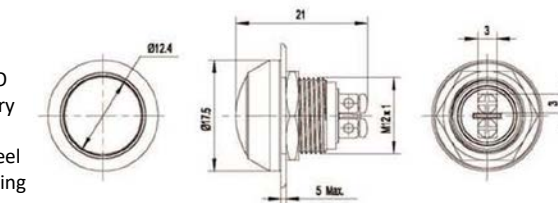

Z-TOP-Q12BJ-L



Diameter: Ø 12mm
Switch Rating: 2A/36VDC
Contact Configuration: 1NO
Operation Type: Momentary
The Crust Material:

- Stainless steel
- Copper plating

 IP Degree: IP67, IK08

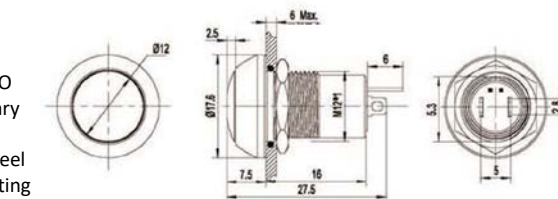

Ø 10 - 12 mm

TOPTEK®
HARDWARE ELECTRONIC MANUFACTURER



www.toptek-co.com

Z-TOP-Q12BJ-DL-N



Diameter: Ø 12mm
 Color: R, G, Y, O, B, W
 Switch Rating: 2A/36VAC
 Contact Configuration: 1NO
 Operation Type: Maintained
 Lamp type: Dot illuminated (LED)
 The Crust Material:

- Stainless steel
- Copper plating

IP Degree: IP67, IK10

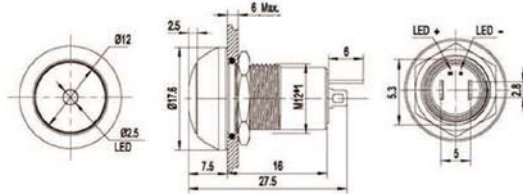

14
*
41

Z-TOP-12BJ-L-N



Diameter: Ø 12mm
 Color: R, G, Y, O, B, W
 Switch Rating: 2A/36VDC
 Contact Configuration: 1NO
 Operation Type: Momentary
 The Crust Material:

- Stainless steel
- Copper plating

IP Degree: IP67, IK08

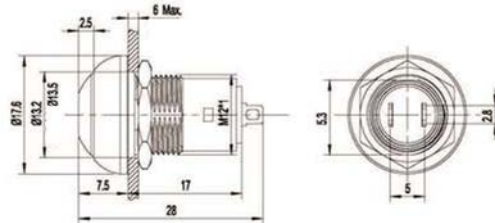

Z-TOP-12F-10EM



Diameter: Ø 12mm
 Color: R, G, Y, O, B, W
 Switch Rating: 2A/36VDC
 Contact Configuration: 1NO
 Operation Type: Momentary
 Lamp type: Ring illuminated (LED)
 The Crust Material: Stainless steel
 Degree: IP67, IK08

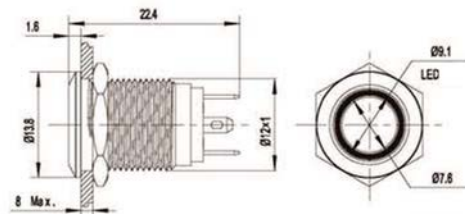

Z-TOP-12H-10EM



Diameter: Ø 12mm
 Color: R, G, Y, O, B, W
 Switch Rating: 2A/36VDC
 Contact Configuration: 1NO
 Operation Type: Momentary
 Lamp type: Ring illuminated (LED)
 The Crust Material: Stainless steel
 Degree: IP67, IK08

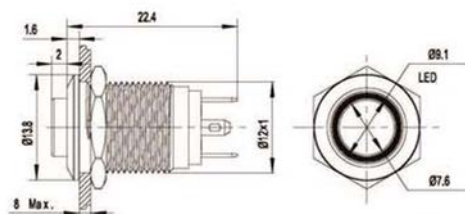

CONNECTOR MANUFACTURERS

TOPTEK®
HARDWARE ELECTRONIC MANUFACTURER

www.toptek-co.com

Ø 10 - 12 mm

Z-TOP-12H-10EPM



Diameter: Ø 12mm
Color: R, G, Y, O, B, W
Switch Rating: 2A/36VDC
Contact Configuration: 1NO
Operation Type: Momentary
Lamp type: Power symbol illuminated (LED)
The Crust Material: Stainless steel
Degree: IP67, IK08

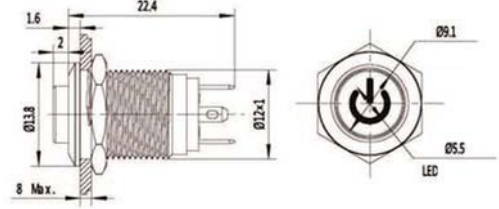

Z-TOP-12H-10L



Diameter: Ø 12mm
Switch Rating: 2A/36VDC
Contact Configuration: 1NO
Operation Type: Maintained
The Crust Material:
• Stainless steel
IP Degree: IP67, IK08

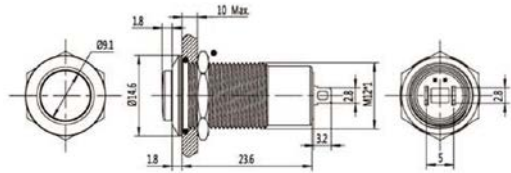

Z-TOP-12H-10EL



Diameter: Ø 12mm
Switch Rating: 2A/36VDC
Contact Configuration: 1NO
Operation Type: Maintained
Lamp type: Ring illuminated (LED)
The Crust Material: Stainless steel
IP Degree: IP67, IK08

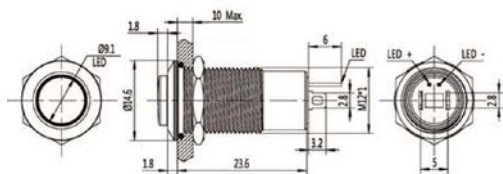

Z-TOP-12H-10DL



Diameter: Ø 12mm
Switch Rating: 2A/36VDC
Contact Configuration: 1NO
Operation Type: Maintained
Lamp type: Dot illuminated (LED)
The Crust Material: Stainless steel
IP Degree: IP67, IK08

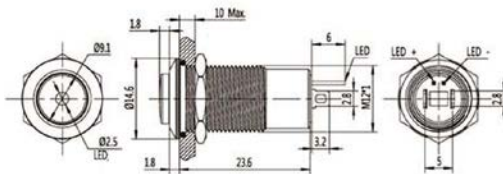

Ø 16 mm

TOPTEK®
HARDWARE ELECTRONIC MANUFACTURER



C-TOP-16F-J



Diameter: Ø 16mm
 Switch Rating: 3A/250VAC
 Contact Configuration: 1NO
 Operation Type: Momentary
 The Front Shape: Flat
 The Crust Material:

- Stainless steel
- Copper plating

IP Degree: IP67, IK10

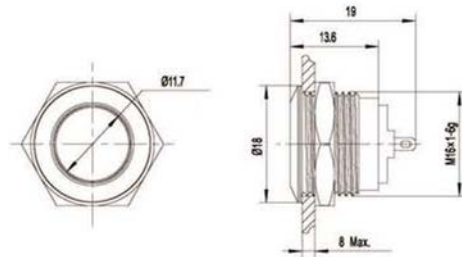

C-TOP-16B-J



Diameter: Ø 16mm
 Switch Rating: 3A/250VAC
 Contact Configuration: 1NO
 Operation Type: Momentary
 The Front Shape: Ball
 The Crust Material:

- Stainless steel
- Copper plating

IP Degree: IP67, IK10

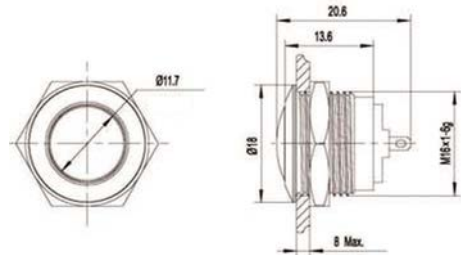

C-TOP-16H-J



Diameter: Ø 16mm
 Switch Rating: 3A/250VAC
 Contact Configuration: 1NO
 Operation Type: Momentary
 The Front Shape: High
 The Crust Material:

- Stainless steel
- Copper plating

IP Degree: IP67, IK10

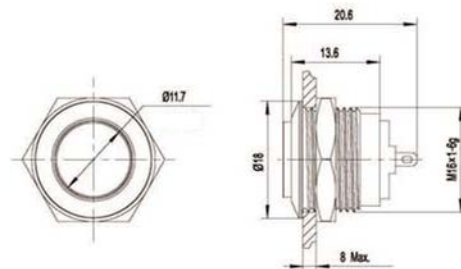

C-TOP-16F



Diameter: Ø 16mm
 Switch Rating: 3A/250VAC
 Contact Configuration: 1NO
 Operation Type: Momentary
 The Front Shape: Flat
 The Crust Material:

- Stainless steel
- Copper plating

IP Degree: IP67, IK10

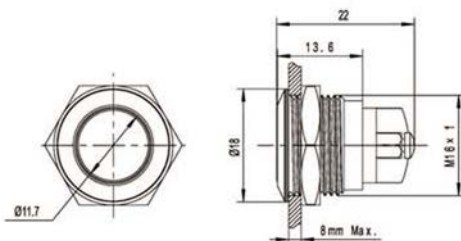

14
*
43



CONNECTOR MANUFACTURERS

TOPTEK®
HARDWARE ELECTRONIC MANUFACTURER

www.toptek-co.com

Ø 16 mm

C-TOP-16B



Diameter: Ø 16mm
Switch Rating: 3A/250VAC
Contact Configuration: 1NO
Operation Type: Momentary
The Front Shape: Flat
The Crust Material:

- Stainless steel
- Copper plating

IP Degree: IP67, IK10

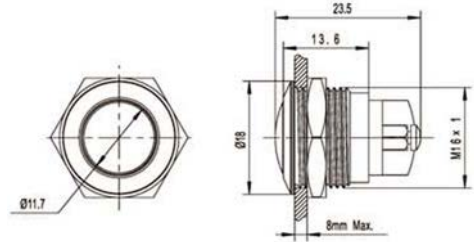

C-TOP-16H



Diameter: Ø 16mm
Switch Rating: 3A/250VAC
Contact Configuration: 1NO
Operation Type: Momentary
The Front Shape: High
The Crust Material:

- Stainless steel
- Copper plating

IP Degree: IP67, IK10

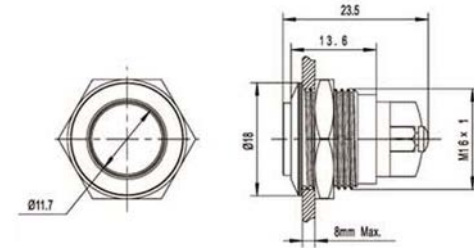

C-TOP-16FJ-L



Diameter: Ø 16mm
Switch Rating: 3A/250VAC
Contact Configuration: 1NO
Operation Type: Maintained
The Front Shape: Flat
The Crust Material:

- Stainless steel

IP Degree: IP67, IK10

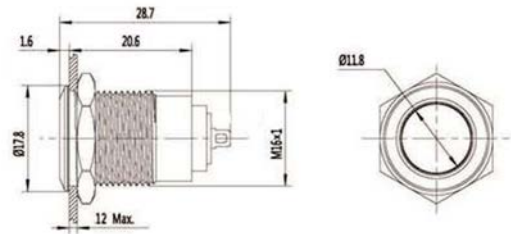

C-TOP-16BJ-L



Diameter: Ø 16mm
Switch Rating: 3A/250VAC
Contact Configuration: 1NO
Operation Type: Maintained
The Front Shape: Ball
The Crust Material:

- Stainless steel

IP Degree: IP67, IK10

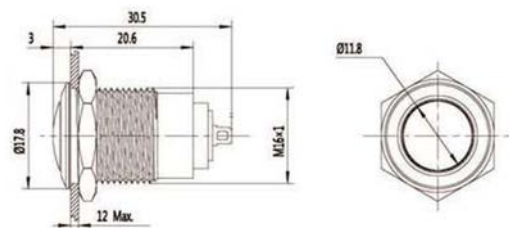

Ø 16 mm

TOPTTEK®
HARDWARE ELECTRONIC MANUFACTURER

C-TOP-16HJ-L



Diameter: Ø 16mm
 Switch Rating: 3A/250VAC
 Contact Configuration: 1NO
 Operation Type: Maintained
 The Front Shape: High
 The Crust Material:
 • Stainless steel
 IP Degree: IP67, IK10

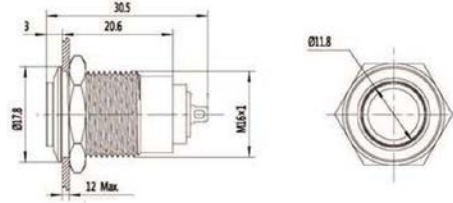

www.toptek-co.com

14
*
45

C-TOP-16F-10EM



Diameter: Ø 16mm
 Color: R, G, Y, O, B, W
 Switch Rating: 3A/250VAC
 Contact Configuration: 1NO
 Operation Type: Momentary
 The Front Shape: Flat
 Lamp type: Ring illuminated (LED)
 The Crust Material:
 • Stainless steel
 • Copper plating
 IP Degree: IP67, IK10

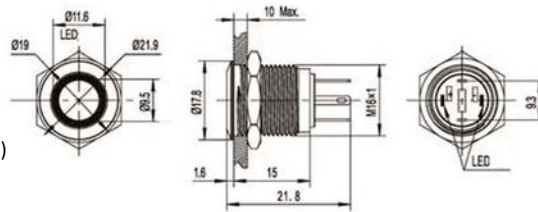

C-TOP-16H-10EM



Diameter: Ø 16mm
 Switch Rating: 3A/250VAC
 Contact Configuration: 1NO
 Operation Type: Momentary
 The Front Shape: High
 Lamp type: Ring illuminated (LED)
 The Crust Material:
 • Stainless steel
 • Copper plating
 IP Degree: IP67, IK10

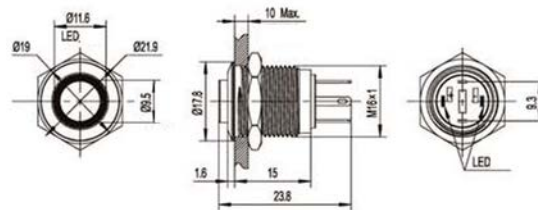

C-TOP-16F-10EPM



Diameter: Ø 16mm
 Switch Rating: 3A/250VAC
 Contact Configuration: 1NO
 Operation Type: Momentary
 The Front Shape: Flat
 Lamp type: Power symbol illuminated (LED)
 The Crust Material:
 • Stainless steel
 • Copper plating
 IP Degree: IP67, IK10

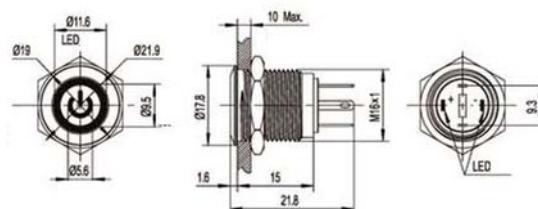

CONNECTOR MANUFACTURERS



Ø 16 mm

C-TOP-16F-10DM



Diameter: Ø 16mm
 Switch Rating: 3A/250VAC
 Contact Configuration: 1NO
 Operation Type: Momentary
 The Front Shape: Flat
 Lamp type: Dot illuminated (LED)
 The Crust Material:

- Stainless steel
- Copper plating

IP Degree: IP67, IK10

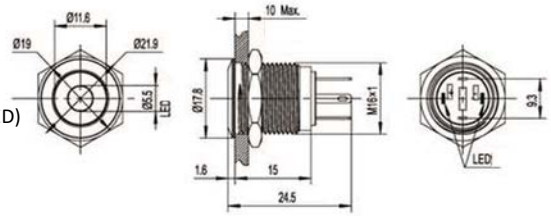

E-TOP-16FJ-L-S



Diameter: Ø 16mm
 Switch Rating: 3A/250VAC
 Contact Configuration: 1NO 1NC
 Operation Type:

- Momentary
- Maintained

The Front Shape: Flat
 The Crust Material:

- Stainless steel

IP Degree: IP67, IK10

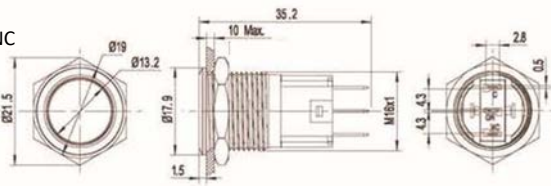

E-TOP-16H



Diameter: Ø 16mm
 Switch Rating: 3A/250VAC
 Contact Configuration: 1NO 1NC
 Operation Type:

- Momentary
- Maintained

The Front Shape: Flat
 The Crust Material:

- Stainless steel

IP Degree: IP67, IK10

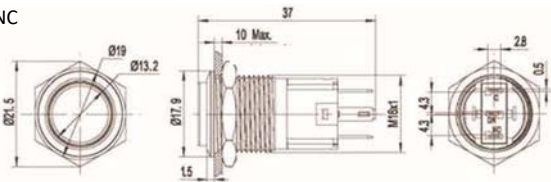

E-TOP-16F-11EP



Diameter: Ø 16mm
 Switch Rating: 3A/250VAC
 Contact Configuration: 1NO 1NC
 Operation Type:

- Momentary
- Maintained

The Front Shape: Flat
 Lamp type: Power symbol illuminated (LED)
 The Crust Material: Stainless steel
 IP Degree: IP67, IK10

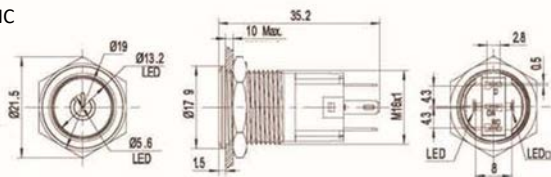

Ø 16 mm

TOPTEK®
HARDWARE ELECTRONIC MANUFACTURER



E-TOP-16F-11E



Diameter: Ø 16mm
Color: R, G, Y, O, B, W
Switch Rating: 3A/250VAC
Contact Configuration: 1NO 1NC
Operation Type:

- Momentary
- Maintained

The Front Shape: Flat

Lamp type: Ring illuminated (LED)

The Crust Material: Stainless steel

IP Degree: IP67, IK10

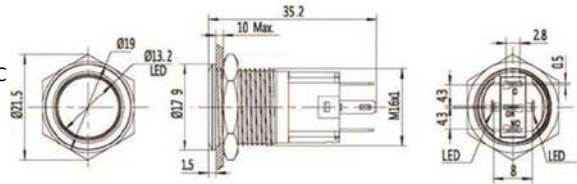

E-TOP-16H-11E



Diameter: Ø 16mm
Color: R, G, Y, O, B, W
Switch Rating: 3A/250VAC
Contact Configuration: 1NO 1NC
Operation Type:

- Momentary
- Maintained

The Front Shape: High

Lamp type: Ring illuminated (LED)

The Crust Material: Stainless steel

IP Degree: IP67, IK10

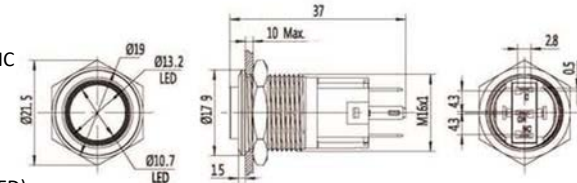

E-TOP-16F-11D



Diameter: Ø 16mm
Color: R, G, Y, O, B, W
Switch Rating: 3A/250VAC
Contact Configuration: 1NO 1NC
Operation Type:

- Momentary
- Maintained

The Front Shape: Flat

Lamp type: Dot illuminated (LED)

The Crust Material: Stainless steel

IP Degree: IP67, IK10

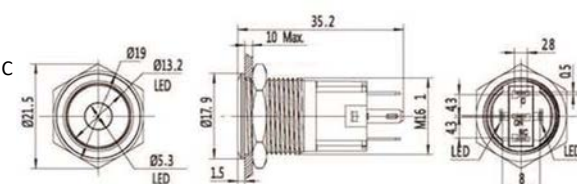

E-TOP-16H-11D



Diameter: Ø 16mm
Color: R, G, Y, O, B, W
Switch Rating: 3A/250VAC
Contact Configuration: 1NO 1NC
Operation Type:

- Momentary
- Maintained

The Front Shape: High

Lamp type: Dot illuminated (LED)

The Crust Material: Stainless steel

IP Degree: IP67, IK10

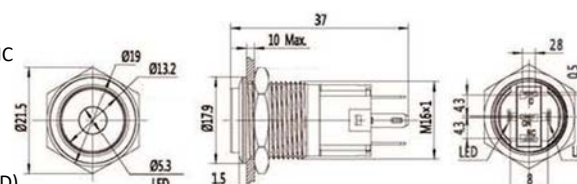

CONNECTOR MANUFACTURERS

TOPTEK®
HARDWARE ELECTRONIC MANUFACTURER

www.toptek-co.com

Ø 19 mm

G-TOP-19F



Diameter: Ø 19mm
Switch Rating: 5A/250VAC
Contact Configuration: 1NO
Operation Type: Momentary
The Front Shape: Flat
The Crust Material:

- Stainless steel

IP Degree: IP68, IK10

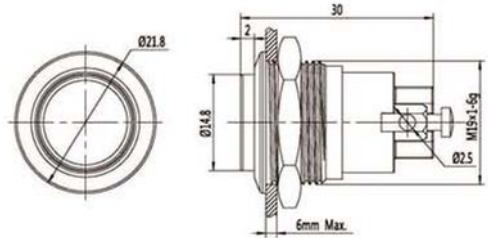

G-TOP-19B



Diameter: Ø 19mm
Switch Rating: 5A/250VAC
Contact Configuration: 1NO
Operation Type: Momentary
The Front Shape: Ball
The Crust Material:

- Stainless steel

IP Degree: IP68, IK10

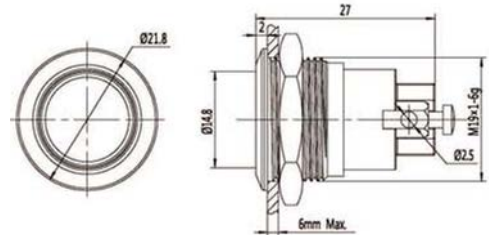

G-TOP-19H



Diameter: Ø 19mm
Switch Rating: 5A/250VAC
Contact Configuration: 1NO
Operation Type: Momentary
The Front Shape: High
The Crust Material:

- Stainless steel

IP Degree: IP68, IK10

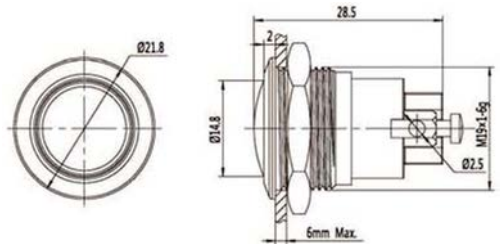

P-TOP-19B-2



Diameter: Ø 19mm
Switch Rating: 5A/250VAC
Contact Configuration: 1NO
Operation Type: Momentary
The Front Shape: Flat
The Crust Material:

- Stainless steel
- Copper plating

IP Degree: IP67, IK10

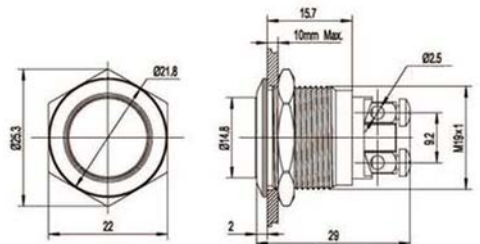

Ø 19 mm

TOPTEK®
HARDWARE ELECTRONIC MANUFACTURER



P-TOP-19B



Diameter: Ø 19mm
Switch Rating: 5A/250VAC
Contact Configuration: 1NO
Operation Type:

- Momentary

The Front Shape: Ball
The Crust Material:

- Stainless steel
- Copper plating

IP Degree: IP67, IK10

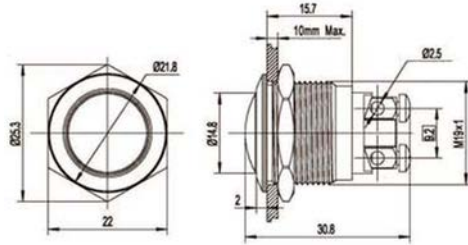

P-TOP-19B-4



Diameter: Ø 19mm
Switch Rating: 5A/250VAC
Contact Configuration: 1NO
Operation Type:

- Momentary

The Front Shape: High
The Crust Material:

- Stainless steel
- Copper plating

IP Degree: IP67, IK10

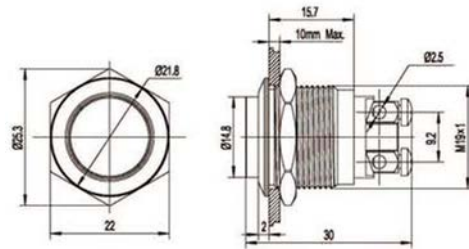

P-TOP-19B-2-J



Diameter: Ø 19mm
Switch Rating: 5A/250VAC
Contact Configuration: 1NO
Operation Type:

- Momentary

The Front Shape: Flat
The Crust Material:

- Stainless steel
- Copper plating

IP Degree: IP67, IK10

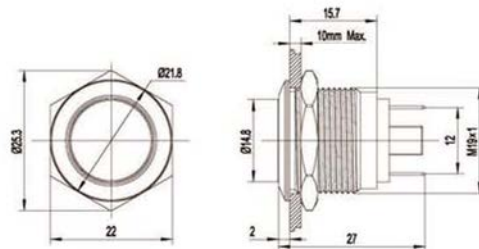

P-TOP-19B-J



Diameter: Ø 19mm
Switch Rating: 5A/250VAC
Contact Configuration: 1NO
Operation Type:

- Momentary

The Front Shape: Ball
The Crust Material:

- Stainless steel
- Copper plating

IP Degree: IP67, IK10

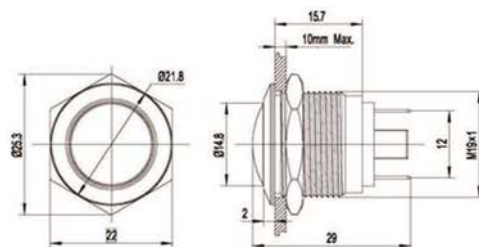

14
*
49



CONNECTOR MANUFACTURERS

TOPTEK®
HARDWARE ELECTRONIC MANUFACTURER

www.toptek-co.com

Ø 19 mm

P-TOP-19B-4-J



Diameter: Ø 19mm
 Switch Rating: 5A/250VAC
 Contact Configuration: 1NO
 Operation Type: Momentary
 The Front Shape: High
 The Crust Material:

- Stainless steel
- Copper plating

IP Degree: IP67, IK10

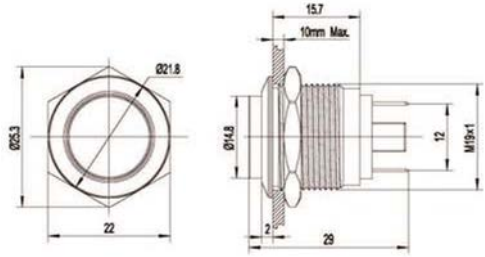

C-TOP-19F-11L-S



Diameter: Ø 19mm
 Switch Rating: 5A/250VAC
 Contact Configuration: 1NO 1NC/
 2NO 2NC
 Operation Type:

- Momentary
- Maintained (Z)

The Front Shape: Flat
 The Crust Material: Stainless steel
 IP Degree: IP67, IK10

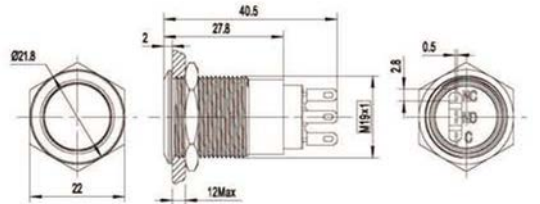

C-TOP-19B-11L-S



Diameter: Ø 19mm
 Switch Rating: 5A/250VAC
 Contact Configuration: 1NO 1NC/
 2NO 2NC
 Operation Type:

- Momentary
- Maintained (Z)

The Front Shape: Ball
 The Crust Material: Stainless steel
 IP Degree: IP67, IK10

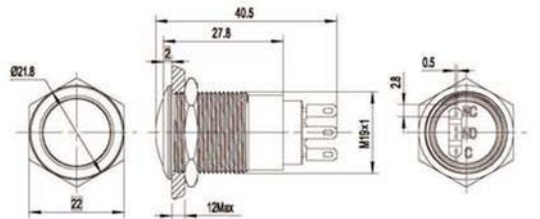

C-TOP-19H-11L-S



Diameter: Ø 19mm
 Switch Rating: 5A/250VAC
 Contact Configuration: 1NO 1NC/
 2NO 2NC
 Operation Type:

- Momentary
- Maintained (Z)

The Front Shape: High
 The Crust Material: Stainless steel
 IP Degree: IP67, IK10

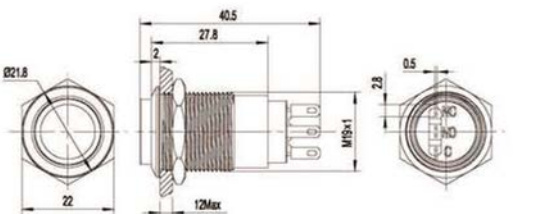

14
*
50

Anti-vandal Switch

Pb

ROHS

Ø 19 mm

TOPTEK®
HARDWARE ELECTRONIC MANUFACTURER



www.toptek-co.com

C-TOP-19F-E



Diameter: Ø 19mm
 Color: R, G, Y, O, B, W
 Switch Rating: 5A/250VAC
 Contact Configuration: 1NO 1NC/ 2NO 2NC
 Operation Type: Momentary
 • Maintained(Z)
 The Front Shape: Flat
 Lamp type: Ring illuminated(LED)
 The Crust Material:
 • Stainless steel
 • Copper plating
 IP Degree: IP67, IK10

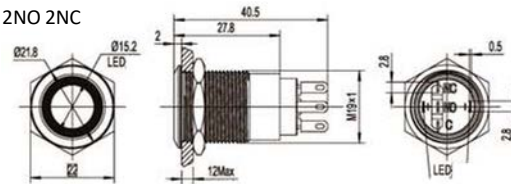

C-TOP-19F-D



Diameter: Ø 19mm
 Color: R, G, Y, O, B, W
 Switch Rating: 5A/250VAC
 Contact Configuration: 1NO 1NC/ 2NO 2NC
 Operation Type: Momentary
 • Maintained(Z)
 The Front Shape: Flat
 Lamp type: Dot illuminated(LED)
 The Crust Material:
 • Stainless steel
 IP Degree: IP67, IK10

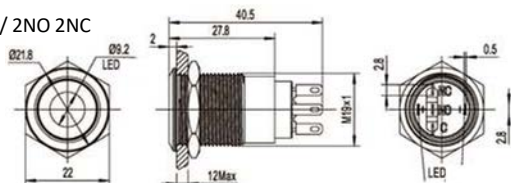

C-TOP-19B-E



Diameter: Ø 19mm
 Color: R, G, Y, O, B, W
 Switch Rating: 5A/250VAC
 Contact Configuration: 1NO 1NC/ 2NO 2NC
 Operation Type: Momentary
 • Maintained(Z)
 The Front Shape: Ball
 Lamp type: Ring illuminated(LED)
 The Crust Material:
 • Stainless steel
 • Copper plating
 IP Degree: IP67, IK10

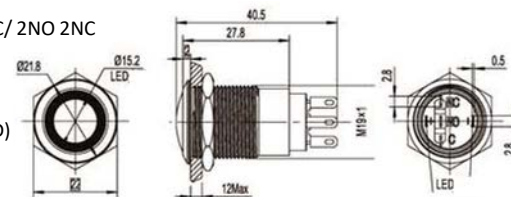

C-TOP-19BS-10EM



Diameter: Ø 19mm
 Color: R, G, Y, O, B, W
 Switch Rating: 5A/250VAC
 Contact Configuration: 1NO
 Operation Type: Momentary
 The Front Shape: Ball
 Lamp type: Ring illuminated(LED)
 The Crust Material:
 • Stainless steel
 IP Degree: IP67, IK10

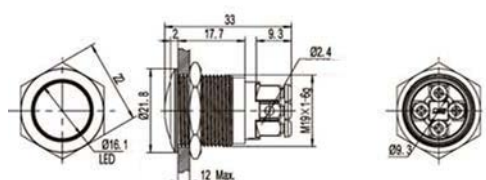

14
*
51



CONNECTOR MANUFACTURERS

TOPTek®
HARDWARE ELECTRONIC MANUFACTURER

www.toptek-co.com

Ø 19 mm

CA-TOP-19F-EP



Diameter: Ø 19mm
 Color: R, G, Y, O, B, W
 Switch Rating: 5A/250VAC
 Contact Configuration: 1NO 1NC/
 2NO 2NC
 Operation Type: Momentary
 • Maintained(Z)
 The Front Shape: Flat
 Lamp type: Power symbol
 illuminated(LED)
 The Crust Material: Stainless steel
 IP Degree: IP67, IK10

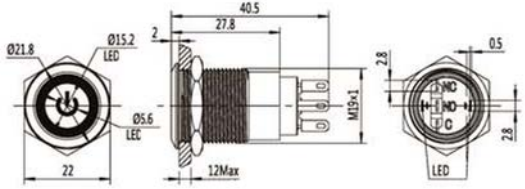

CA-TOP-19-K



Diameter: Ø 19mm
 Color: R, G, Y, O, B, W
 Switch Rating: 5A/250VAC
 Contact Configuration: 1NO 1NC/
 2NO 2NC
 Operation Type:
 • 2 Position
 • 3 Position
 The Front Shape: Selector
 Light way: Arrow
 The Crust Material: Stainless steel
 IP Degree: IP67, IK10

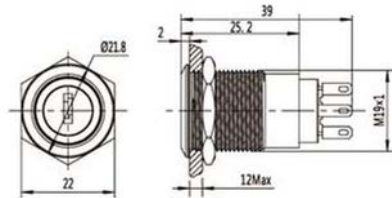

CA-TOP-19B-SR



Diameter: Ø 19mm
 Switch Rating: 5A/250VAC
 Contact Configuration: 1NO 1NC/ 2NO
 2NC
 Operation Type: Push-Lock Turn-reset
 The Front Shape: Ball
 Light way: Arrow
 The Crust Material: Stainless steel
 IP Degree: IP65, IK10

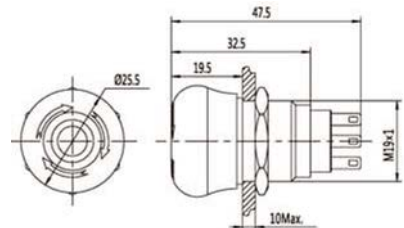

CA-TOP-19A-SR



Diameter: Ø 19mm
 Switch Rating: 5A/250VAC
 Contact Configuration: 1NO 1NC/ 2NO
 2NC
 Operation Type: Push-Lock Turn-reset
 The Front Shape: Ball
 Light way: Arrow
 The Crust Material: Stainless steel
 IP Degree: IP65, IK10

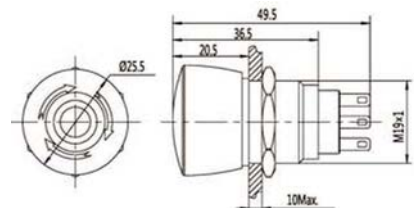

14
*
52

Anti-vandal Switch

Pb

ROHS

Ø 19 -22 mm

TOPTEK®
HARDWARE ELECTRONIC MANUFACTURER



CA-TOP-19-X



Diameter: Ø 19mm
Switch Rating: 5A/250VAC
Contact Configuration: 1NO 1NC/ 2NO 2NC
Operation Type:

- 2 Position
- 3 Position

 The Front Shape: Selector
 The Crust Material: Stainless steel
 IP Degree: IP67, IK10

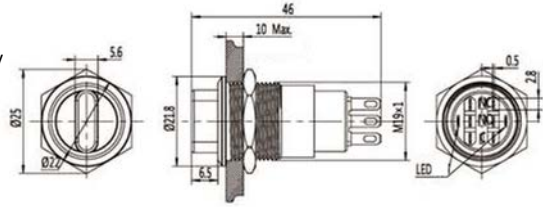

14
*
53

CA-TOP-19-XA



Diameter: Ø 19mm
Color: R, G, Y, O, B, W
Switch Rating: 5A/250VAC
Contact Configuration: 1NO 1NC/ 2NO 2NC
Operation Type:

- 2 Position
- 3 Position

 The Front Shape: Arrow
 The Crust Material:

- Stainless steel

 IP Degree: IP67, IK10

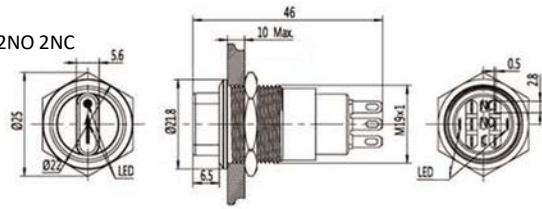

CA-TOP-19-BZ



Diameter: Ø 19mm
Its phonation type:

- Buzzer(M)
- Flicker Buzzer(SM)

 Flash color: R, G, Y, O, B, W
 Rated Voltage: DC12V/DC24V

- AC110V/AC220V

 Sound Intensity: ≥ 85dB(0,1*m)
 The Front Shape: Flat Round Honeycomb
 The Crust Material: Stainless steel
 IP Degree: IP50, IK04

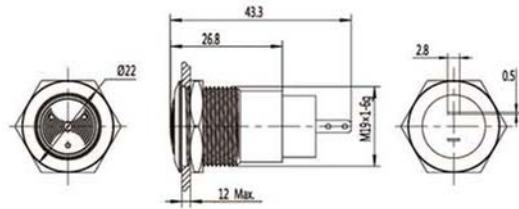

I-TOP-22F-J



Diameter: Ø 22mm
Switch Rating: 5A/250VAC
Contact Configuration: 1NO
Operation Type: Momentary
The Front Shape: Flat
The Crust Material:

- Stainless steel

 IP Degree: IP67, IK10

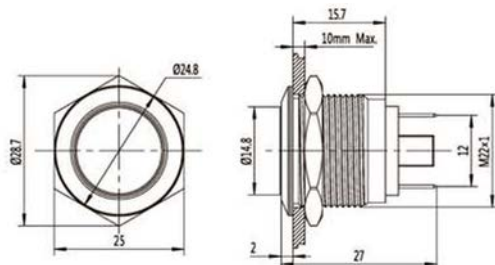

CONNECTOR MANUFACTURERS

TOPTEK®
HARDWARE ELECTRONIC MANUFACTURER

www.toptek-co.com

Ø 22 mm

I-TOP-22B-J



Diameter: Ø 22mm
Switch Rating: 5A/250VAC
Contact Configuration: 1NO
Operation Type: Momentary
The Front Shape: Ball
The Crust Material: Stainless steel
IP Degree: IP67, IK10

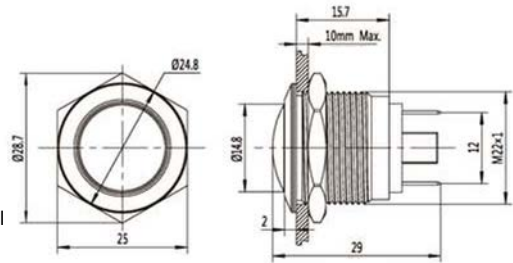

I-TOP-22H-J



Diameter: Ø 22mm
Switch Rating: 5A/250VAC
Contact Configuration: 1NO
Operation Type: Momentary
The Front Shape: High
The Crust Material: Stainless steel
IP Degree: IP67, IK10

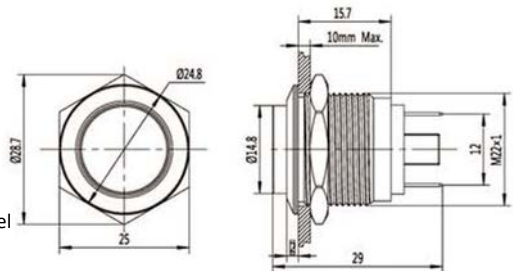

I-TOP-22F



Diameter: Ø 22mm
Switch Rating: 5A/250VAC
Contact Configuration: 1NO
Operation Type: Momentary
The Front Shape: Flat
The Crust Material: Stainless steel
IP Degree: IP67, IK10

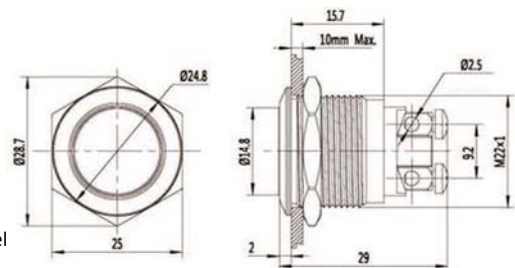

I-TOP-22B



Diameter: Ø 22mm
Switch Rating: 5A/250VAC
Contact Configuration: 1NO
Operation Type: Momentary
The Front Shape: High
The Crust Material: Stainless steel
IP Degree: IP67, IK10

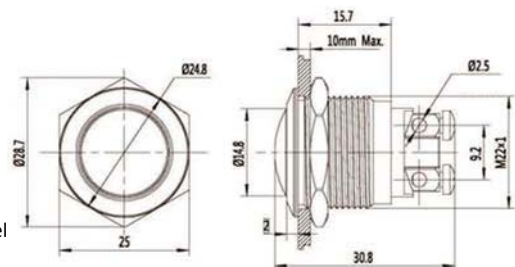

Ø 22 mm

TOPTTEK®
HARDWARE ELECTRONIC MANUFACTURER



I-TOP-22H



Diameter: Ø 22mm
 Switch Rating: 5A/250VAC
 Contact Configuration: 1NO
 Operation Type: Momentary
 The Front Shape: High
 The Crust Material: Stainless steel
 IP Degree: IP67, IK10

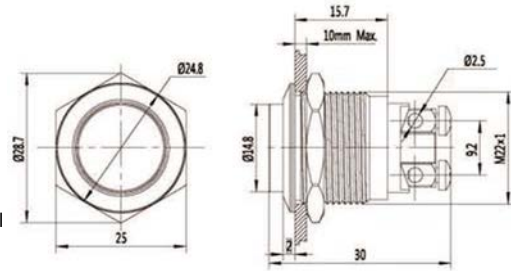

14
*
55

I-TOP-22F-11



Diameter: Ø 22mm
 Switch Rating: 5A/250VAC
 Contact Configuration: 1NO 1NC
 Operation Type:
 • Momentary
 • Maintained(Z)
 The Front Shape: Flat
 The Crust Material:
 • Stainless steel
 IP Degree: IP67, IK10

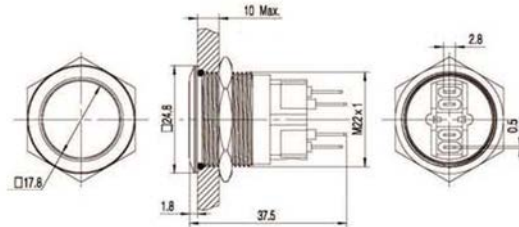

I-TOP-22B-11



Diameter: Ø 22mm
 Switch Rating: 5A/250VAC
 Contact Configuration: 1NO 1NC
 Operation Type:
 • Momentary
 • Maintained(Z)
 The Front Shape: Ball
 The Crust Material:
 • Stainless steel
 IP Degree: IP67, IK10

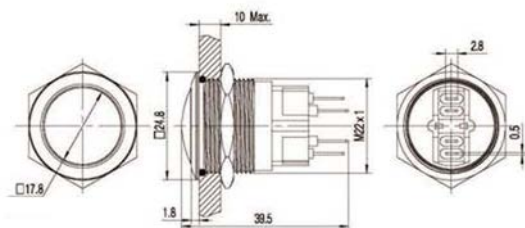

I-TOP-22H-11



Diameter: Ø 22mm
 Switch Rating: 5A/250VAC
 Contact Configuration: 1NO 1NC
 Operation Type:
 • Momentary
 • Maintained(Z)
 The Front Shape: High
 The Crust Material:
 • Stainless steel
 IP Degree: IP67, IK10

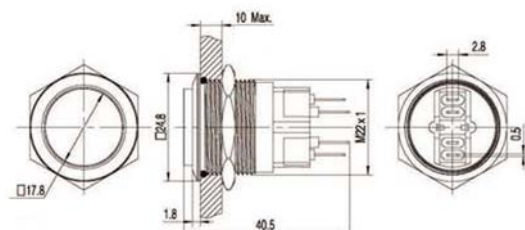

CONNECTOR MANUFACTURERS

TOPTEK®
HARDWARE ELECTRONIC MANUFACTURER

www.toptek-co.com

Ø 22 mm

I-TOP-22-11E



Diameter: Ø 22mm
Color: R, G, Y, O, B, W
Switch Rating: 5A/250VAC
Contact Configuration: 1NO 1NC
Operation Type:

- Momentary
- Maintained(Z)

The Front Shape: Flat
Lamp type: Ring illuminated (LED)
The Crust Material: Stainless steel
IP Degree: IP67, IK10

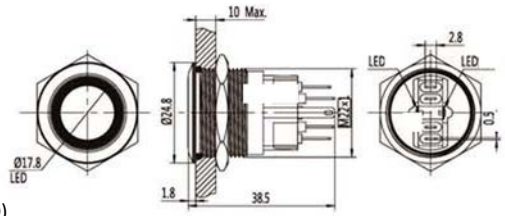

I-TOP-22-11D



Diameter: Ø 22mm
Color: R, G, Y, O, B, W
Switch Rating: 5A/250VAC
Contact Configuration: 1NO 1NC
Operation Type:

- Momentary
- Maintained(Z)

The Front Shape: Flat
Lamp type: Dot illuminated (LED)
The Crust Material: Stainless steel
IP Degree: IP67, IK10

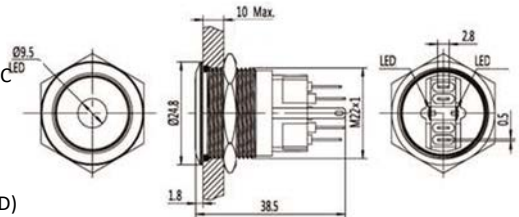

I-TOP-22-11EP



Diameter: Ø 22mm
Color: R, G, Y, O, B, W
Switch Rating: 5A/250VAC
Contact Configuration: 1NO 1NC
Operation Type:

- Momentary
- Maintained(Z)

The Front Shape: Flat
Lamp type: Power symbol illuminated (LED)
The Crust Material: Stainless steel
IP Degree: IP67, IK10

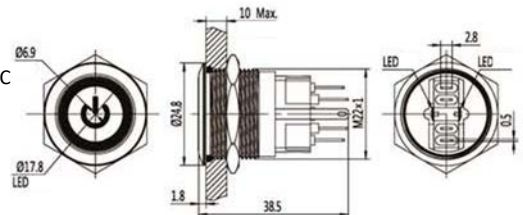

I-TOP-S1-22F



Diameter: Ø 22mm
Switch Rating: 5A/250VAC
Contact Configuration: 1NO 1NC / 2NO 2NC
Operation Type:

- Momentary
- Maintained(Z)

The Front Shape: Flat
The Crust Material: Stainless steel
IP Degree: IP67, IK10

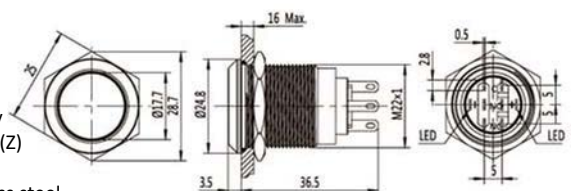

14
*
56

Anti-vandal Switch

Pb

ROHS

Ø 22 mm

TOPTEK®
HARDWARE ELECTRONIC MANUFACTURER



I-TOP-S1-22B



Diameter: Ø 22mm
 Switch Rating: 5A/250VAC
 Contact Configuration:
 1NO 1NC /2NO 2NC
 Operation Type:
 • Momentary
 • Maintained(Z)
 The Front Shape: Ball
 The Crust Material: Stainless steel
 IP Degree: IP67, IK10

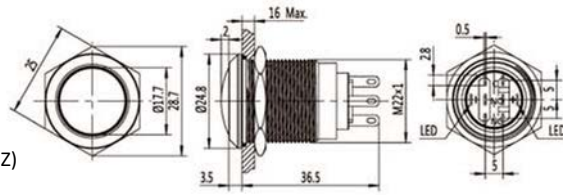

14
*
57

I-TOP-S1-22H



Diameter: Ø 22mm
 Switch Rating: 5A/250VAC
 Contact Configuration:
 1NO 1NC /2NO 2NC
 Operation Type:
 • Momentary
 • Maintained(Z)
 The Front Shape: High
 The Crust Material: Stainless steel
 IP Degree: IP67, IK10

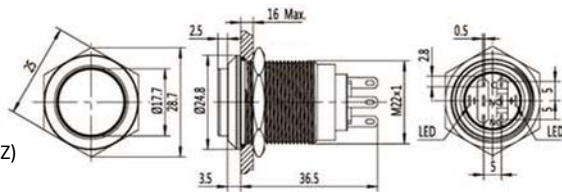

I-TOP-S1-22F-L



Diameter: Ø 22mm
 Color: R, G, Y, O, B, W
 Switch Rating: 5A/250VAC
 Contact Configuration:
 1NO 1NC /2NO 2NC
 Operation Type:
 • Momentary
 • Maintained(Z)
 The Front Shape: Flat
 Lamp type: Dot illuminated (LED)
 The Crust Material: Stainless steel
 IP Degree: IP67, IK10

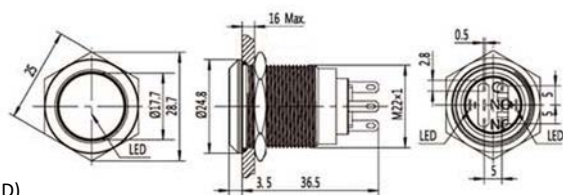

I-TOP-S1-22F-D



Diameter: Ø 22mm
 Switch Rating: 5A/250VAC
 Contact Configuration:
 1NO 1NC /2NO 2NC
 Operation Type:
 • Momentary
 • Maintained(Z)
 The Front Shape: Flat
 Lamp type: Dot illuminated (LED)
 The Crust Material: Stainless steel
 IP Degree: IP67, IK10

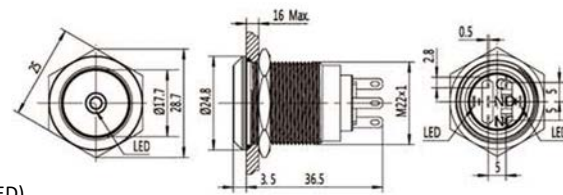

CONNECTOR MANUFACTURERS

TOPTek®
HARDWARE ELECTRONIC MANUFACTURER

www.toptek-co.com

Ø 22 mm

I-TOP-S1-22F-E



Diameter: Ø 22mm
Color: R, G, Y, O, B, W
Switch Rating: 5A/250VAC
Contact Configuration:
1NO 1NC/2NO 2NC
Operation Type:

- Momentary
- Maintained(Z)

The Front Shape: Flat
Lamp type: Ring illuminated (LED)
The Crust Material: Stainless steel
IP Degree: IP67, IK10

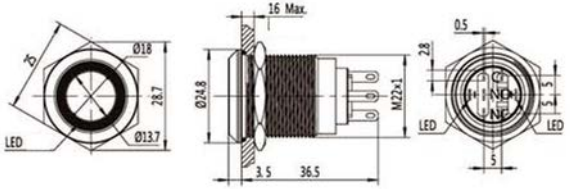

I-TOP-S1-22B-SR



Diameter: Ø 22mm
Color: R, G, Y, O, B, W
Switch Rating: 5A/250VAC
Contact Configuration: 1NO 1NC
Operation Type: Push-Lock Turn-reset
The Front Shape: Ball
Light way: Arrow
The Crust Material: Stainless steel
IP Degree: IP65, IK10

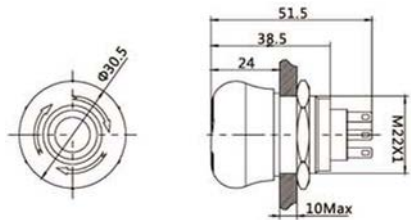

I-TOP-S1-AWY



Diameter: Ø 22mm
Switch Rating: 5A/250VAC
Contact Configuration:
1NO 1NC /2NO 2NC
Operation Type:

- Momentary
- Maintained(Z)

The Front Shape: Flat
The Crust Material: Stainless steel
IP Degree: IP67, IK10

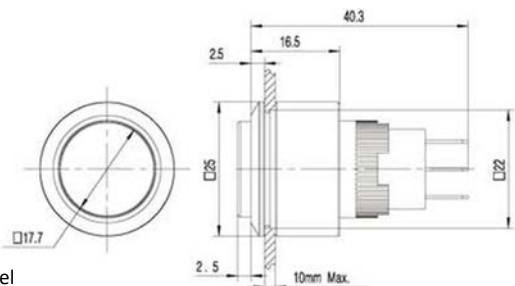

I-TOP-S1-AWX



Diameter: Ø 22mm
Color: R, G, Y, O, B, W
Switch Rating: 5A/250VAC
Contact Configuration:
1NO 1NC /2NO 2NC
Operation Type:

- Momentary
- Maintained(Z)

Lamp type: Flat illuminated (LED)
The Front Shape: Flat
The Crust Material: Stainless steel
IP Degree: IP67, IK10

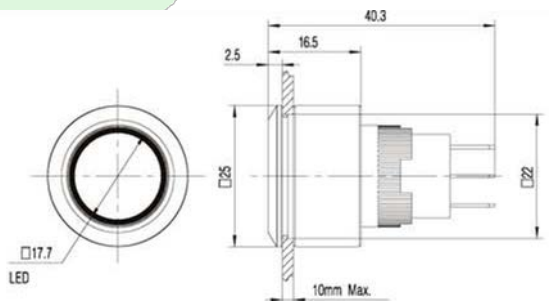

14
*
58

Anti-vandal Switch

Pb

ROHS

Ø 22 -25 mm

TOPTEK®
HARDWARE ELECTRONIC MANUFACTURER



I-TOP-S1-AWP



Diameter: Ø 22mm
 Color: R, G, Y, O, B, W
 Switch Rating: 5A/250VAC
 Contact Configuration:
 1NO 1NC /2NO 2NC
 Operation Type:
 • Momentary
 • Maintained(Z)
 Lamp type:
 Power symbol illuminated (LED)
 The Front Shape: Flat
 The Crust Material: Stainless steel
 IP Degree: IP67, IK10

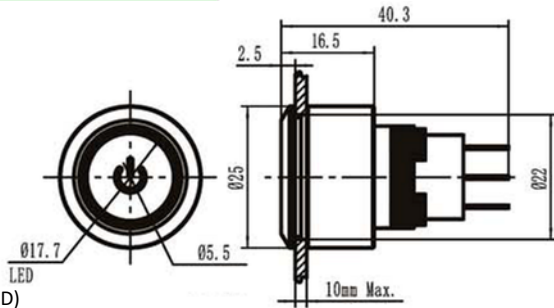

14
*
59

S-TOP-25F



Diameter: Ø 25mm
 Switch Rating: 5A/250VAC
 Contact Configuration:
 1NO 1NC /2NO 2NC
 Operation Type:
 • Momentary
 • Maintained(Z)
 The Front Shape: Flat
 The Crust Material: Stainless steel
 IP Degree: IP67, IK10

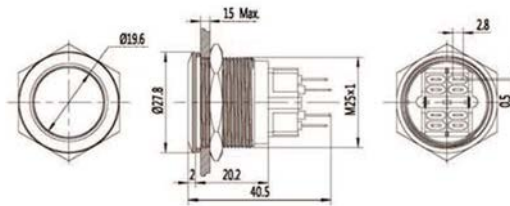

S-TOP-25B



Diameter: Ø 25mm
 Switch Rating: 5A/250VAC
 Contact Configuration:
 1NO 1NC /2NO 2NC
 Operation Type:
 • Momentary
 • Maintained(Z)
 The Front Shape: Ball
 The Crust Material: Stainless steel
 IP Degree: IP67, IK10

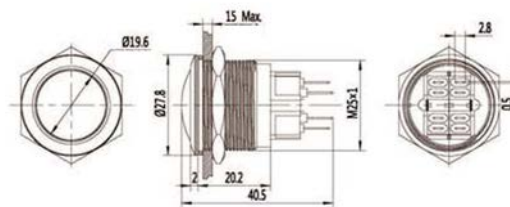

S-TOP-25H



Diameter: Ø 25mm
 Switch Rating: 5A/250VAC
 Contact Configuration:
 1NO 1NC /2NO 2NC
 Operation Type:
 • Momentary
 • Maintained(Z)
 The Front Shape: High
 The Crust Material: Stainless steel
 IP Degree: IP67, IK10

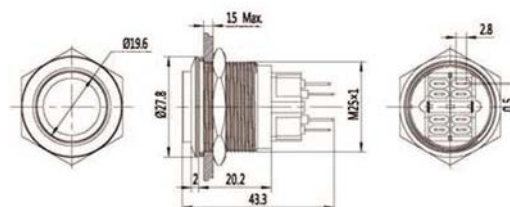

CONNECTOR MANUFACTURERS

TOPTek[®]
HARDWARE ELECTRONIC MANUFACTURER

www.toptek-co.com

Ø 25 - 28 mm

S-TOP-25F-E



Diameter: Ø 25mm
Color: R, G, Y, O, B, W
Switch Rating: 5A/250VAC
Contact Configuration:
1NO 1NC/2NO 2NC
Operation Type:

- Momentary
- Maintained(Z)

The Front Shape: Flat
Lamp type: Ring illuminated (LED)
The Crust Material: Stainless steel
IP Degree: IP67, IK10

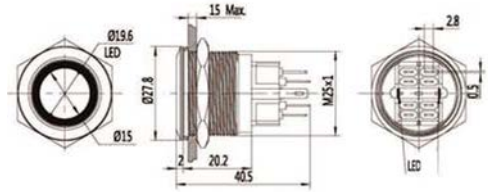

S-TOP-25F-D



Diameter: Ø 25mm
Color: R, G, Y, O, B, W
Switch Rating: 5A/250VAC
Contact Configuration:
1NO 1NC/2NO 2NC
Operation Type:

- Momentary
- Maintained(Z)

The Front Shape: Flat
Lamp type: Dot illuminated (LED)
The Crust Material: Stainless steel
IP Degree: IP67, IK10

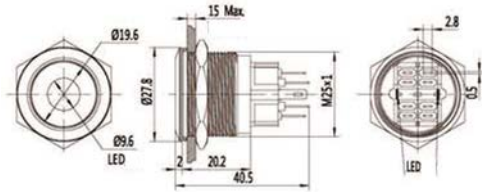

S-TOP-25F-EP



Diameter: Ø 25mm
Color: R, G, Y, O, B, W
Switch Rating: 5A/250VAC
Contact Configuration:
1NO 1NC/2NO 2NC
Operation Type:

- Momentary
- Maintained(Z)

The Front Shape: Flat
Lamp type: Power symbol illuminated (LED)
The Crust Material: Stainless steel
IP Degree: IP67, IK10

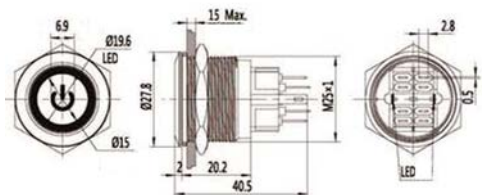

S-TOP-28F



Diameter: Ø 28mm
Switch Rating: 5A/250VAC
Contact Configuration:
1NO 1NC /2NO 2NC
Operation Type:

- Momentary
- Maintained(Z)

The Front Shape: Flat
The Crust Material: Stainless steel
IP Degree: IP67, IK10

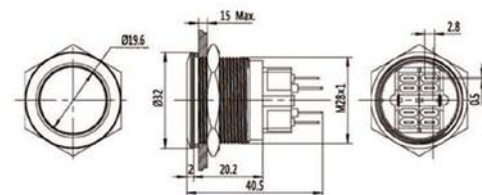

14
*
60

Anti-vandal Switch

Pb

ROHS

Ø 28 mm

TOPTEK®
HARDWARE ELECTRONIC MANUFACTURER



S-TOP-28B



Diameter: Ø 28mm
 Switch Rating: 5A/250VAC
 Contact Configuration:
 1NO 1NC /2NO 2NC
 Operation Type:
 • Momentary
 • Maintained(Z)
 The Front Shape: Ball
 The Crust Material: Stainless st
 IP Degree: IP67, IK10

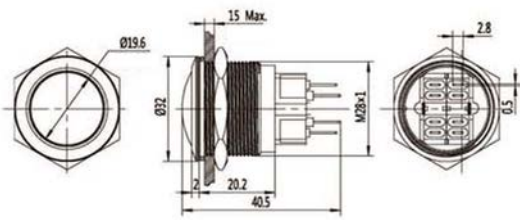

14
*
61

S-TOP-28H



Diameter: Ø 28mm
 Switch Rating: 5A/250VAC
 Contact Configuration:
 1NO 1NC /2NO 2NC
 Operation Type:
 • Momentary
 • Maintained(Z)
 The Front Shape: Flat
 The Crust Material: Stainless steel
 IP Degree: IP67, IK10

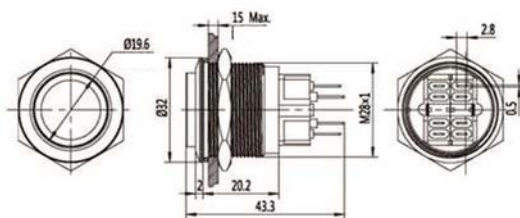

S-TOP-28F-E



Diameter: Ø 28mm
 Color: R, G, Y, O, B, W
 Switch Rating: 5A/250VAC
 Contact Configuration:
 1NO 1NC /2NO 2NC
 Operation Type:
 • Momentary
 • Maintained(Z)
 Lamp type: Ring illuminated (LED)
 The Front Shape: Flat
 The Crust Material: Stainless steel
 IP Degree: IP67, IK10

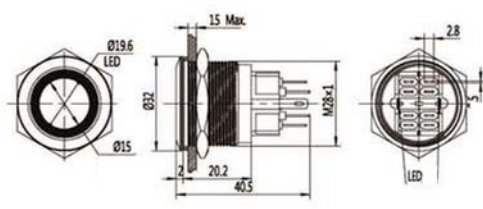

S-TOP-28F-D



Diameter: Ø 28mm
 Switch Rating: 5A/250VAC
 Contact Configuration:
 1NO 1NC /2NO 2NC
 Operation Type:
 • Momentary
 • Maintained(Z)
 Lamp type: Dot illuminated (LED)
 The Front Shape: Flat
 The Crust Material: Stainless steel
 IP Degree: IP67, IK10

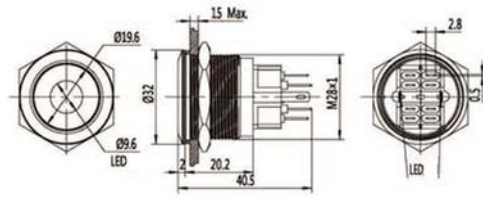

CONNECTOR MANUFACTURERS

TOPTEK®
HARDWARE ELECTRONIC MANUFACTURER

www.toptek-co.com

Ø 28 - 30 mm

S-TOP-28F-EP



Diameter: Ø 28mm
Color: R, G, Y, O, B, W
Switch Rating: 5A/250VAC
Contact Configuration:
1NO 1NC/2NO 2NC
Operation Type:

- Momentary
- Maintained(Z)

The Front Shape: Flat
Lamp type: Power symbol illuminated (LED)
The Crust Material: Stainless steel
IP Degree: IP67, IK10

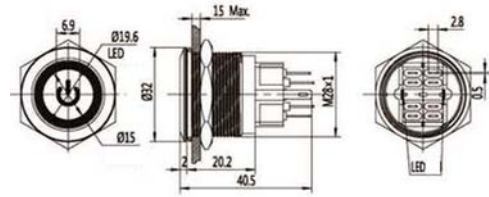

S-TOP-30F



Diameter: Ø 30mm
Switch Rating: 5A/250VAC
Contact Configuration:
1NO 1NC/2NO 2NC
Operation Type:

- Momentary
- Maintained(Z)

The Front Shape: Flat
The Crust Material: Stainless steel
IP Degree: IP67, IK10

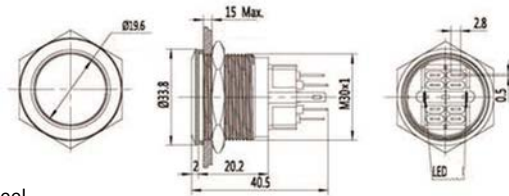

S-TOP-30F-D



Diameter: Ø 30mm
Color: R, G, Y, O, B, W
Switch Rating: 5A/250VAC
Contact Configuration:
1NO 1NC/2NO 2NC
Operation Type:

- Momentary
- Maintained(Z)

The Front Shape: Flat
Lamp type: Dot illuminated (LED)
The Crust Material: Stainless steel
IP Degree: IP67, IK10

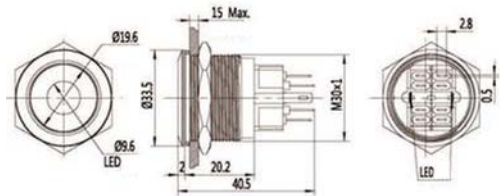

S-TOP-30F-E

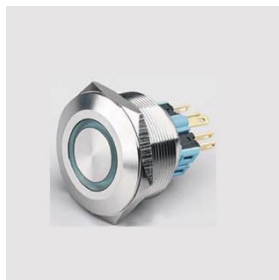

Diameter: Ø 30mm
Switch Rating: 5A/250VAC
Contact Configuration:
1NO 1NC /2NO 2NC
Operation Type:

- Momentary
- Maintained(Z)

The Front Shape: Flat
Lamp type: Ring illuminated (LED)
The Crust Material: Stainless steel
IP Degree: IP67, IK10

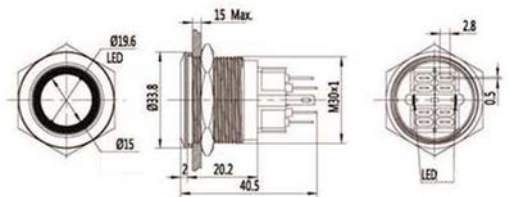

Ø 40 mm

TOPTTEK®
HARDWARE ELECTRONIC MANUFACTURER



www.toptek-co.com

S-TOP-40F



Diameter: Ø 40mm
Switch Rating: 5A/250VAC
Contact Configuration:
1NO 1NC /2NO 2NC
Operation Type:

- Momentary
- Maintained(Z)

The Front Shape: Flat
The Crust Material: Stainless steel
IP Degree: IP67, IK10

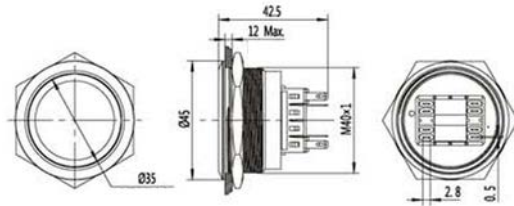

S-TOP-40B



Diameter: Ø 40mm
Switch Rating: 5A/250VAC
Contact Configuration:
1NO 1NC /2NO 2NC
Operation Type:

- Momentary
- Maintained(Z)

The Front Shape: Ball
The Crust Material: Stainless steel
IP Degree: IP67, IK10

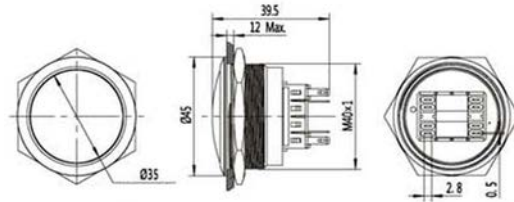

S-TOP-40H



Diameter: Ø 40mm
Switch Rating: 5A/250VAC
Contact Configuration:
1NO 1NC /2NO 2NC
Operation Type:

- Momentary
- Maintained(Z)

The Front Shape: High
The Crust Material: Stainless steel
IP Degree: IP67, IK10

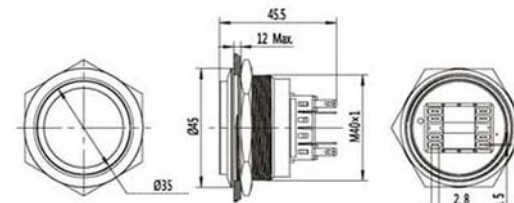

S-TOP-40F-E



Diameter: Ø 40mm
Color: R, G, Y, O, B, W
Switch Rating: 5A/250VAC
Contact Configuration:
1NO 1NC /2NO 2NC
Operation Type:

- Momentary
- Maintained(Z)

Lamp type: Ring illuminated (LED)
The Front Shape: Flat
The Crust Material: Stainless steel
IP Degree: IP67, IK10

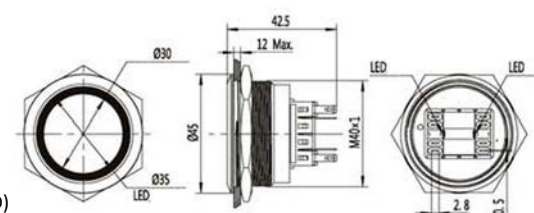

14
*
63



CONNECTOR MANUFACTURERS

TOPTek[®]
HARDWARE ELECTRONIC MANUFACTURER

 www.toptek-co.com

Accessories & Custom Parts

TOP-DC16

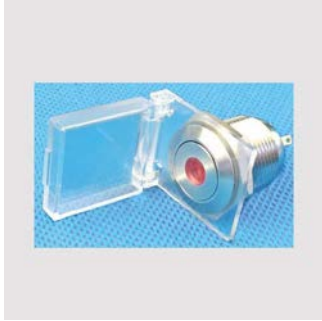

Dustproof Cover for 16mm Switch

TOP-DC19

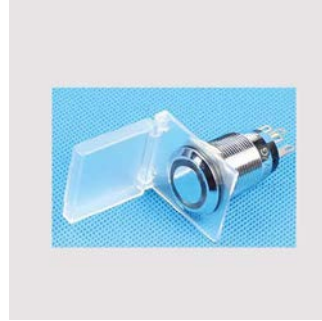

Dustproof Cover for 19mm Switch

TOP-DC22



Dustproof Cover for 22mm Switch

TOP-HS-1-2-3

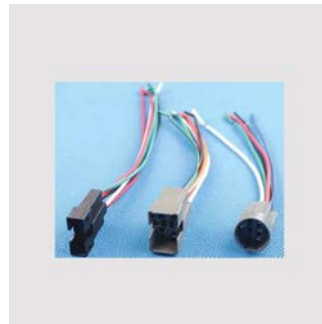

Harness for Switches

Parts of the Custom Product Display



14
*
64

Anti-vandal Switch



ROHS