

▶ TOGGLE SWITCH

Toggle Switch

TOPTTEK®

HARDWARE ELECTRONIC COMPONENTS



Specifications

Rating: 10A 125V AC; 6A 250V AC / 15A 125V AC ; 10A 250V AC / 20A 125V AC; 15A 250V AC | Contact Resistance: 50mΩ Max |
 Insulation Resistance: 500VDC 1000MΩ min | Dielectric Strength: 1500V AC for one minute | Operation Temperature: -25°C to +85°C
 | Electrical Life: ≥ 10,000 Cycles

www.toptek-co.com

T3-3A

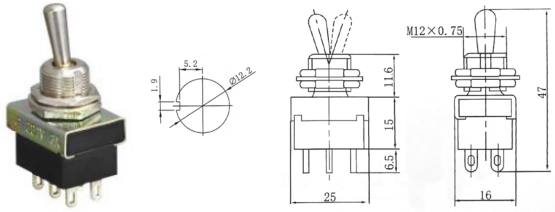

**T3-3A ON-ON
 DPDT 6P
 6A 125VAC; 3A 250VAC**

T3-1

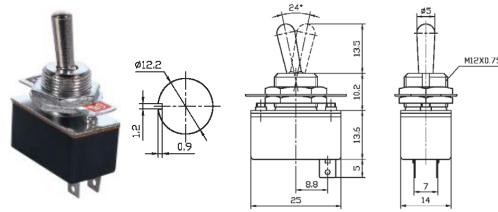

**T3-1 ON-OFF
 SPST 2P
 4A 125VAC; 2A 250VAC**

T3-2

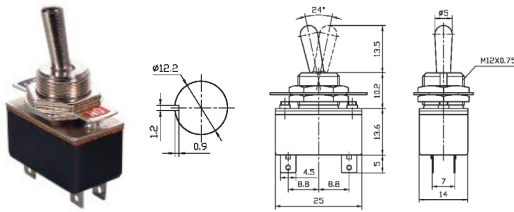

**T3-2 ON-ON
 SPDT 4P
 4A 125VAC; 2A 250VAC**

T3-3

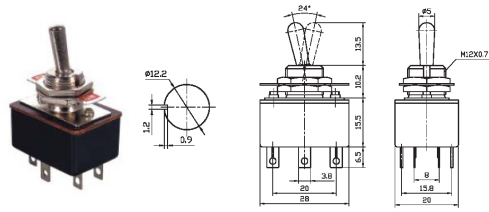

**T3-3 ON-ON
 DPDT 6P
 5A 125VAC; 3A 250VAC**

TS-1

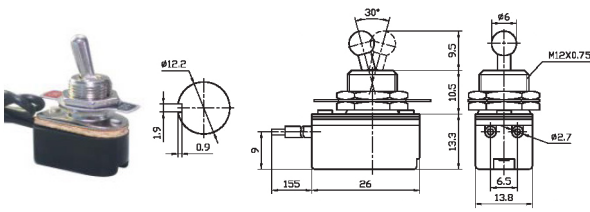

**TS1 ON-OFF
 SPST 2P
 6A 125VAC; 3A 250VAC; 10 12VAC**

TS-2

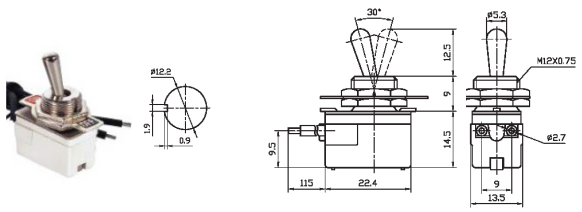

**TS-2 ON-OFF
 SPST 2P
 6A 125VAC; 3A 250VAC; 10A 12VDC**

TH-1

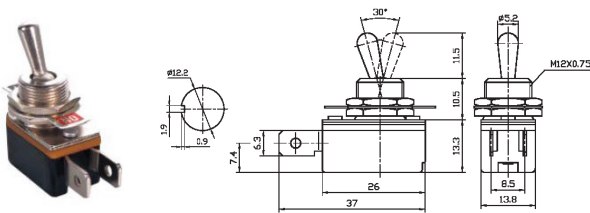

**TH-1 ON-OFF
 SPST 2P
 6A 125VAC; 3A 250VAC; 10A 12VDC**

TH-1S

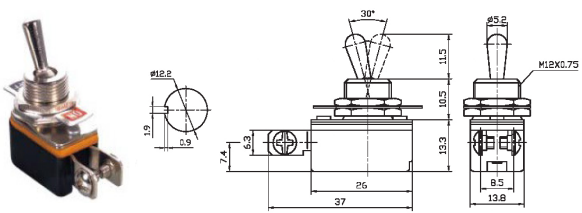

**TH-1S ON-OFF
 SPST 2P (Screw Terminals)
 6A 125VAC; 3A 250VAC; 10A 12VDC**