

MACHINE PIN HEADER

Machine Pin Header IC Type 1.778mm

TOPTTEK[®]
HARDWARE ELECTRONIC COMPONENTS



RoHS 2002/95/EC

Specifications

Current Rate: 3 AMP | Insulation Resistance: $\geq 1000\text{M}\Omega$ at V=100V | Contact Resistance: $\leq 4\text{m}\Omega$ /Contact | Dielectric Voltage: 60V AC for one minute | Operation Temperature: -40°C to $+105^\circ\text{C}$

Material

Insulator: Polyester, UL 94V-0 | © Standard: PPS | Terminal: Copper Alloy | Plated: Selective Gold



www.toptek-co.com

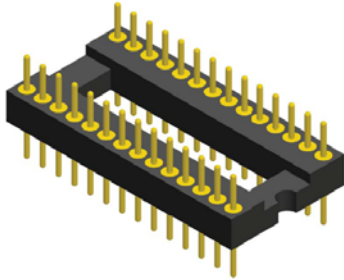

ORDER INFORMATION

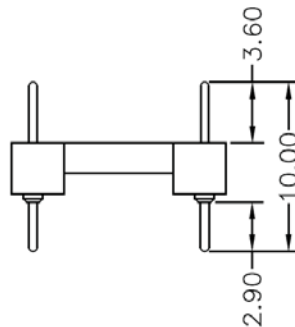
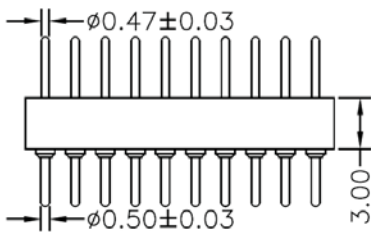
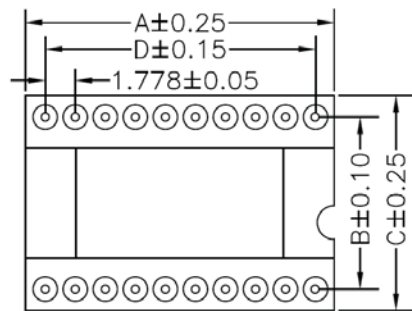
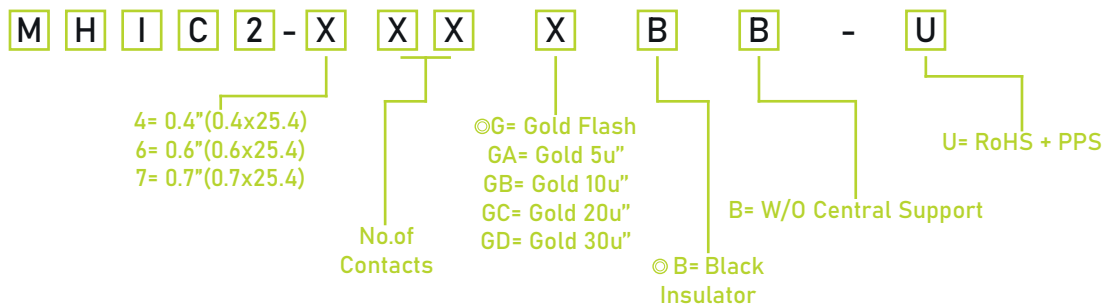

No. of Contacts	Dim. A	Dim. B	Dim. C	Dim. D	
24	21.80	10.16	12.70	19.558	0.4"
28	25.20	10.16	12.70	23.114	
30	27.17	10.16	12.70	24.892	
32	28.948	10.16	12.70	26.670	
48	43.172	10.16	12.70	40.894	
No. of Contacts	Dim. A	Dim. B	Dim. C	Dim. D	
20	18.28	15.24	17.64	16.002	0.6"
24	21.836	15.24	17.64	19.558	
28	25.392	15.24	17.64	23.114	
40	35.80	15.24	17.64	33.782	
42	37.70	15.24	17.64	35.580	
48	43.10	15.24	17.64	40.894	
52	46.70	15.24	17.64	44.450	
56	50.20	15.24	17.64	48.006	
64	57.30	15.24	17.64	55.118	0.7"
68	60.90	15.24	17.64	58.674	
No. of Contacts	Dim. A	Dim. B	Dim. C	Dim. D	
64	57.30	19.05	21.45	55.118	