

TACT SWITCH

6X6 tact switch

TOPTTEK[®]

HARDWARE ELECTRONIC COMPONENTS



SPECIFICATION MODEL: SWTA6601-B-X-XXX-X

1	Operating Temperature	-30°C to +85°C
2	Rating	50mA, 12V DC
3	Insulation Resistance	100MΩ min. 100V DC
4	Dielectric Strength	250V AC for 1 min.
5	Contact Resistance	100mΩ max.
6	Life	50,000, 100,000 or 300,000 Cycles
7	Travel	0.25 ± 0.1mm
8	Operating Force	D:70 A:90 E:130 J:160 F: 210 C:250 G:320 H:400

www.toptek-co.com

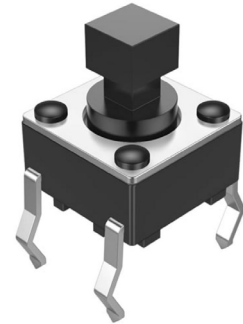

ORDER INFORMATION

S W T A 6 6 0 1 - B - X - X

Stem Color

B= Black
W= White
R= Red
S= Salmon
N= Brown

Operating Force

D= 70gf
A= 90gf
E= 130gf
J= 160gf
F= 210gf
C= 250gf
G= 320gf
H= 400gf

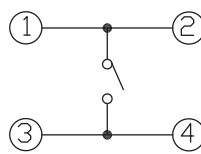
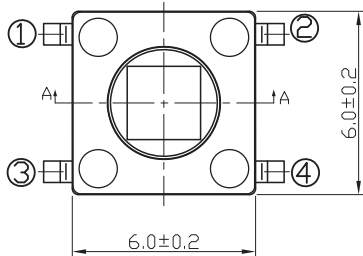

CIRCUIT DIAGRAM

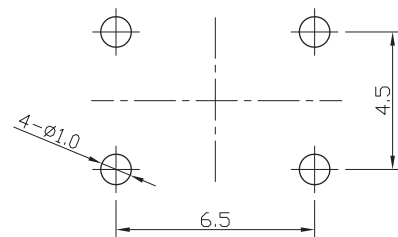

P.C.B LAND DIMENSION

