

PLASTIC PARTS for PCB

CONNECTOR / TERMINAL BLOCK / WIRE CLAMP

TEST PIN / FUSE HOLDER / P.C.B TERMINAL

GROUND TERMINAL / CLAMP / PLASTIC GEAR

TOPTTEK®
HARDWARE ELECTRONIC MANUFACTURER

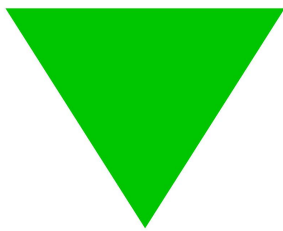

www.toptek-co.com

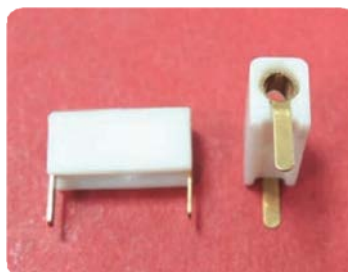
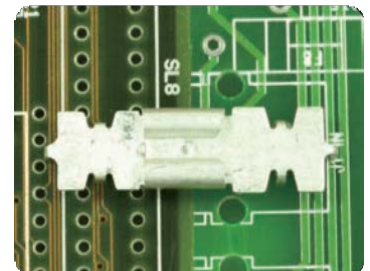

PUSH-IN WIRE CONNECTOR

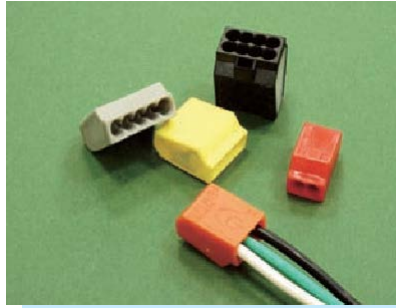

- ◆ MATERIAL:PA 66 (UL) 94V-2
- ◆ UNIT:mm

NOTE:

(Current):24A(VDE)
 (Voltage):600V
 (Working temp): 110C°
 (Wire Range): #12-22 AWG Solid conductor (Stripping Length): 11mm(0.43inch)
 (Color):(UL), (VDE), (Finko), (CE)

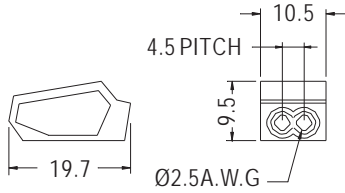

PC252

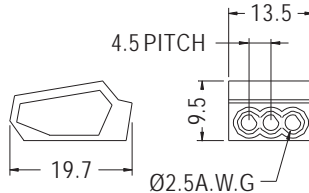

PC253

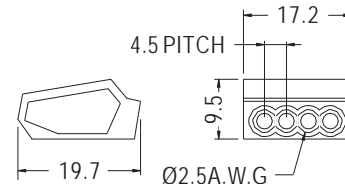

PC254

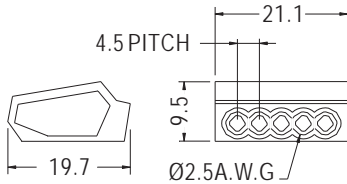

PC255

PART NO	COLOR	POLES	PACKAGE
PC252	RED	2	500
PC253	ORANGE	3	
PC254	YELLOW	4	
PC255	GRAY	5	

CABLE CONNECTOR

- ◆ MATERIAL:NYLON 66
- ◆ COLOR:GRAY
- ◆ UNIT:mm

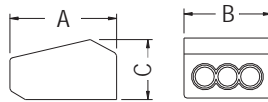
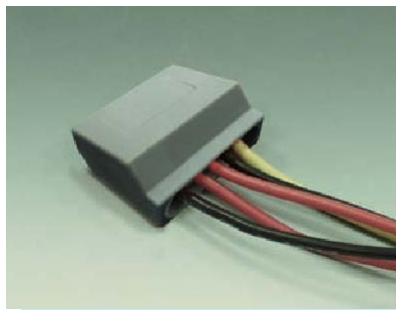

UC-3

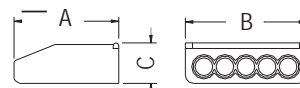

UC-5

PARTNO	A	B	C	SUITABLE ELECTRIC WIRE	THE HIGHEST VOLTAGE,CURRENT	LENGTH STRIPPED WIRE	PACKAGE
UC-3	19.6	13.8	9.7	3X1.2~2mm(d)	380V,27A	10.0~13.0mm	100
UC-5	19.3	21.9	10.1	5X1.2~2mm(d)			



QUICK SPLICE

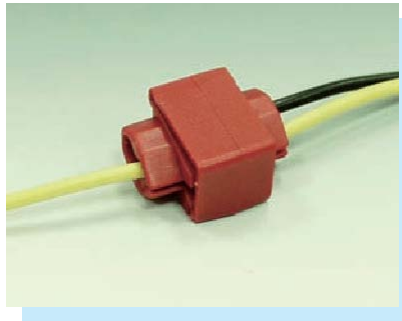

- ◆ HOUSING MATERIAL:PP
- ◆ METAL MATERIAL:COPPER
- ◆ FINISH:TIN PLATED
- ◆ UNIT:mm

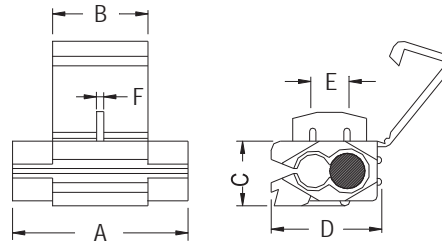

PART NO	WIRE RANGE		A	B	C	D	E	F	COLOR	PACKAGE
	AWG	mm ²								
3MR	22~18	1.25	19.5	10.6	8.2	13.5	3.9	0.8	RED	500
3MB	16~14	2.0							BLUE	
3MY	12~10	5.5	20.0	20.0	11.1	15.0	4.8	0.9	YELLOW	200

QUICK SPLICE



- ◆ HOUSING MATERIAL:NYLON 66 UL94V-2
- ◆ POLE:1-12 POLES
- ◆ WORKING TEMPERATURE:105°C
- ◆ PA7DS,PA9DS:WITH WIRE PROTECTOR
- ◆ APPROVED:UL、CSA、VDE、F、D、N、S...
- ◆ COLOR:NATURAL

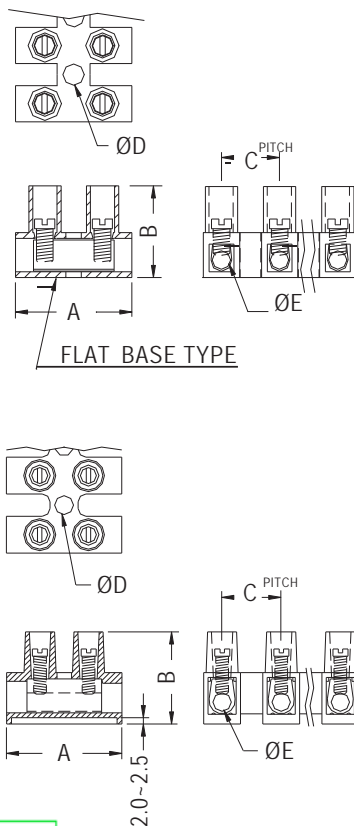
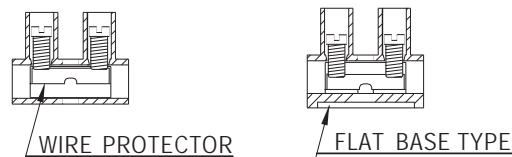

PART NO	mm ²	Amp	Volt	Screw	A	B	C	D	E	POLES
PA7-H	1.5	17.5	450V	M2.6X5P	17.0	14.5	8.2	2.9	2.8	1-12
PA7-DSH						13.5				
PA7F-H					20.2	16.7	10.0	3.6	3.2	
PA7F-DSH										
PA9-H	2.5	24.0	500V	M3.0X6P	20.2	16.7	10.0	3.6	3.2	
PA9-DSH										
PA9F-H					23.8	19.0	12.0	3.9	4.2	
PA12H-H	6.0	41.0	500V	M3.5X7P	23.8	19.0	12.0	3.9	4.2	
PA12H-DS										
PA14-H	10.0	57.0	500V	M4.0X9P	25.6	25.0	13.5	4.4	5.0	
PA14H-DS				M4.0X7P						

PART NO	mm ²	Amp	Volt	Screw	A	B	C	D	E	POLES
PA16-H	16.0	76.0	500 V	M4.0X9P	28.1	23.0	14.5	4.2	6.0	1-12



TERMINAL BLOCK



- ◆ HOUSING MATERIAL: NYLON 66 (UL) 94V-2
- ◆ WORKING TEMPERATURE: 105 °C
- ◆ COLOR: NATURAL
- ◆ UNIT: mm

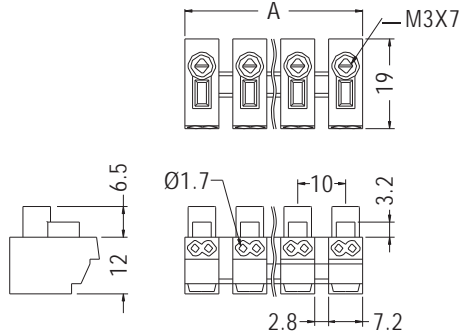

PART NO	
PA11-2P	17.3
PA11-3P	27.5

TERMINAL BLOCK

- ◆ MATERIAL: PC (UL)
- ◆ FLAME CLASS: 94V-2/94V-0
- ◆ COLOR: NATURAL
- ◆ UNIT: mm

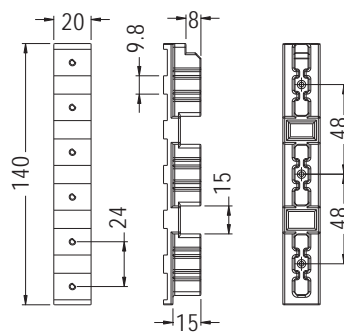
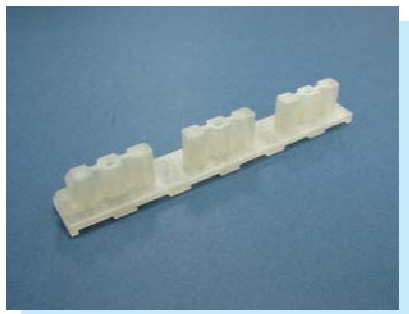

PART NO	PACKAGE
TERBL-6	50

TERMINAL BLOCK

- ◆ MATERIAL: PBT (UL)
- ◆ FLAME CLASS: 94V-0
- ◆ COLOR: BLACK
- ◆ UNIT: mm

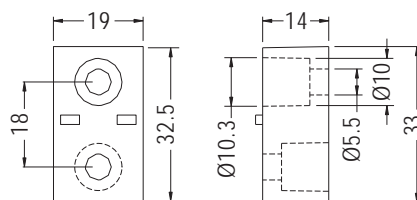
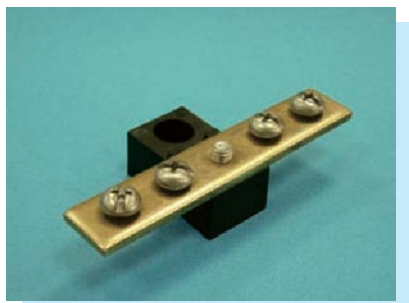

PART NO	PACKAGE
TERBL-33	200



SCREW-ON CONNECTOR

- ◆ MATERIAL:PP
- ◆ COLOR:ORANGE
- ◆ UNIT:mm
- ◆ WITE SPRINGINSRET

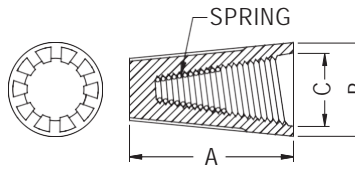
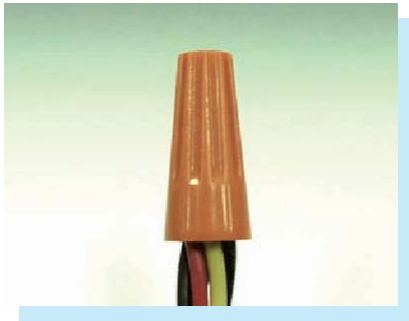

PART NO	WIRE SIZE RANGE		A	B	C	PACKAGE
	MAX.	MIN.				
P1	#18X2	#24X2	15.2	8.6	6.5	1000
P2	#16X3	#20X3	17.7	9.9	7.1	
P3	#14X3	#18X3	22.0	12.4	9.8	500
P4		#16X3	24.6	14.0	11.0	

- ◆ MATERIAL:PBT(UL) 94V-0
- ◆ COLOR:BLACK
- ◆ UNIT:mm
- ◆ WITE SPRINGINSRET

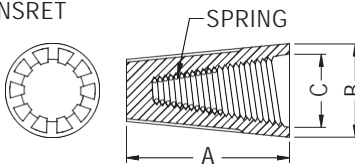

PART NO	A	B	C	SUITABLE WIRES A.W.G	PACKAGE
P1B	15.2	8.6	6.5	22-18	1000
P3B	21.8	12.7	9.6	22-14	500

CLOSE END CONNECTOR

- ◆ HOUSING MAT'L:NYLON 66 (UL) 94V-2
- ◆ METAL MAT'L:TIN PLATEDALUMINUM/
TIN PLATED COPPER
- ◆ COLOR:NATURAL
- ◆ UNIT:mm

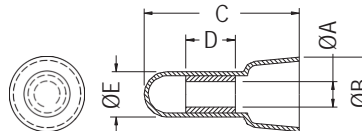

PARTNO	WIRE RANGE	A	B	C	D	E	PACKAGE
CE1	#22-18 1.25 mm²	2.6	7.8	18.0	7.0	5.0	1000
CE2	#22-14 2 mm²	3.1	9.5	20.0		5.7	
CE5	#22-10 5.5 mm²	4.4	12.5	25.5	8.4	7.6	
CE8	#8 8 mm²	5.2	14.2	27.7	8.5	9.5	500

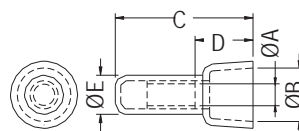

PARTNO	WIRE RANGE	A	B	C	D	E	PACKAGE
C3	#22-16 1.25 mm²	2.5	7.9	19.2	7.2	5.1	1000
C4	#16-14 2 mm²	3.2	8.2	20.7	8.5	5.7	
C5	#12-10 5.5 mm²	4.2	10.6	24.8	10.7	7.3	
C8	#8 8 mm²	5.0	12.2	27.1	12.5	9.2	500



WIRE CLAMP

- ◆ METAL MAT'L: STEEL
- ◆ PLASTIC MAT'L: PVC TUBE (UL)
- ◆ COLOR: BLACK
- ◆ UNIT: mm

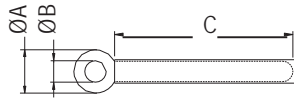

PART NO	A	B	C	PACKAGE
WL3-32T	7.5	3.3	32.0	1000
WL3-52T	7.5	3.3	52.0	
WL3-60T	8.0	3.6	62.0	
WL4-35T	8.5	4.2	35.0	
WL4-50T	8.0	4.1	52.0	
WL4-70T	7.5	4.2	74.5	
WL4-78T	8.0	4.1	78.5	500
WL5-70T	8.4	5.1	60.0	
WL6-78T	10.0	6.0	78.0	

- ◆ METAL MAT'L: STEEL
- ◆ PLASTIC MAT'L: POLYOLEFIN (UL)

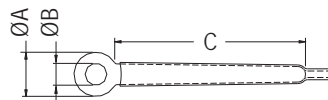

PART NO	A	B	C	PACKAGE
WL3-12H	7.5	3.3	12.0	1000
WL3-32H	7.5	3.3	32.0	
WL3-35H	5.6	3.5	29.9	
WL3-52H	7.5	3.2	52.0	
WL3-60H	8.0	3.6	62.0	
WL4-35H	8.5	4.2	35.0	
WL4-50H	8.0	4.1	52.0	500
WL4-56H	8.0	4.1	48.2	
WL4-70H	7.5	4.2	74.5	
WL4-78H	8.0	4.1	78.5	
WL4-90H	7.5	4.2	94.5	
WL5-70H	8.4	5.1	60.0	
WL6-78H	10.0	6.0	78.0	

WIRE CLAMP

- ◆ METAL MATERIAL: STEEL
- ◆ PLASTIC MAT'L: PVC TUBE (UL)
- ◆ COLOR: BLACK
- ◆ UNIT: mm

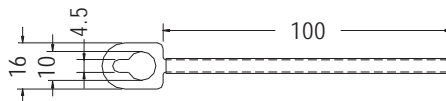

PART NO	PACKAGE
WLC-1	500

WIRE CLAMP

- ◆ METAL MATERIAL: STEEL
- ◆ METAL FINISH: TIN PLATED
- ◆ PLASTIC MAT'L: POLYOLEFIN (UL) / PVC TUBE (UL)
- ◆ COLOR: BLACK
- ◆ UNIT: mm

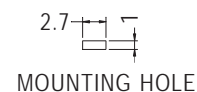
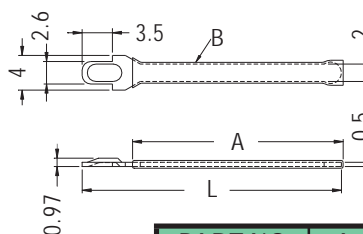
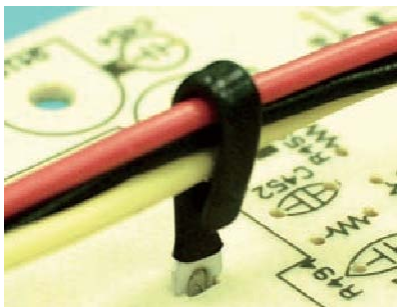

PART NO	A	B	L	PACKAGE
WLD-30H	24.0	1.5 HEAT SHRINKING	30.0	1000
WLD-50H	47.0		50.0	
WLD-30T	25.0	1.93 PVC TUBE	30.0	
WLD-50T	45.0		50.0	



TEST PIN

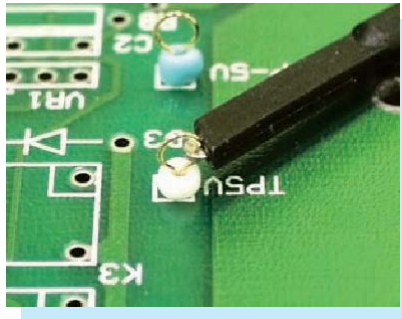

- ◆ MATERIAL:PBT (UL)
- ◆ FLAME CLASS:94V-0
- ◆ FINISH:PHOSPHER BRONZE GOLD PLATED
- ◆ UNIT:mm

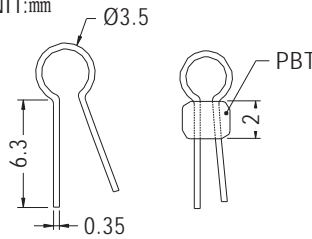

TEST-1 HOLE IN P.C.B Ø0.8-Ø1.0

PART NO	COLOR	PACKAGE
TEST-1(R)	RED	1000
TEST-1(GR)	GREEN	
TEST-1(BU)	BLUE	
TEST-1(BK)	BLACK	
TEST-1(Y)	YELLOW	
TEST-1(W)	WHITE	

TEST PIN



- ◆ FINISH:PHOSPHER BRONZE GOLD PLATED
- ◆ UNIT:mm

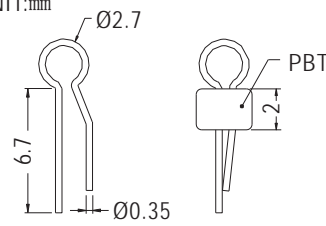

TEST-3 HOLE IN P.C.B Ø0.8-Ø1.0

PART NO	COLOR	PACKAGE
TEST-3(R)	RED	1000
TEST-3(G)	GREEN	
TEST-3(BU)	BLUE	
TEST-3(BK)	BLACK	
TEST-3(Y)	YELLOW	
TEST-3(W)	WHITE	

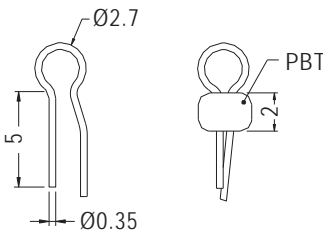

TEST-3S HOLE IN P.C.B Ø0.8-Ø1.0

PART NO	COLOR	PACKAGE
★ TEST-3S	BLACK	500

TEST PIN

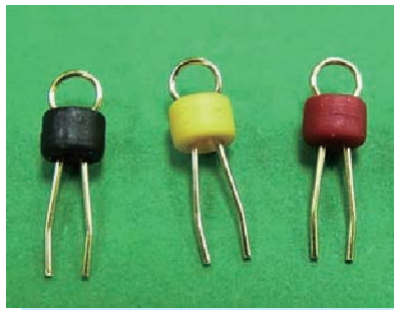

- ◆ MATERIAL:PBT (UL)
- ◆ FLAME CLASS:94V-0
- ◆ FINISH:PHOSPHER BRONZE GOLD PLATED
- ◆ UNIT:mm

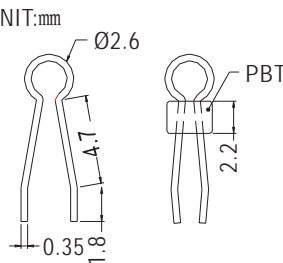

TEST-7 HOLE IN P.C.B Ø0.8-Ø1.0

PART NO	COLOR	PACKAGE
TEST-7(R)	RED	1000
TEST-7(G)	GREEN	
TEST-7(LG)	LIGHT GREEN	
TEST-7(BU)	BLUE	
TEST-7(BK)	BLACK	
TEST-7(Y)	YELLOW	
TEST-7(W)	WHITE	

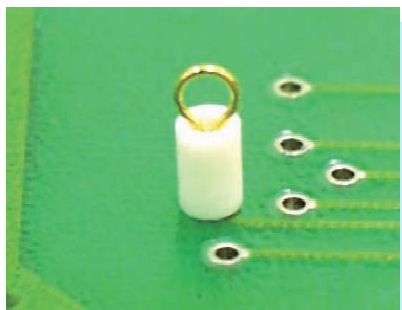

- ◆ MATERIAL:CERAMIC
- ◆ FINISH:PHOSPHER BRONZE GOLD PLATED
- ◆ UNIT:mm

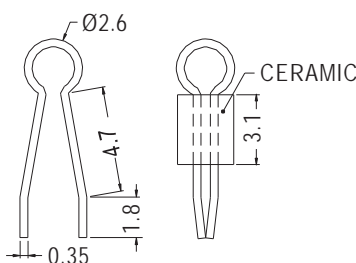

TEST-3S HOLE IN P.C.B Ø0.8-Ø1.0

PART NO	PACKAGE
TEST-7CN	1000



TEST PIN



- ◆ MATERIAL:PBT (UL)
- ◆ FLAME CLASS:94V-0
- ◆ FINISH:PHOSPHER BRONZE GOLD PLATED
- ◆ UNIT:mm

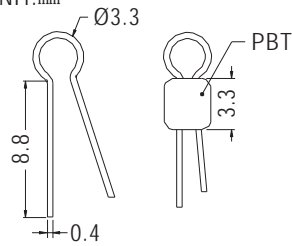

TEST-55N HOLE IN P.C.B Ø0.9-Ø1.0

PART NO	COLOR	PACKAGE
TEST-55R	RED	1000
TEST-55GR	GREEN	
TEST-55BU	BLUE	
TEST-55(B)	BLACK	
TEST-55Y	YELLOW	
TEST-55W	WHITE	

TEST PIN



- ◆ MATERIAL:PBT (UL)
- ◆ FLAME CLASS:94V-0
- ◆ FINISH:PHOSPHER BRONZE TIN PLATED
- ◆ UNIT:mm

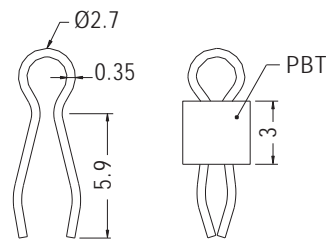

TEST-87A HOLE IN P.C.B Ø1.5

PART NO	COLOR	PACKAGE
TEST-87	WHITE	1000
TEST-87(R)	RED	
TEST-87(GR)	GREEN	
TEST-87(BU)	BLUE	
TEST-87(B)	BLACK	
TEST-87(Y)	YELLOW	

TEST PIN

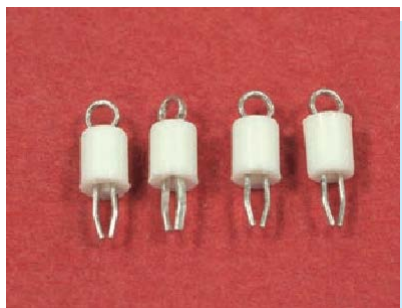

- ◆ MATERIAL:PBT (UL)
- ◆ FLAME CLASS:94V-0
- ◆ FINISH:PHOSPHER BRONZE TIN PLATED
- ◆ COLOR:WHITE
- ◆ UNIT:mm

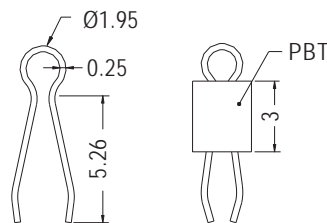

TEST-129A HOLE IN P.C.B Ø1.0

PART NO	PACKAGE
TEST-129	1000

TEST PIN

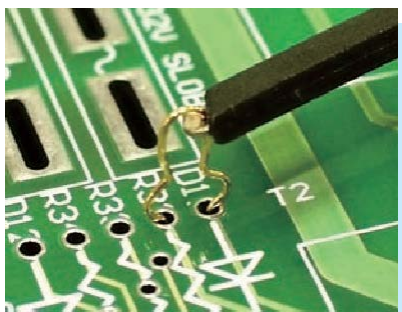

- ◆ FINISH:PHOSPHER BRONZE GOLD PLATED
- ◆ UNIT:mm

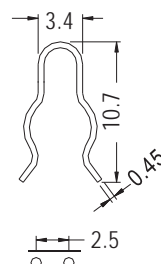

MOUNTING HOLES
HOLE IN P.C.B Ø0.8-Ø1.0

PART NO	PACKAGE
TEST-2	1000

TEST PIN

- ◆ MATERIAL:NICKEL PLATED BRASS
- ◆ UNIT:mm

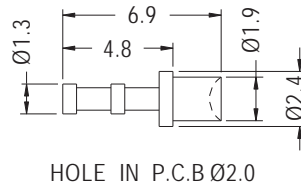

PART NO	PACKAGE
TEST-6	2000

TEST PIN

- ◆ FINISH:PHOSPHER BRONZE GOLD PLATED
- ◆ UNIT:mm

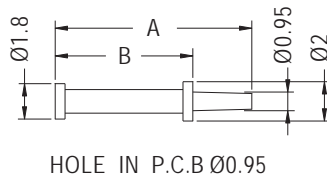
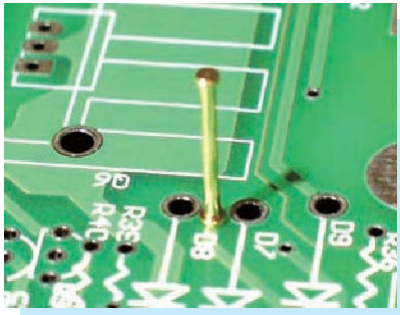

PART NO	A	B	PACKAGE
TEST-4	14.0	11.0	1000
TEST-5	10.0	7.0	2000

TEST PIN

- ◆ MATERIAL:GOLD PLATED BRASS
- ◆ UNIT:mm

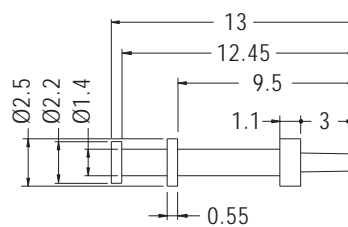

PART NO	PACKAGE
TEST-8	2000

TEST PIN

- ◆ MATERIAL:GOLD PLATED BRASS
- ◆ UNIT:mm

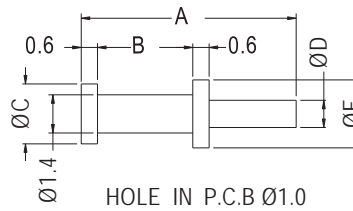
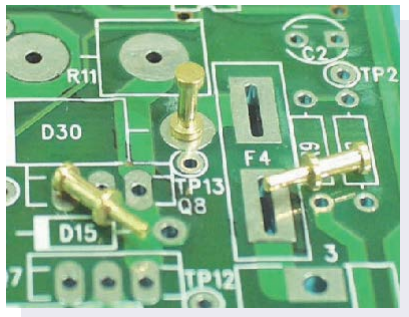

PARTNO	A	B	C	D	E	PACKAGE
TEST-22	7.9	3.5	2.2	1.0	2.5	2000
TEST-34	8.0	3.8	1.6	0.8	1.6	

TEST PIN

- ◆ MATERIAL:GOLD PLATED BRASS
- ◆ UNIT:mm

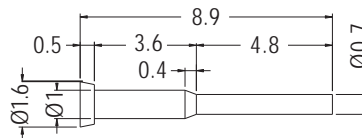

PART NO	PACKAGE
TEST-31	2000

TEST PIN

- ◆ MATERIAL: TIN PLATED BRASS
- ◆ UNIT:mm

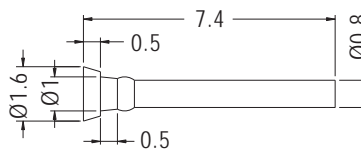

PARTNO	PACKAGE
TEST-10	2000

TEST PIN

- ◆ MATERIAL:TIN PLATED BRASS
- ◆ UNIT:mm

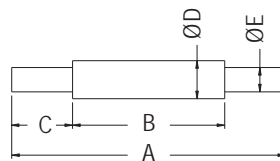

PARTNO	A	B	C	D	E	F	PACKAGE
TEST-9	16.0	10.0	3.0	1.5	1.0	1.0	2000
TEST-23	18.0	10.0	3.0	2.5	1.6	1.7	
TEST-136	19.5	16.5	3.0	2.5	1.6	1.7	

TEST PIN

- ◆ MATERIAL: GOLD PLATED BRASS
- ◆ UNIT: mm

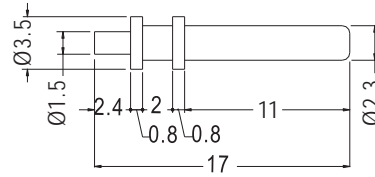
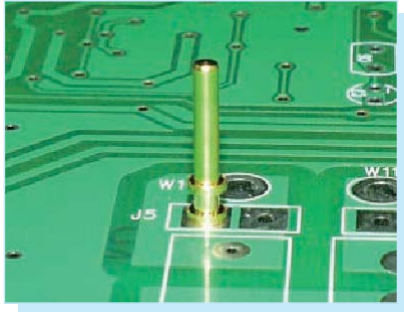

PART NO	PACKAGE
TEST-27	2000

TEST PIN

- ◆ MATERIAL: TIN PLATED BRASS
- ◆ UNIT: mm

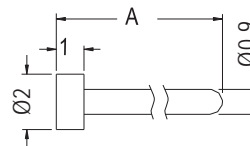

HOLE IN P.C.B Ø0.9

PART NO	A	PACKAGE
TEST-24	15.0	2000
TEST-25	6.0	
TEST-26	8.5	
TEST-28	10.0	

TEST PIN



- ◆ MATERIAL: TIN PLATED BRASS
- ◆ UNIT: mm

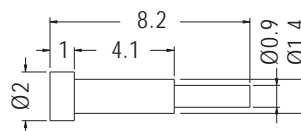

PART NO	PACKAGE
TEST-140	1000

TEST PIN



- ◆ MATERIAL:TIN PLATED BRASS
- ◆ UNIT:mm

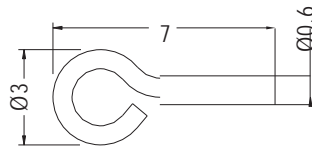

HOLE IN P.C.B Ø0.8

PART NO	PACKAGE
TEST-12	2000

TEST PIN



- ◆ MATERIAL:TIN PLATED COPPER
- ◆ UNIT:mm

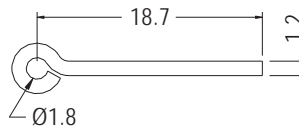

PART NO	PACKAGE
JUMP-21	1000

TEST HOLDER

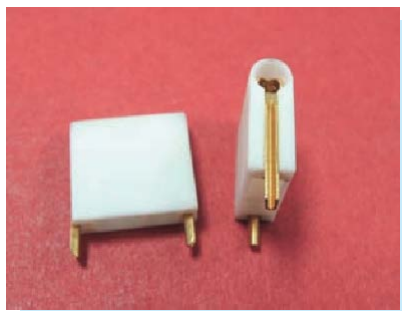

- ◆ MATERIAL:NYLON 66 (UL)
- ◆ MATERIAL FINISH:GOLD PLATED BRASS
- ◆ FLAME CLASS:94V-0
- ◆ COLOR:NATURAL
- ◆ UNIT:mm

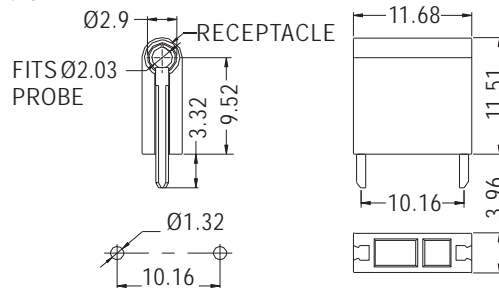

RECOMMENDED MOUNTING HOLE PATTERN

PART NO	PACKAGE
TEST-114	1000

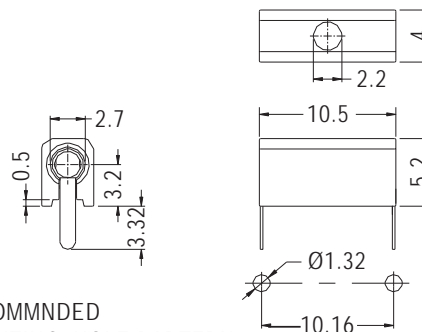
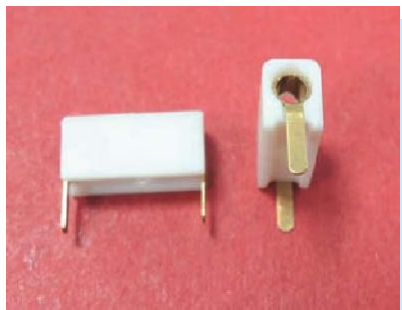

RECOMMENDED MOUNTING HOLE PATTERN

PART NO	PACKAGE
TEST-115	1000

JUMPER WIRE



- ◆ MATERIAL:TIN PLATED COPPER
- ◆ PLASTIC MATERIAL:POLYOEFIN (UL)
- ◆ COLOR:BLACK
- ◆ UNIT:mm

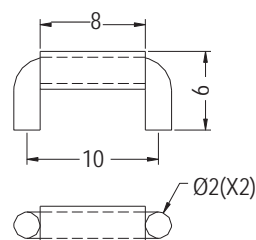

PART NO	PACKAGE
JUMP-10	1000

P.C.B TERMINAL



- ◆ MATERIAL:TIN PLATED BRASS
- ◆ UNIT:mm

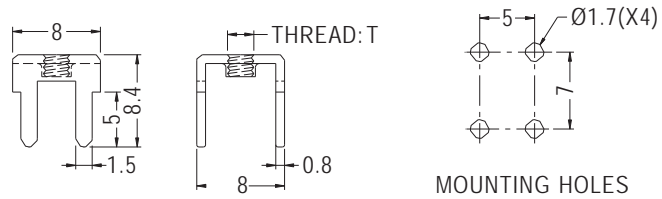

PART NO	T	PACKAGE
PCB-1	M3X0.5P	1000
PCB-1(M4)	M4X0.7P	
PCB-1(6-32)	6-32UNC	

P.C.B TERMINAL

- ◆ MATERIAL:TIN PLATED BRASS
- ◆ UNIT:mm

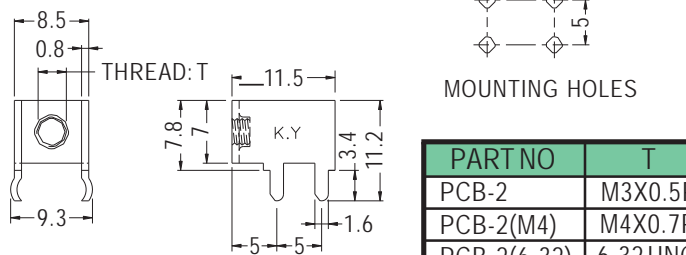
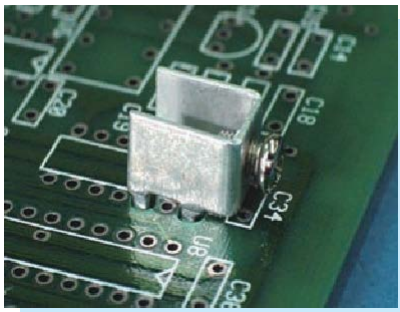

PART NO	T	PACKAGE
PCB-2	M3X0.5P	1000
PCB-2(M4)	M4X0.7P	
PCB-2(6-32)	6-32UNC	

P.C.B TERMINAL

- ◆ MATERIAL:TIN PLATED BRASS
- ◆ UNIT:mm

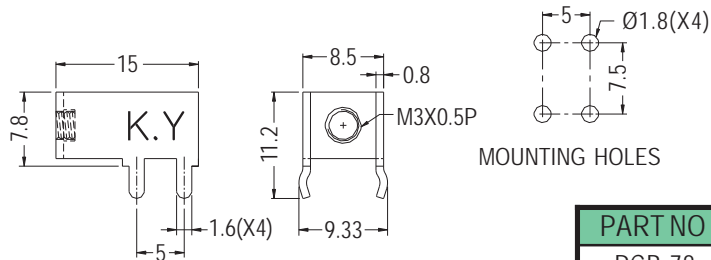

PART NO	PACKAGE
PCB-78	1000

P.C.B TERMINAL

- ◆ MATERIAL:TIN PLATED BRASS
- ◆ UNIT:mm

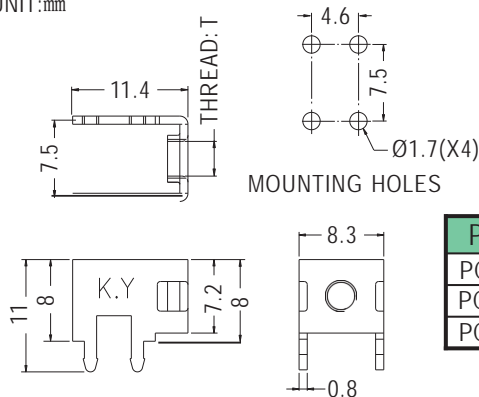
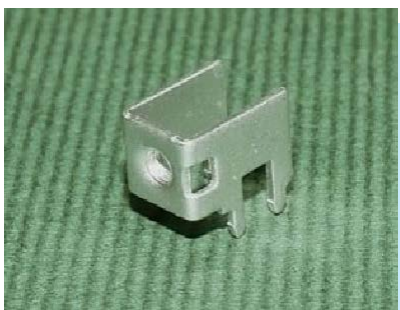

PART NO	T	PACKAGE
PCB-12	M3X0.5P	1000
PCB-12(M4)	M4X0.7P	
PCB-12(632)	6-32UNC	



P.C.B TERMINAL

- ◆ MATERIAL:TIN PLATED BRASS
- ◆ UNIT:mm

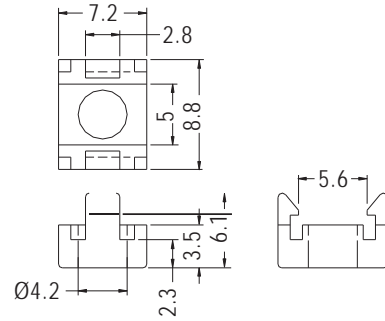
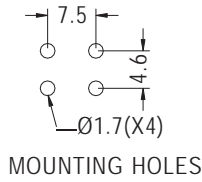
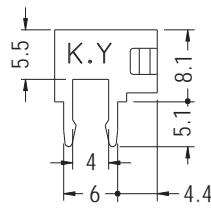
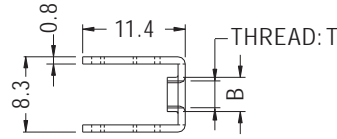
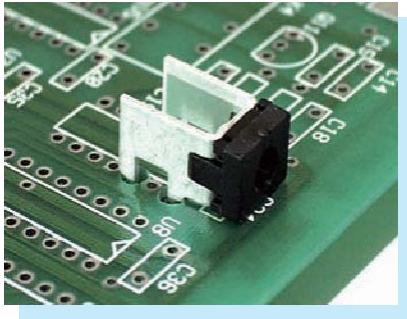

PARTNO	B	T	PACKAGE
PCB-4	3.5	M3X0.5P	1000
PCB-4(M4)	4.4	M4X0.7P	
PCB-4(632)		6-32UNC	
(ASSY)			
PCB-4(M3)F	PCB-4+PCB-4CV		
PCB-4(M4)F	PCB-4(M4)+PCB-4CV		
PCB-4(632)F	PCB-4(632)+PCB-4CV		

PARTNO	PACKAGE
PCB-4CV	1000

P.C.B TERMINAL

- ◆ MATERIAL:TIN PLATED BRASS
- ◆ UNIT:mm

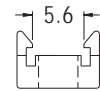
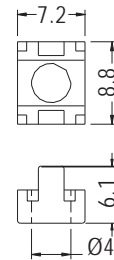
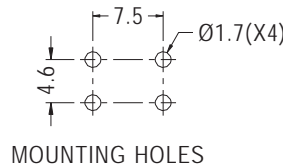
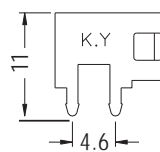
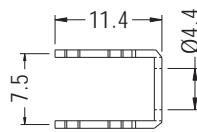
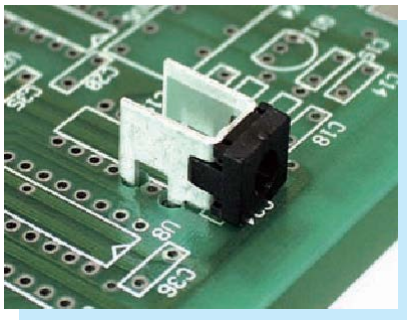

PCB-4CV

PART NO	PACKAGE
PCB-21(4.4)	1000
(ASSY)	
PCB-21(4.4)F	PCB-21(4.4)+PCB-4CV

P.C.B TERMINAL

- ◆ MATERIAL:TIN PLATED STEEL
- ◆ UNIT:mm

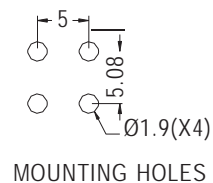
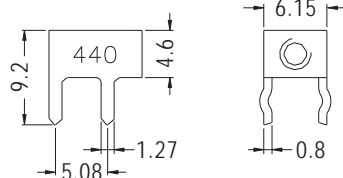
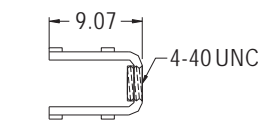

MOUNTING HOLES

PART NO	PACKAGE
PCB-47ST(440)	1000



P.C.B TERMINAL

- ◆ MATERIAL:BRASS
- ◆ FINISH:TIN PLATED
- ◆ UNIT:mm

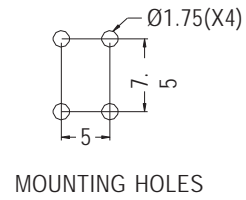
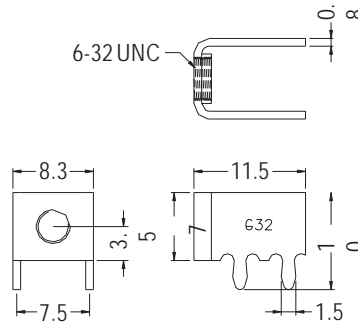

PART NO	PACKAGE
PCB-70	1000

P.C.B TERMINAL

- ◆ MATERIAL:TIN PLATED BRASS
- ◆ UNIT:mm

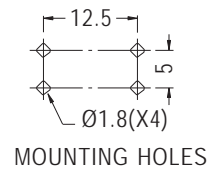
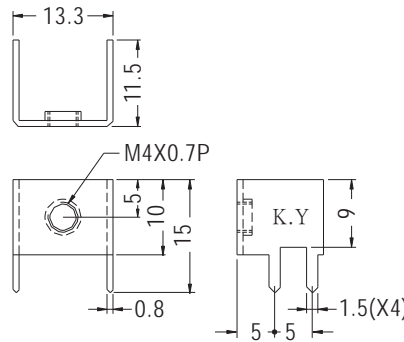
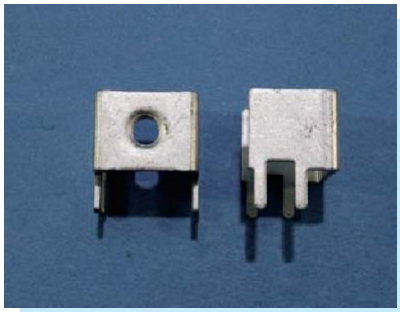

PART NO	PACKAGE
PCB-15(M4)	1000

P.C.B TERMINAL

- ◆ MATERIAL:TIN PLATED BRASS
- ◆ UNIT:mm

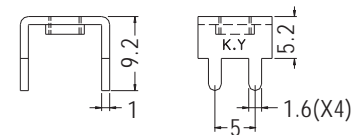
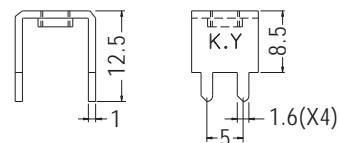
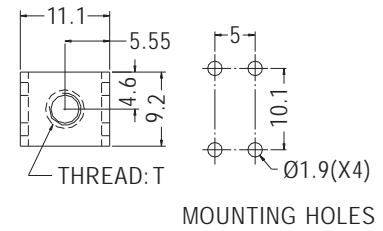
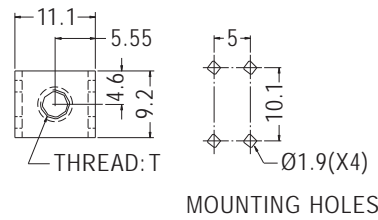

PART NO	T	PACKAGE
PCB-7	M3X0.5P	1000
PCB-7(M4)	M4X0.7P	
PCB-7(632)	6-32UNC	

PART NO	T	PACKAGE
PCB-8	M3X0.5P	1000
PCB-8(M4)	M4X0.7P	
PCB-8(632)	6-32UNC	



P.C.B TERMINAL



- ◆ MATERIAL:TIN PLATED BRASS
- ◆ UNIT:mm

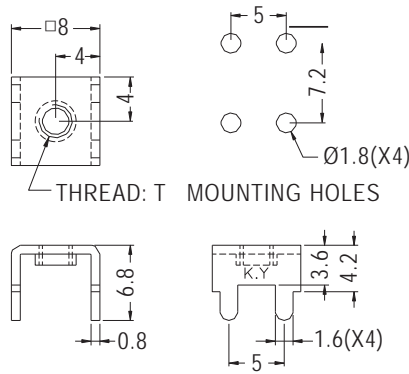

PART NO	T	PACKAGE
PCB-9	M3X0.5P	1000
PCB-9(M4)	M4X0.7P	
PCB-9(632)	6-32 UNC	

P.C.B TERMINAL



- ◆ MATERIAL:TIN PLATED BRASS
- ◆ UNIT:mm

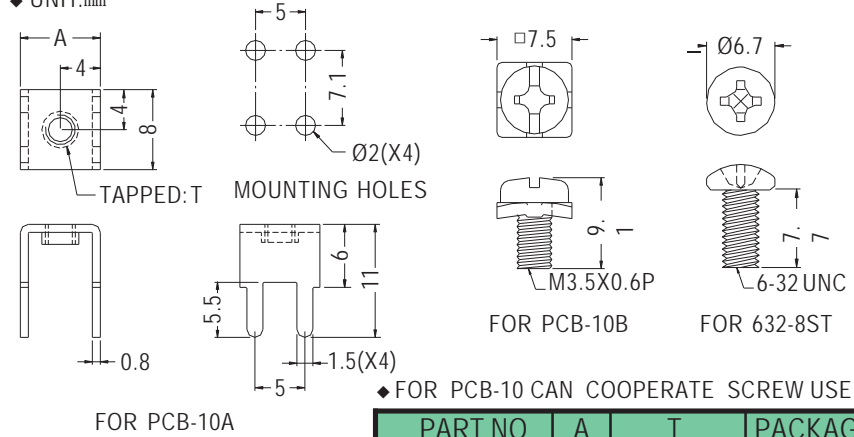

◆ FOR PCB-10 CAN COOPERATE SCREW USE

PART NO	A	T	PACKAGE
PCB-10A(M3)	8.0	M3X0.5P	1000
PCB-10A	7.9	M3.5X0.6P	
PCB-10AM4	7.9	M4X0.7P	
PCB-10A(632)	8.0	6-32 UNC	
(ASSY)			
PCB-10	PCB-10A+PCB-10B		
PCB-10M4F	PCB-10AM4+PCB-10BM4		
PCB-10(632)F	PCB-10A(632)+632-8ST		

P.C.B TERMINAL



- ◆ MATERIAL:TIN PLATED BRASS
- ◆ UNIT:mm

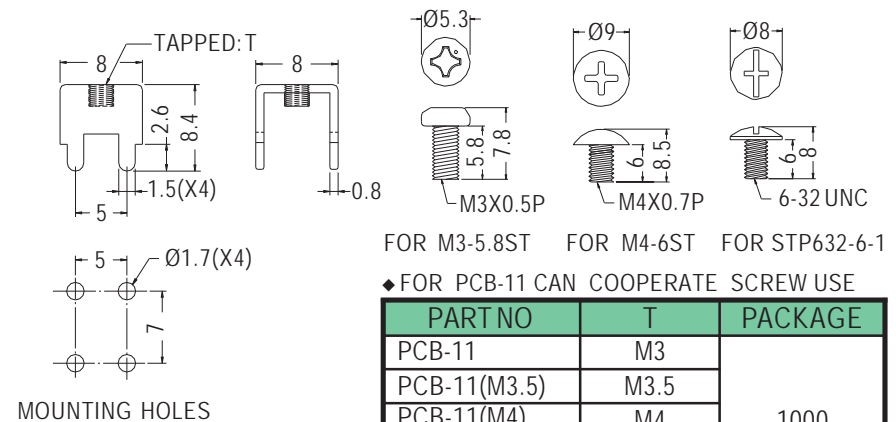

FOR M3-5.8ST FOR M4-6ST FOR STP632-6-1

◆ FOR PCB-11 CAN COOPERATE SCREW USE

PART NO	T	PACKAGE
PCB-11	M3	1000
PCB-11(M3.5)	M3.5	
PCB-11(M4)	M4	
PCB-11(632)	6-32 UNC	
(ASSY)		
PCB-11M3-5.8F	PCB-11+M3-5.8ST	
PCB-11M4-6F	PCB-11(M4)+M4-6ST	
PCB-11(632)F	PCB-11(632)+STP632-6-1	



P.C.B TERMINAL

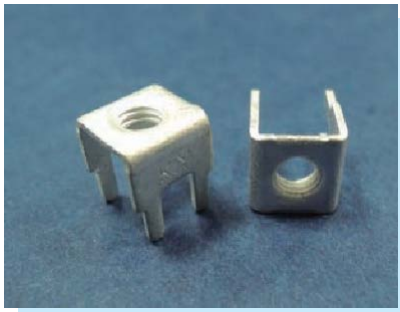

- ◆ MATERIAL:TIN PLATED BRASS
- ◆ UNIT:mm

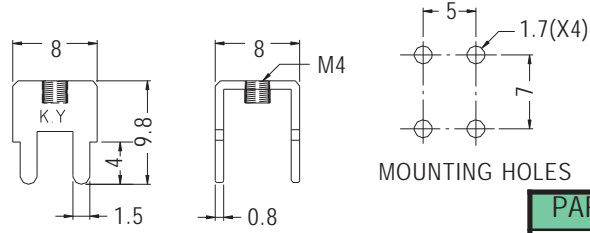

PART NO	PACKAGE
PCB-66	1000

P.C.B TERMINAL

- ◆ MATERIAL:BRASS
- ◆ FINISH:TIN PLATED
- ◆ UNIT:mm

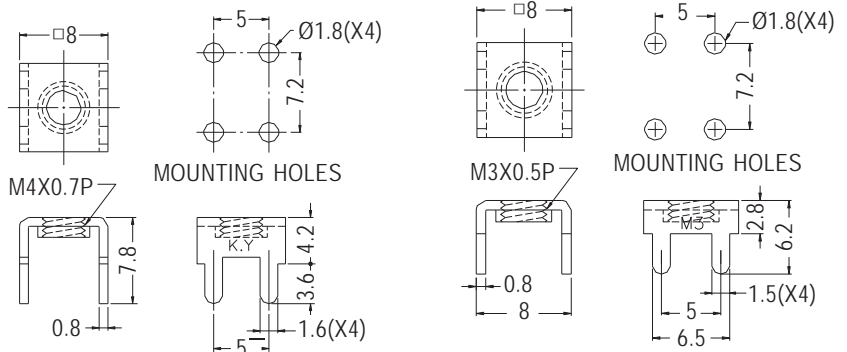
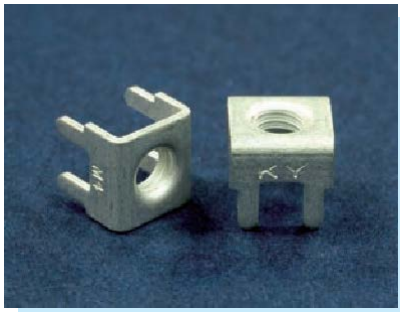

PART NO	PACKAGE
PCB-71	1000

PART NO	PACKAGE
PCB-75	1000

P.C.B TERMINAL

- ◆ MATERIAL:TIN PLATED BRASS
- ◆ UNIT:mm

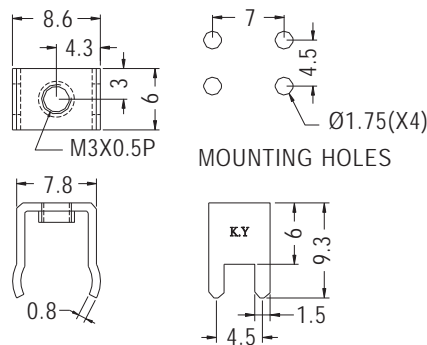

PART NO	PACKAGE
PCB-17	1000

P.C.B TERMINAL

- ◆ MATERIAL:TIN PLATED BRASS
- ◆ UNIT:mm

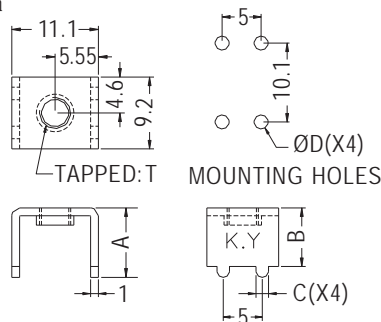

PART NO	A	B	C	D	T	PACKAGE
PCB-18	8.9	7.5	1.6	1.8	M3X0.5P	1000



P.C.B TERMINAL



- ◆ MATERIAL:TIN PLATED BRASS
- ◆ SCREW MATERIAL:NICKEL PLATED
- ◆ UNIT:mm

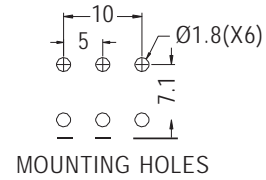
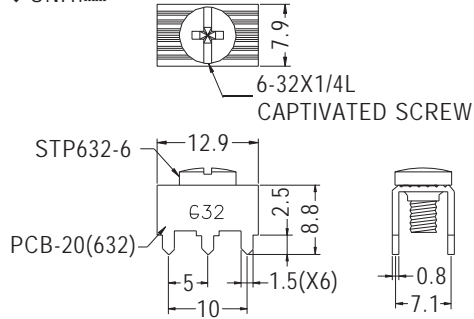

PART NO	(ASSY)	PACKAGE
PCB-20(632)F	PCB-20(632)+STP632-6	1000

P.C.B TERMINAL

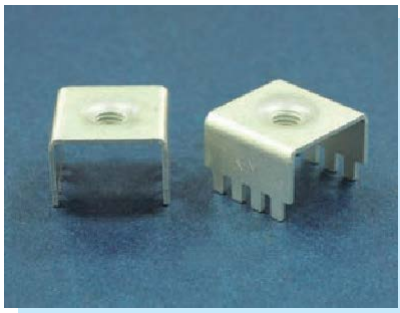

- ◆ MATERIAL:TIN PLATED COPPER
- ◆ UNIT:mm

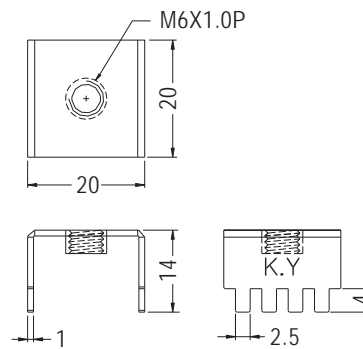

PART NO	PACKAGE
PCB-82	250

P.C.B TERMINAL

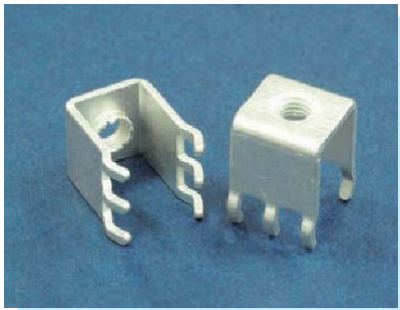

- ◆ MATERIAL:BRASS
- ◆ FINISH:DULL TINPLATED
- ◆ UNIT:mm

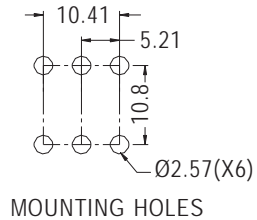
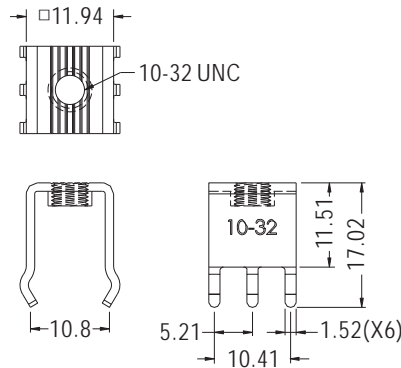

PART NO	PACKAGE
PCB-69	1000

P.C.B TERMINAL



- ◆ MATERIAL:TIN PLATED BRASS
- ◆ UNIT:mm

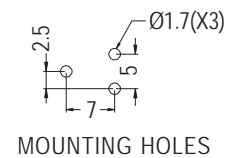
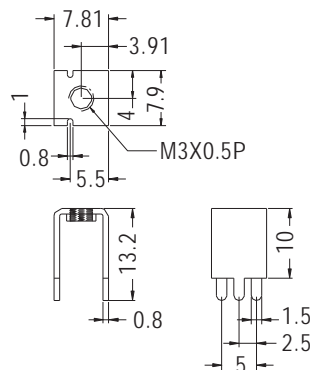

PART NO	PACKAGE
PCB-26	1000



P.C.B TERMINAL

- ◆ MATERIAL: NICKEL PLATED BRASS
- ◆ UNIT: mm

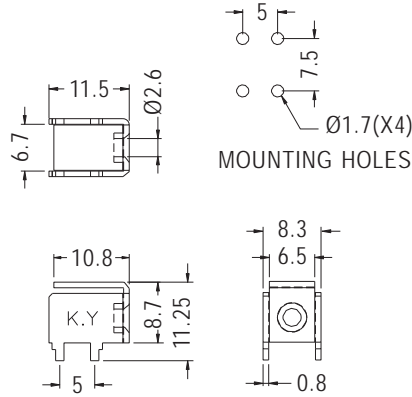

PART NO	PACKAGE
PCB-34	1000

P.C.B TERMINAL

- ◆ MATERIAL: TIN PLATED BRASS
- ◆ UNIT: mm

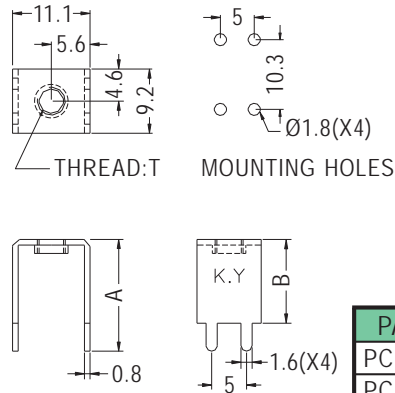
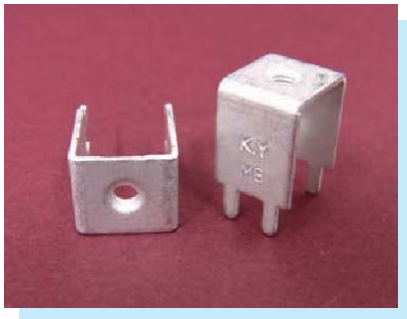

PART NO	A	B	T	PACKAGE
PCB-27(M3)	16.0	12.0	M3X0.5P	1000
PCB-27(M4)	16.0	12.0	M4X0.7P	
PCB-28(M3)	18.8	14.8	M3X0.5P	
PCB-28(M4)	18.8	14.8	M4X0.7P	

P.C.B TERMINAL

- ◆ MATERIAL: TIN PLATED BRASS
- ◆ UNIT: mm

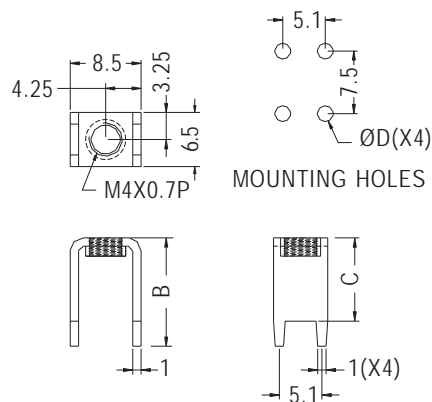

PART NO	B	C	D	PACKAGE
PCB-37M4	8.0	5.0	1.7	1000
PCB-58M4	13.0	10.0	1.9	



P.C.B TERMINAL

- ◆ MATERIAL:TIN PLATED BRASS
- ◆ UNIT:mm

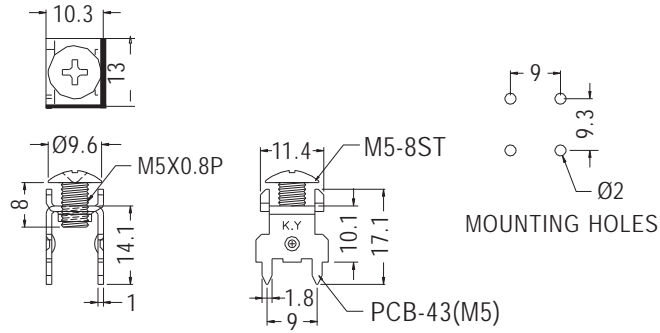

PART NO	(ASSY)	PACKAGE
PCB-43(M5)F	PCB-43(M5)+M5-8ST	500

P.C.B TERMINAL

- ◆ MATERIAL:NICKEL PLATED BRASS
- ◆ UNIT:mm

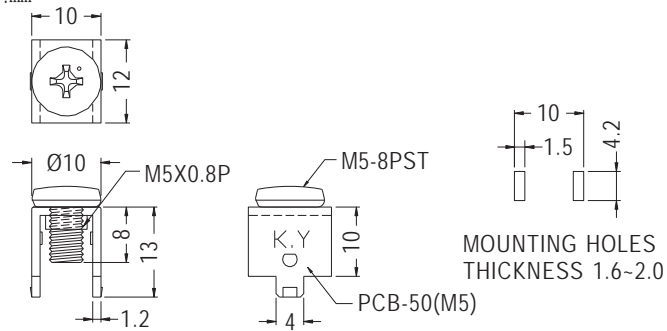

PART NO	(ASSY)	PACKAGE
PCB-50M5F	PCB-50(M5)+M5-8PST	500

P.C.B TERMINAL

- ◆ MATERIAL:TIN PLATED SPCC
- ◆ UNIT:mm

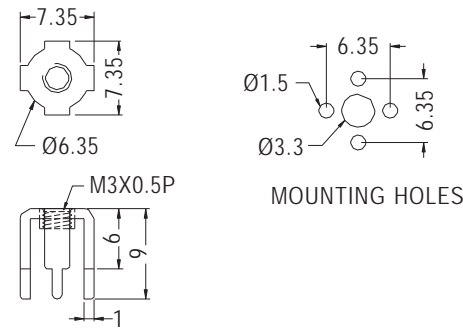

PART NO	PACKAGE
PCB-49(M3)	1000

P.C.B TERMINAL

- ◆ MATERIAL:PHOSPHOR BRONZE WITH TINPLATED
- ◆ UNIT:mm

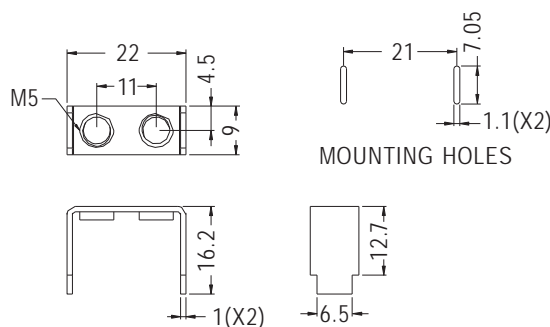
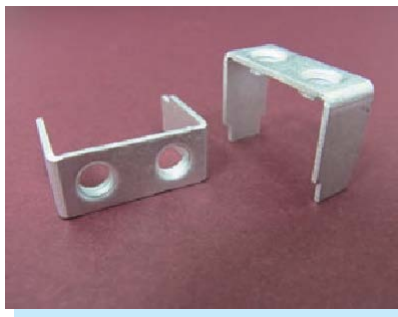

PART NO	PACKAGE
PCB-36	500



P.C.B TERMINAL

- ◆ MATERIAL:TIN PLATED BRASS
- ◆ UNIT:mm

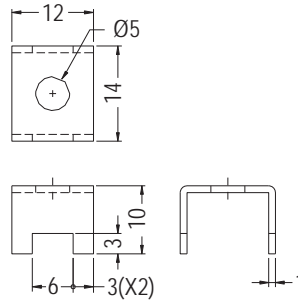

PART NO	PACKAGE
PCB-77	1000

P.C.B TERMINAL

- ◆ MATERIAL:TIN PLATED BRASS
- ◆ UNIT:mm

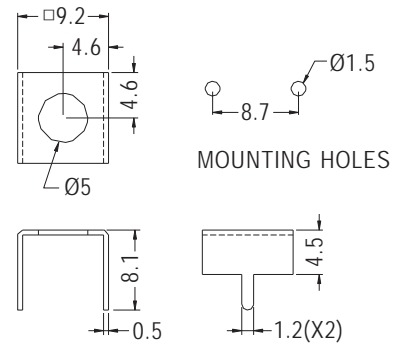
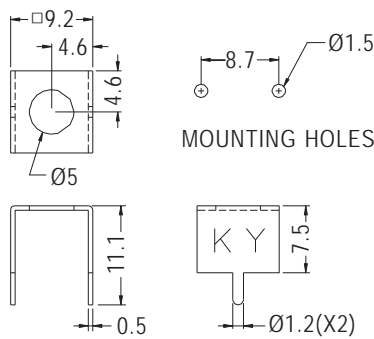

PART NO	PACKAGE
PCB-29	1000

PART NO	PACKAGE
PCB-44	1000

P.C.B TERMINAL

- ◆ MATERIAL:TIN PLATED BRASS
- ◆ UNIT:mm

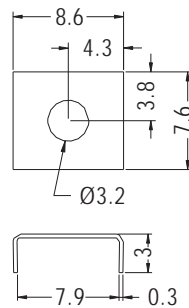
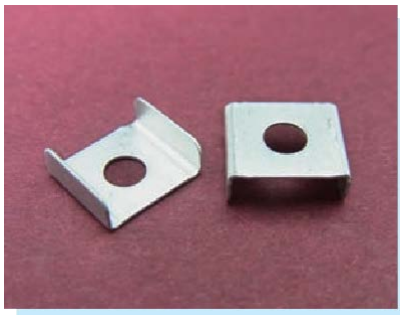

PART NO	PACKAGE
PCB-25(3.2)	1000

P.C.B TERMINAL

- ◆ MATERIAL:PHOSPHOR BRONZE WITH TIN PLATED
- ◆ UNIT:mm

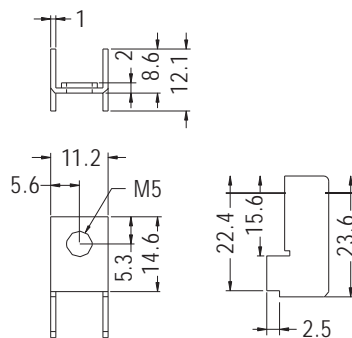

PART NO	PACKAGE
PCB-23(M5)	1000



P.C.B TERMINAL



- ◆ MATERIAL:BRASS
- ◆ FINISH:NICKEL PLATED
- ◆ UNIT:mm

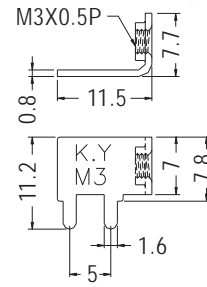
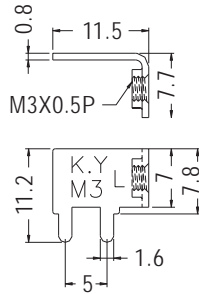

PART NO	PACKAGE
PCB-54L(M3)	1000

PART NO	PACKAGE
PCB-54R(M3)	1000

P.C.B TERMINAL

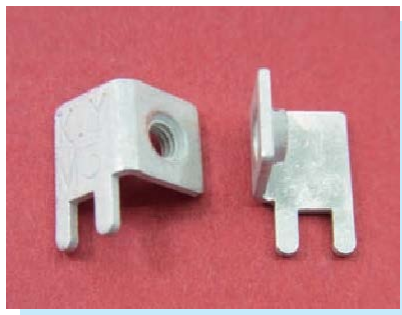

- ◆ MATERIAL:BRASS
- ◆ FINISH:NICKEL PLATED
- ◆ UNIT:mm

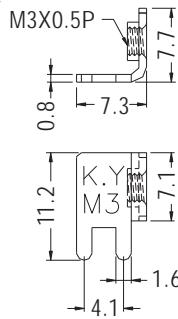

PART NO	PACKAGE
PCB-55(M3)	1000

P.C.B TERMINAL



- ◆ MATERIAL:TIN PLATED BRASS
- ◆ UNIT:mm

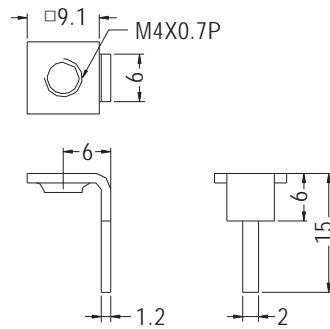

PART NO	PACKAGE
PCB-22(M4)	1000

HOLE IN P.C.B Ø2.5

P.C.B TERMINAL



- ◆ MATERIAL:TIN PLATED BRASS
- ◆ UNIT:mm

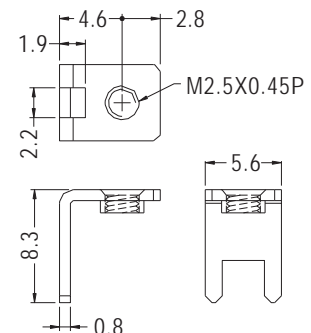
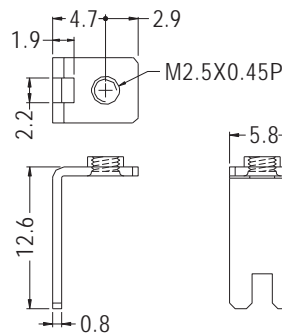

PART NO	PACKAGE
PCB-73	1000

PART NO	PACKAGE
PCB-74	1000



P.C.B TERMINAL

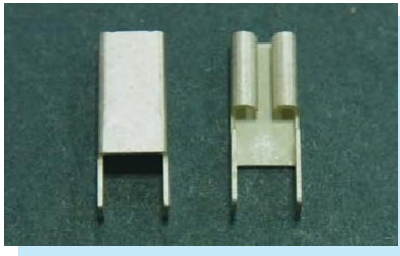

- ◆ MATERIAL:TIN PLATED BRASS
- ◆ UNIT:mm

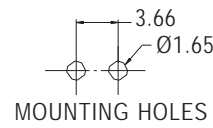
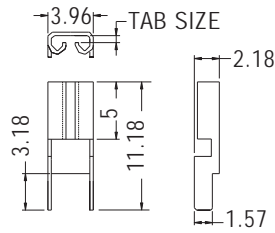

MOUNTING HOLES

PART NO	TAB SIZE	PACKAGE
PCFS156A	0.5X2.8	1000

P.C.B TERMINAL



- ◆ MATERIAL:TIN PLATED BRASS
- ◆ UNIT:mm

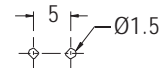
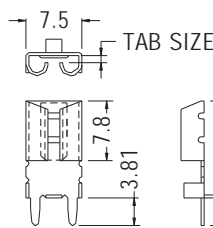

MOUNTING HOLES
THICKNESS 0.45

PART NO	TAB SIZE	PACKAGE
PCFS250L	0.8X6.35	1000

P.C.B TERMINAL

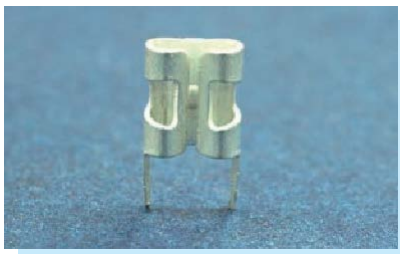

- ◆ MATERIAL:TIN PLATED BRASS
- ◆ UNIT:mm

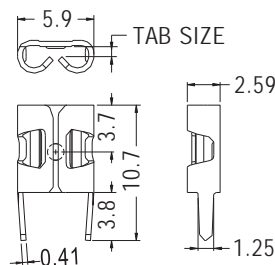

MOUNTING HOLES

PART NO	TAB SIZE	PACKAGE
PCFS187	0.81X4.8	1000

P.C.B TERMINAL



- ◆ MATERIAL:TIN PLATED BRASS
- ◆ UNIT:mm

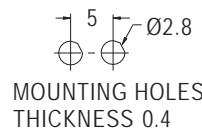
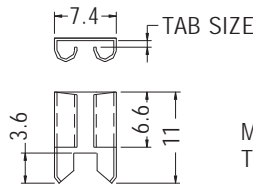

MOUNTING HOLES
THICKNESS 0.4

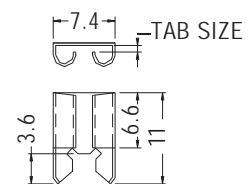

PART NO	TAB SIZE	PACKAGE
PCFS2505	0.5X6.35	1000
PCFS2508	0.8X6.35	

PART NO	TAB SIZE	PACKAGE
PCFS2505A	0.5X6.35	1000
PCFS2508A	0.8X6.35	

P.C.B TERMINAL



- ◆ MATERIAL:SHINY TIN PLATED BRASS
- ◆ UNIT:mm

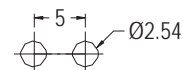
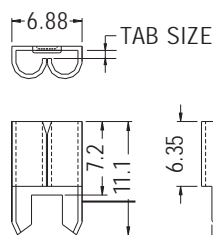

MOUNTING HOLES

PART NO	TAB SIZE	PACKAGE
PCFS2509A	0.6X6	1000



P.C.B TERMINAL



- ◆ MATERIAL:TIN PLATED BRASS
- ◆ UNIT:mm

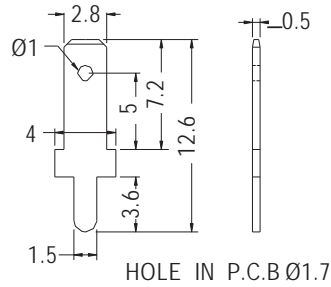

PARTNO	PACKAGE
PC110	2000

P.C.B TERMINAL



- ◆ MATERIAL:PLATED NICKEL BRASS/
PLATED TIN BRASS
- ◆ UNIT:mm

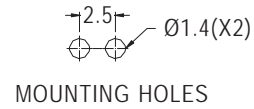
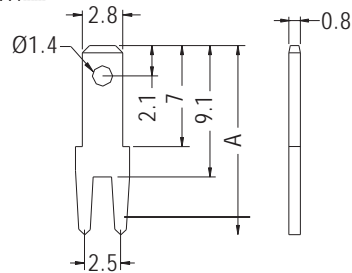

PARTNO	A	PACKAGE
PC110-1	13.1	2000
PC110-4	12.1	

P.C.B TERMINAL



- ◆ MATERIAL:TIN PLATED BRASS
- ◆ UNIT:mm

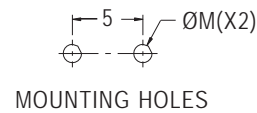
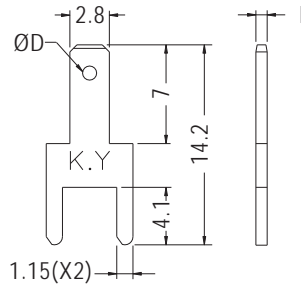

PART NO	D	I	M	PACKAGE
PC110D5	1.0	0.5	1.4	2000
★ PC110D5-1	1.3	0.5	1.3	
PC110D8	0.8	0.8	1.5	

P.C.B TERMINAL



- ◆ MATERIAL:TIN PLATED BRASS
- ◆ UNIT:mm

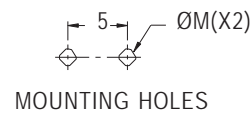
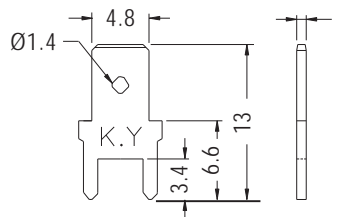

PART NO	I	M	PACKAGE
PC187	0.5	1.4	2000
PC187(0.8)	0.8	1.5	

P.C.B TERMINAL



- ◆ MATERIAL:TIN PLATED BRASS
- ◆ UNIT:mm

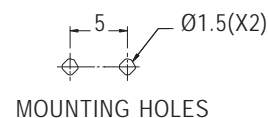
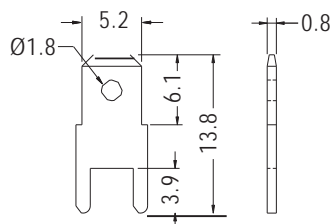

PART NO	PACKAGE
PC205	1000

P.C.B TERMINAL



- ◆ MATERIAL:TIN PLATED BRASS
- ◆ UNIT:mm

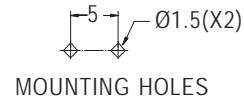
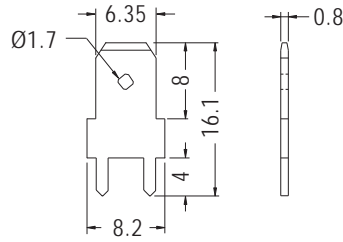

PART NO	PACKAGE
PC250	1000

P.C.B TERMINAL

- ◆ MATERIAL:NICKEL PLATED BRASS
- ◆ UNIT:mm

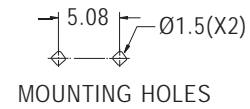
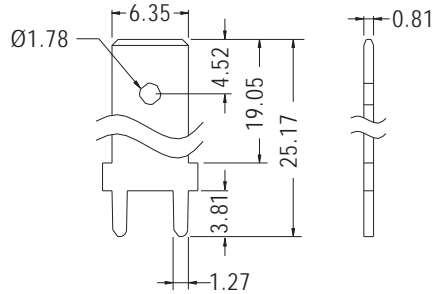

PART NO	PACKAGE
PC250-4	1000

P.C.B TERMINAL

- ◆ MATERIAL:TIN PLATED BRASS
- ◆ UNIT:mm

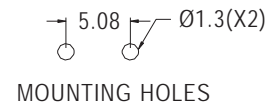
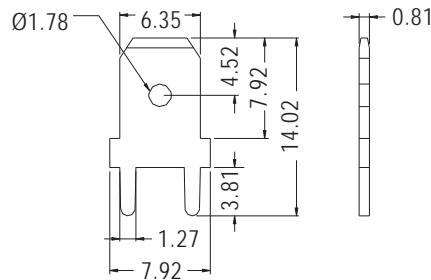

PART NO	PACKAGE
PC250-8	1000

P.C.B TERMINAL

- ◆ MATERIAL:TIN PLATED BRASS
- ◆ UNIT:mm

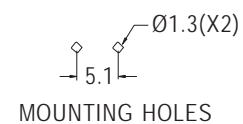
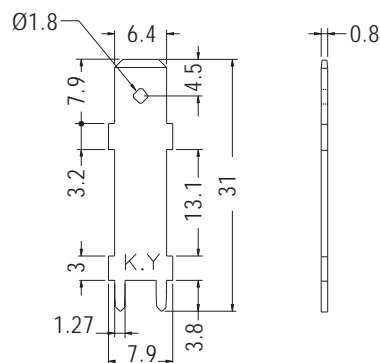
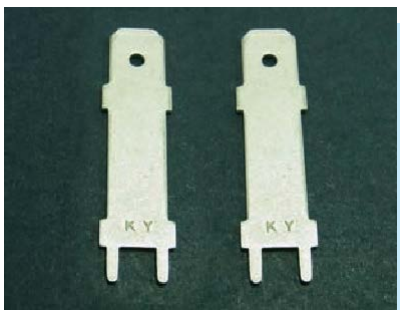

PART NO	PACKAGE
PC250-11	1000

P.C.B TERMINAL



- ◆ MATERIAL:TIN PLATED BRASS
- ◆ UNIT:mm

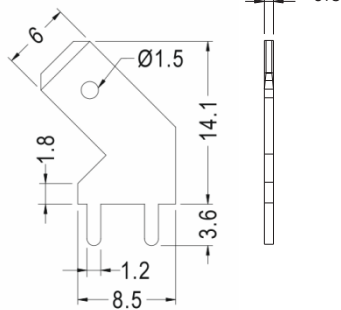

PART NO	PACKAGE
PCRL250	1000

P.C.B TERMINAL

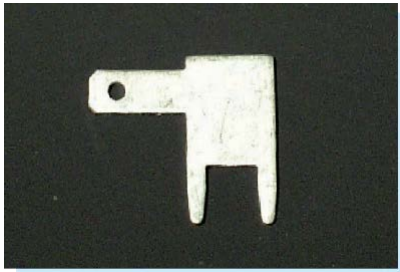

- ◆ MATERIAL:TIN PLATED BRASS
- ◆ UNIT:mm

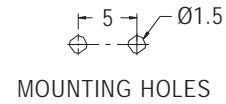
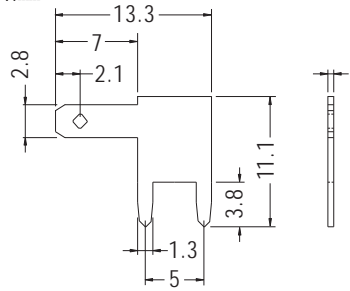

PART NO	I	PACKAGE
PCF110	0.5	1000
PCF1108	0.8	

P.C.B TERMINAL



- ◆ MATERIAL:TIN PLATED BRASS
- ◆ UNIT:mm

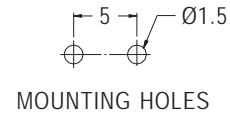
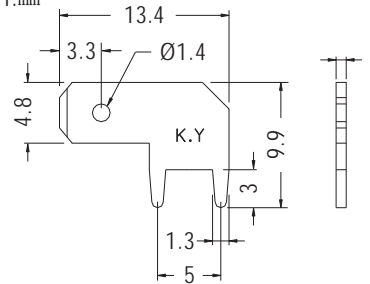

PART NO	I	PACKAGE
PCF187(5)	0.5	1000
PCF187	0.8	

P.C.B TERMINAL

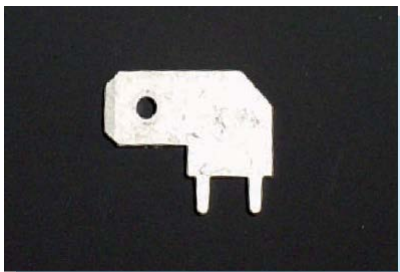

- ◆ MATERIAL:TIN PLATED BRASS
- ◆ UNIT:mm

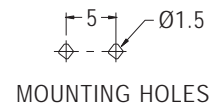
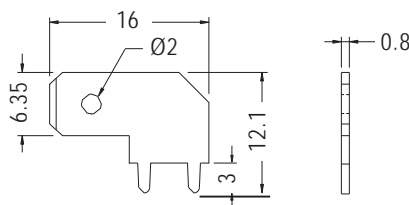

PART NO	PACKAGE
PCF250	1000

P.C.B TERMINAL

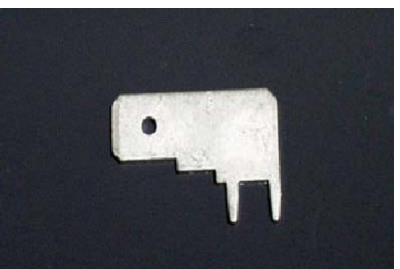

- ◆ MATERIAL:TIN PLATED BRASS
- ◆ UNIT:mm

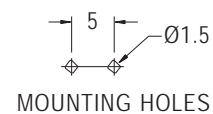
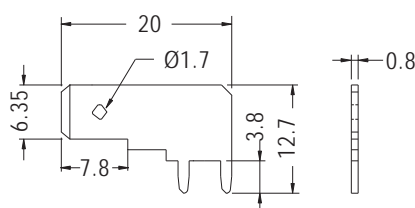

PART NO	PACKAGE
PCFL250	1000

P.C.B TERMINAL

- ◆ MATERIAL:TIN PLATED BRASS
- ◆ UNIT:mm

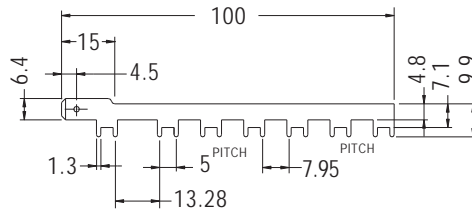

PART NO	PACKAGE
PCF250-7	500

P.C.B TERMINAL

- ◆ MATERIAL:TIN PLATED BRASS
- ◆ UNIT:mm

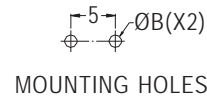
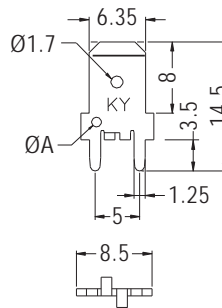
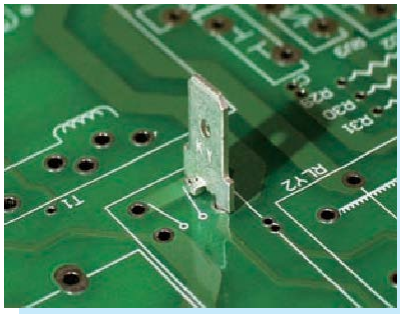

PART NO	A	B	PACKAGE
PCH250	/	1.5	1000
PCH250-1	1.1	1.4	

P.C.B TERMINAL

- ◆ MATERIAL:TIN PLATED BRASS
- ◆ UNIT:mm

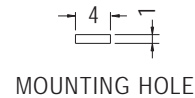
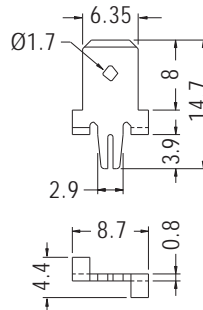
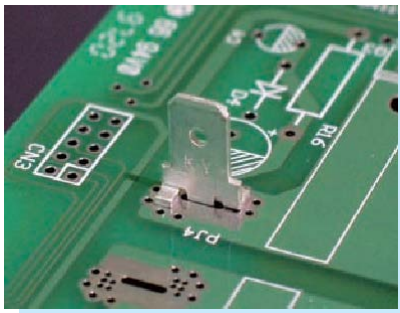

PART NO	PACKAGE
PCK250	1000

P.C.B TERMINAL

- ◆ MATERIAL:TIN PLATED BRASS
- ◆ UNIT:mm

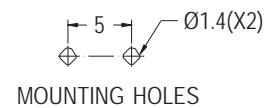
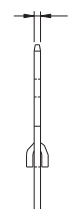
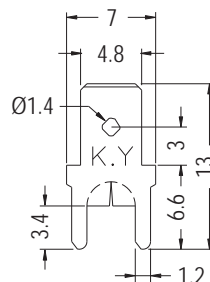

PART NO	I	PACKAGE
PCR187	0.5	1000
PCR187(0.8)	0.8	

P.C.B TERMINAL

- ◆ MATERIAL:TIN PLATED BRASS
- ◆ UNIT:mm

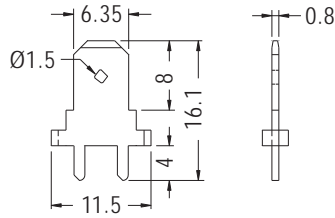

PART NO	PACKAGE
PCR250	1000

10

P.C.B TERMINAL

- ◆ MATERIAL:TIN PLATED BRASS
- ◆ UNIT:mm

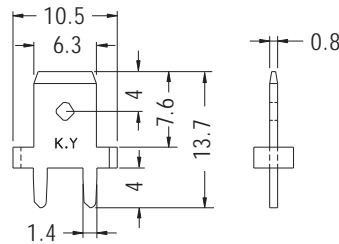
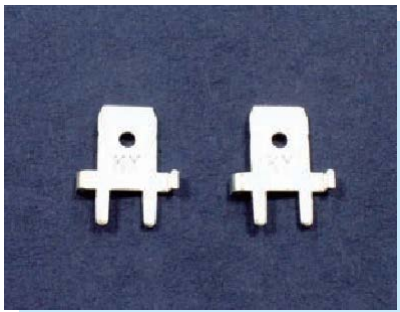

PART NO	PACKAGE
PCR250-S	1000

P.C.B TERMINAL

- ◆ MATERIAL:TIN PLATED BRASS
- ◆ UNIT:mm

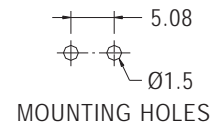
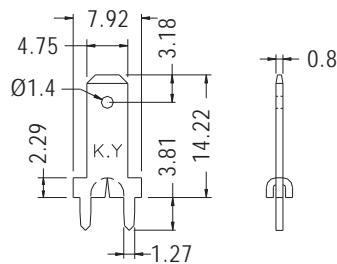

PART NO	PACKAGE
PCRS187A	1000

P.C.B TERMINAL

- ◆ MATERIAL:TIN PLATED BRASS
- ◆ UNIT:mm

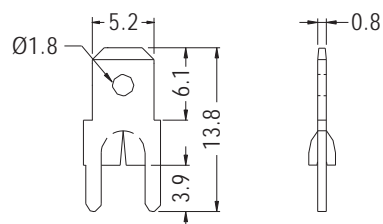

PART NO	PACKAGE
PCRS205	1000



P.C.B TERMINAL

- ◆ MATERIAL:TIN PLATED BRASS
- ◆ UNIT:mm

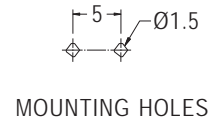
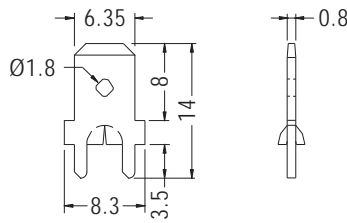
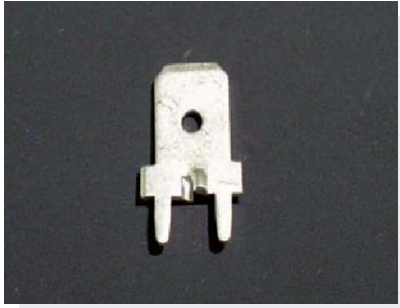

PART NO	PACKAGE
PCRS250	1000

P.C.B TERMINAL

- ◆ MATERIAL:TIN PLATED BRASS
- ◆ UNIT:mm

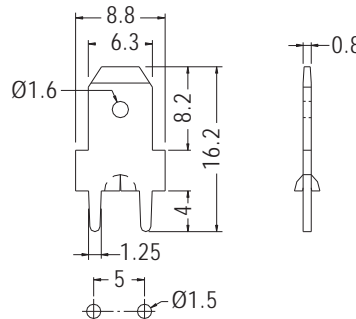

MOUNTING HOLES

PART NO	PACKAGE
PCRS250-1	1000

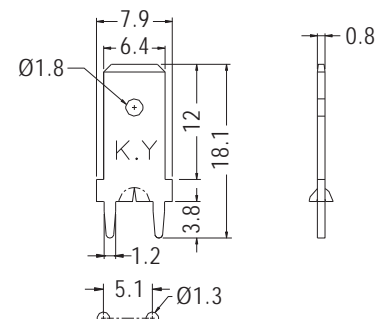

MOUNTING HOLES

PART NO	PACKAGE
PCRS250-2	1000

P.C.B TERMINAL

- ◆ MATERIAL:TIN PLATED BRASS
- ◆ UNIT:mm

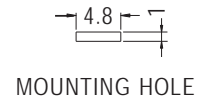
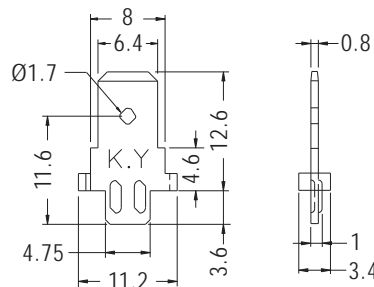

PART NO	PACKAGE
PCRN250	1000

P.C.B TERMINAL

- ◆ MATERIAL:SUS
- ◆ UNIT:mm

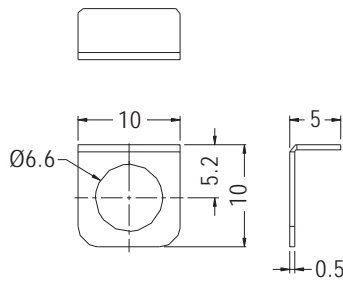

PARTNO	PACKAGE
PCTL-2	1000

P.C.B TERMINAL

- ◆ MATERIAL:TIN PLATED BRASS
- ◆ UNIT:mm

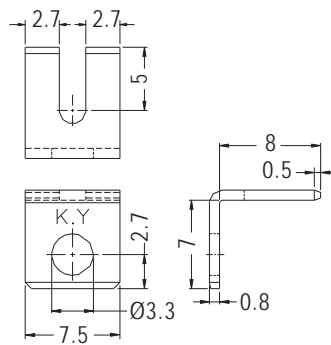

PARTNO	PACKAGE
PCTL-3.5	1000

P.C.B TERMINAL

- ◆ MATERIAL:TIN PLATED BRASS
- ◆ UNIT:mm

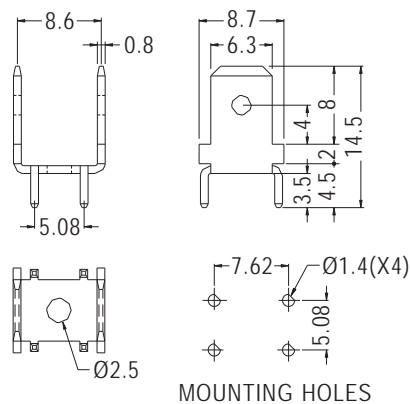
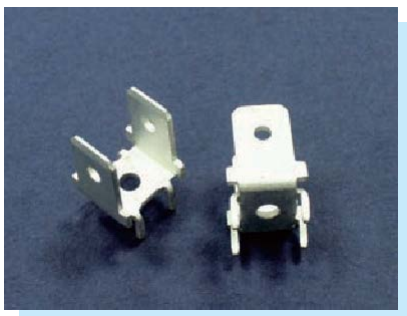

PARTNO	PACKAGE
PCU250	1000



P.C.B TERMINAL

- ◆ MATERIAL:TIN PLATED BRASS
- ◆ UNIT:mm

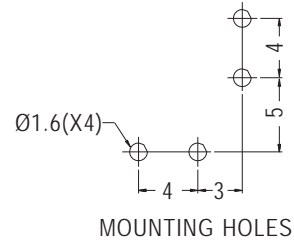
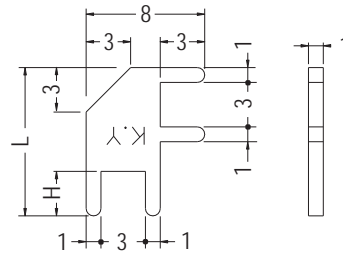

PART NO	H	L	PACKAGE
PCLT-10	3.0	10.0	1000
PCLT-11	4.0	11.0	

P.C.B TERMINAL

- ◆ MATERIAL:BRASS
- ◆ FINISH:TIN PLATED
- ◆ UNIT:mm

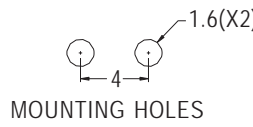
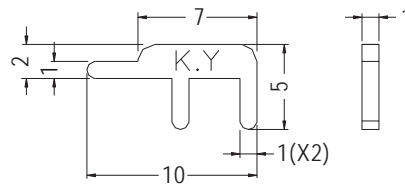

PART NO	PACKAGE
PCLTA-1	1000

P.C.B TERMINAL

- ◆ MATERIAL:BRASS
- ◆ FINISH:TIN PLATED
- ◆ UNIT:mm

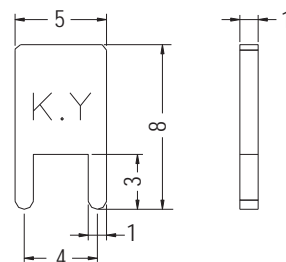
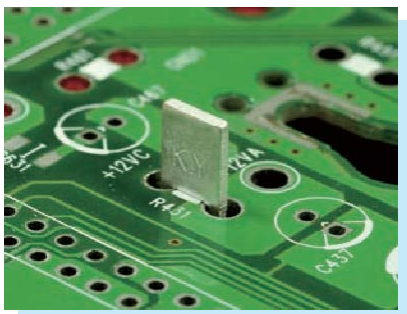

PART NO	PACKAGE
PCLTA-2	1000

PIN TERMINAL

- ◆ MATERIAL:TIN PLATED BRASS
- ◆ UNIT:mm

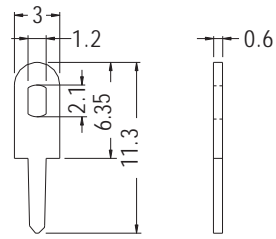

HOLE IN P.C.B Ø1.2-Ø1.3

PART NO	PACKAGE
PIN-1	2000

PIN TERMINAL

- ◆ MATERIAL:TIN PLATED BRASS
- ◆ UNIT:mm

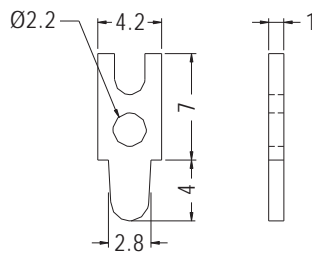

HOLE IN P.C.B Ø3.0

PART NO	PACKAGE
PIN-2	2000

PIN TERMINAL



- ◆ MATERIAL:NI PLATED BRASS
- ◆ UNIT:mm

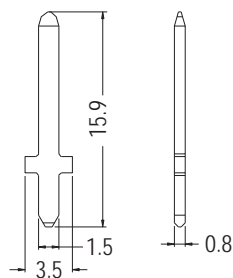

PART NO	PACKAGE
PIN-9	1000

P.C.B TERMINAL



- ◆ MATERIAL:BRASS
- ◆ FINISH:TIN PLATED
- ◆ UNIT:mm

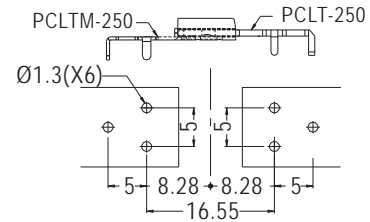
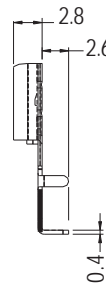
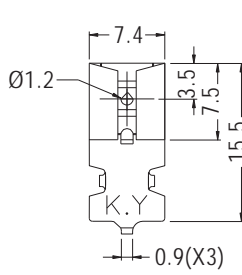
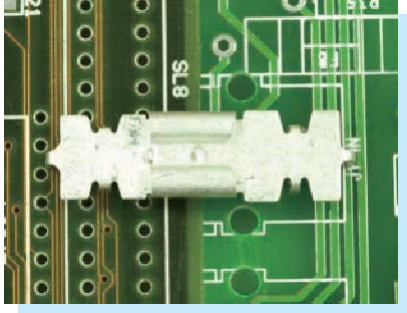

COMBINATION ILLUSTRATION DWG
MOUNTING HOLES

PART NO	PACKAGE
PCLTM-250	1000

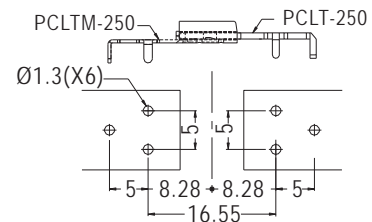
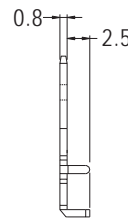
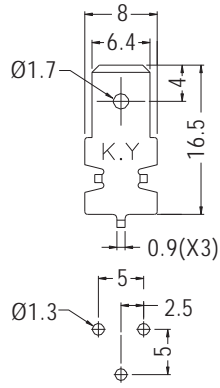

COMBINATION ILLUSTRATION DWG
MOUNTING HOLES

PART NO	PACKAGE
PCLT-250	1000

MOUNTINGHOLES

P.C.B TERMINAL

- ◆ MATERIAL:TIN PLATED BRASS
- ◆ UNIT:mm

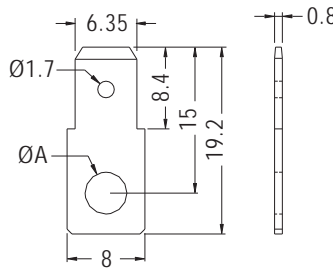

PART NO	A	PACKAGE
PC11250	4.3	1000
PC1125003	3.2	
PC1125035	3.5	
PC1125005	5.3	

P.C.B TERMINAL

- ◆ MATERIAL:TIN PLATED BRASS
- ◆ UNIT:mm

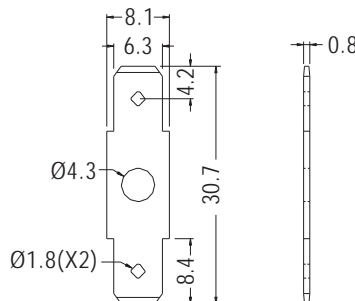

PARTNO	PACKAGE
PC12250	1000



P.C.B TERMINAL



- ◆ MATERIAL: BRASS
- ◆ FINISH: TIN PLATED
- ◆ UNIT: mm

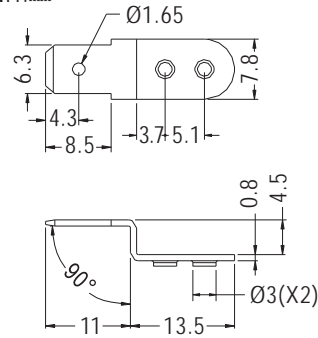

PART NO	PACKAGE
PC1L250-4	1000

P.C.B TERMINAL

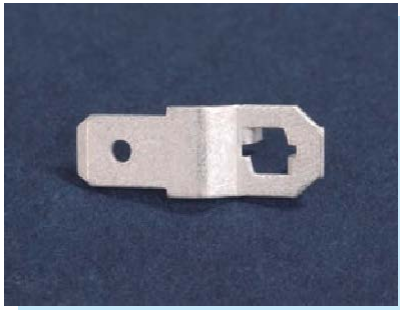

- ◆ MATERIAL: TIN PLATED BRASS
- ◆ UNIT: mm

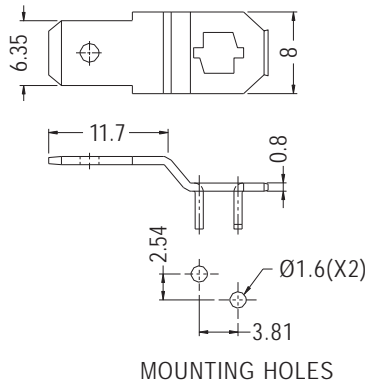

PART NO	PACKAGE
PC1L250-7	1000

P.C.B TERMINAL



- ◆ MATERIAL: TIN PLATED BRASS
- ◆ UNIT: mm

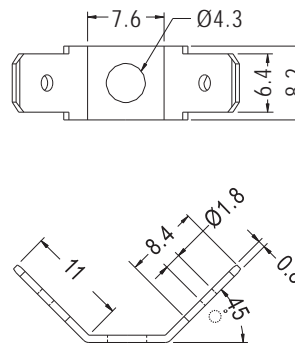

PART NO	PACKAGE
PC2L250	1000

P.C.B TERMINAL



- ◆ MATERIAL: TIN PLATED BRASS
- ◆ UNIT: mm

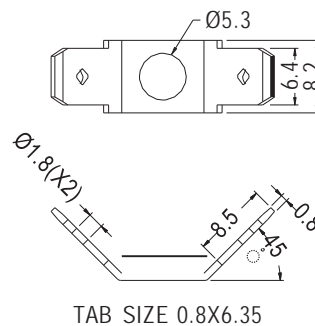

PART NO	PACKAGE
PC2L25005	1000



P.C.B TERMINAL

- ◆ MATERIAL:TIN PLATED BRASS
- ◆ UNIT:mm

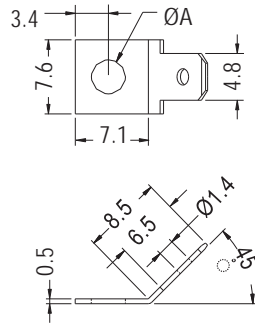

PARTNO	A	PACKAGE
PC1V187	3.7	1000
PC1V18704	4.3	
PC1V18705	5.3	

P.C.B TERMINAL

- ◆ MATERIAL:TIN PLATED BRASS
- ◆ UNIT:mm

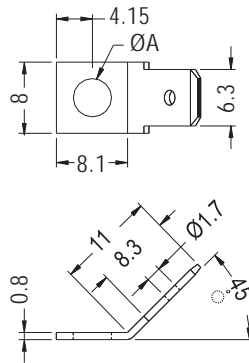

PARTNO	A	PACKAGE
PC1L250	4.3	1000
PC1L25005	5.3	

P.C.B TERMINAL

- ◆ MATERIAL:TIN PLATED BRASS
- ◆ UNIT:mm

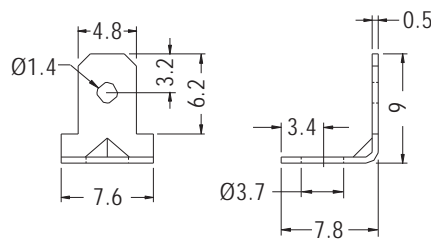

PARTNO	PACKAGE
PC1L187	1000

P.C.B TERMINAL

- ◆ MATERIAL:TIN PLATED BRASS
- ◆ UNIT:mm

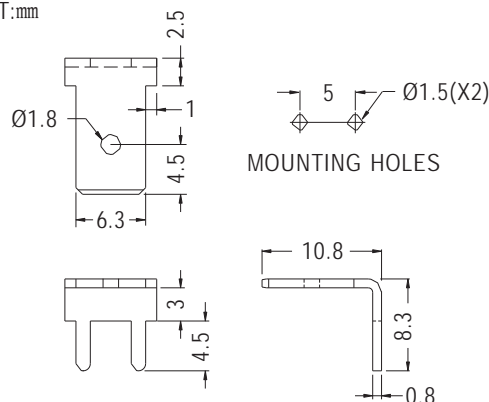

PARTNO	PACKAGE
PC1L250-1A	1000

P.C.B TERMINAL



- ◆ MATERIAL:TIN PLATED BRASS
- ◆ UNIT:mm

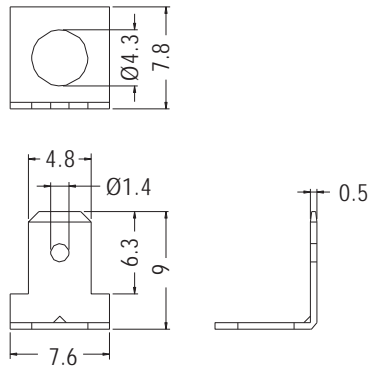

PARTNO	PACKAGE
PC3L18704	1000

P.C.B TERMINAL

- ◆ MATERIAL:TIN PLATED BRASS
- ◆ UNIT:mm

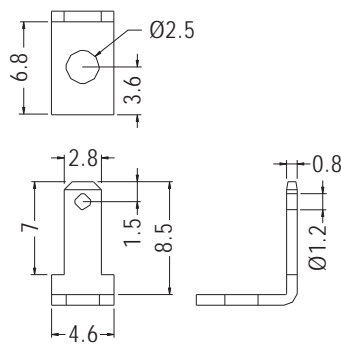

PARTNO	PACKAGE
PC3L110028	1000

P.C.B TERMINAL

- ◆ MATERIAL:TIN PLATED BRASS
- ◆ UNIT:mm

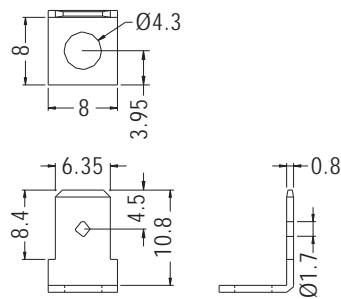

PARTNO	PACKAGE
PC3L25004	1000

P.C.B TERMINAL

- ◆ MATERIAL:TIN PLATED BRASS
- ◆ UNIT:mm

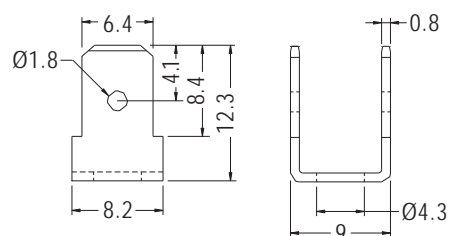

PARTNO	PACKAGE
PC2L250-90	1000

P.C.B TERMINAL

- ◆ MATERIAL:TIN PLATED BRASS
- ◆ UNIT:mm

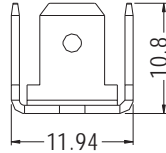
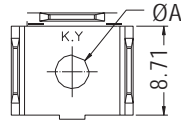

PARTNO	A	PACKAGE
PC3L250-3	3.3	1000
PC3L250-4	4.3	

P.C.B TERMINAL

- ◆ MATERIAL:TIN PLATED BRASS
- ◆ UNIT:mm

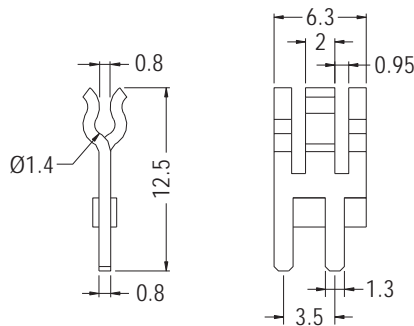
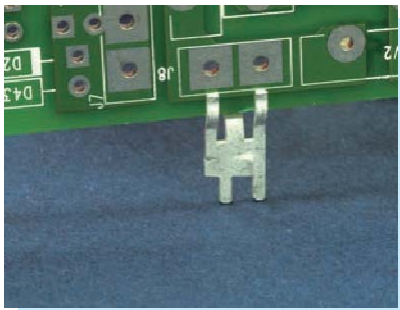

PARTNO	PACKAGE
EM-408	1000

GROUND TERMINAL

- ◆ MATERIAL:NICKEL PLATED BRONZE
- ◆ UNIT:mm

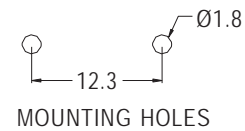
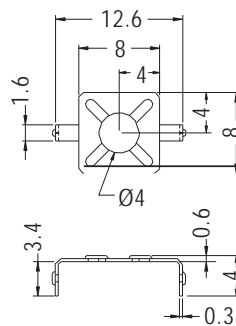

PARTNO	PACKAGE
PCB-41A	1000

GROUND TERMINAL

- ◆ MATERIAL:NICKEL PLATED BRASS
- ◆ UNIT:mm

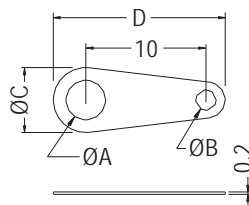

PARTNO	A	B	C	D	PACKAGE
GND-1	3.2	1.6	5.5	14.3	2000
GND-3A	4.1	2.4	6.5	15.5	

GROUND TERMINAL

- ◆ MATERIAL: NICKEL PLATED BRASS
- ◆ UNIT: mm

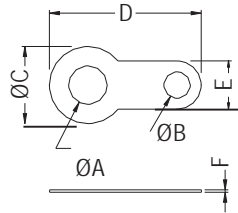

PARTNO	A	B	C	D	E	F	PACKAGE
GND-2	3.2	2.1	6.4	12.6	4.0	0.25	2000
GND-3	4.3	2.0	8.0	17.7	4.6	0.3	
GND-4	5.2	2.1	9.9	19.6	5.1		1000
GND-5	8.3	1.9	10.0	15.0	4.0		
GND-6	9.7	2.0	13.0	21.5	4.0	1000	
GND-10	6.3	2.1	10.0	19.9	5.1	0.3	2000
GND-11	9.0	2.0	13.0	30.0	4.0		1000
GND-17	4.2	1.6	6.8	12.9	3.2	0.4	2000
GND-21	3.7	1.6	6.3	12.6	3.2		
GND-41	3.2	1.5	4.5	12.6	3.0	0.25	
GND-42	2.2	1.5	4.5	12.6	3.0	0.25	

GROUND TERMINAL

- ◆ MATERIAL: TIN PLATED BRASS
- ◆ UNIT: mm

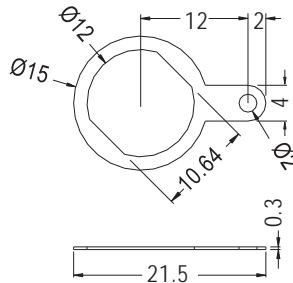

PARTNO	PACKAGE
GND-24	1000

GROUND TERMINAL

- ◆ MATERIAL: PHOSPHOR BRONZE WITH NICKEL PLATED
- ◆ UNIT: mm

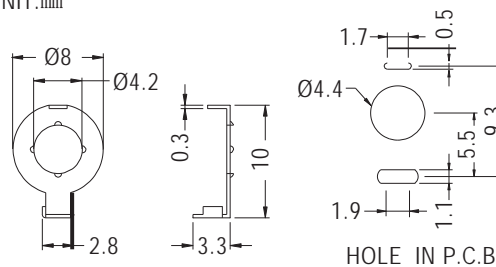

PARTNO	PACKAGE
GND-7	1000

GROUND TERMINAL

- ◆ MATERIAL: TIN PLATED BRASS
- ◆ UNIT: mm

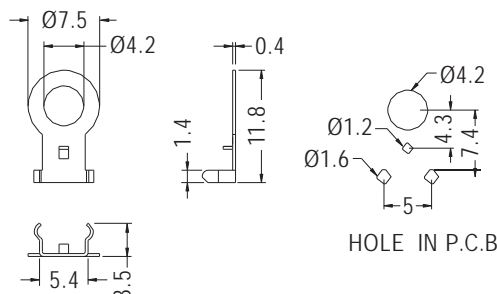

PARTNO	PACKAGE
GND-13	1000



GROUND TERMINAL

- ◆ MATERIAL: NICKEL PLATED BRASS
- ◆ UNIT: mm

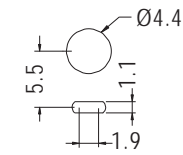
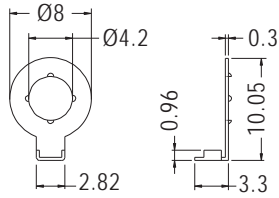

HOLE IN P.C.B

PART NO	PACKAGE
GND-14	1000

GROUND TERMINAL

- ◆ MATERIAL: PHOSPHOR BRONZE TIN PLATED
- ◆ UNIT: mm

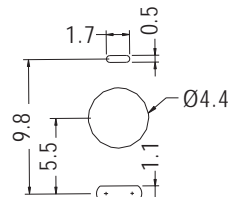
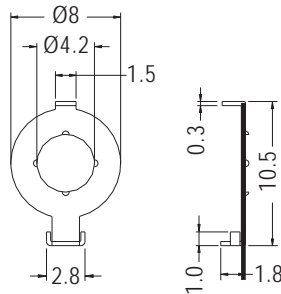

HOLE IN P.C.B

PART NO	PACKAGE
GND-19A	1000

GROUND TERMINAL

- ◆ MATERIAL: TIN PLATED BRASS
- ◆ UNIT: mm

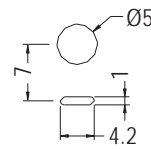
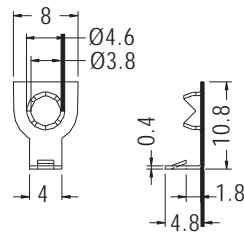

HOLE IN P.C.B

PART NO	PACKAGE
GND-12	1000

GROUND TERMINAL

- ◆ MATERIAL: BRASS WITH TIN PLATED/ NICKEL PLATED
- ◆ UNIT: mm

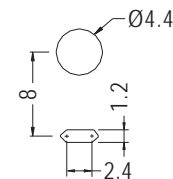
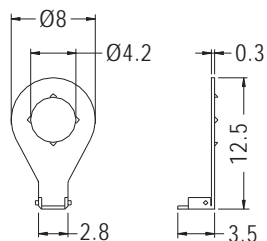

HOLE IN P.C.B

PART NO	PACKAGE
GND-8	1000

GROUND TERMINAL

- ◆ MATERIAL:PHOSPHOR BRONZE
NICKEL PLATED
- ◆ UNIT:mm

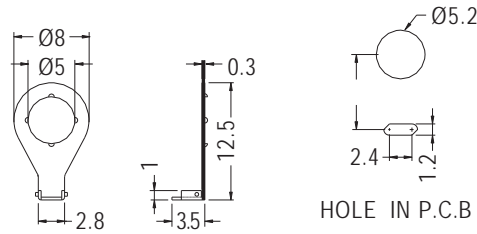

HOLE IN P.C.B

PART NO	PACKAGE
GND-20	2000

GROUND TERMINAL

- ◆ MATERIAL:TIN PLATED BRASS
- ◆ UNIT:mm

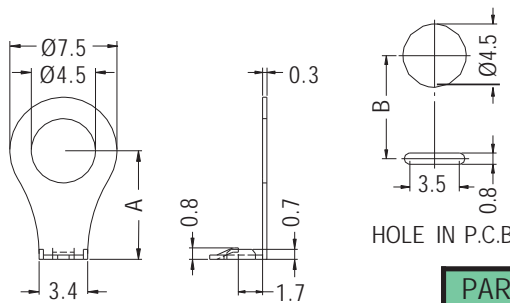

HOLE IN P.C.B

PART NO	A	B	PACKAGE
GND-32	7.9	7.6	1000
GND-51	7.6	7.3	

GROUND TERMINAL

- ◆ MATERIAL:NICKEL PLATED BRASS
- ◆ UNIT:mm

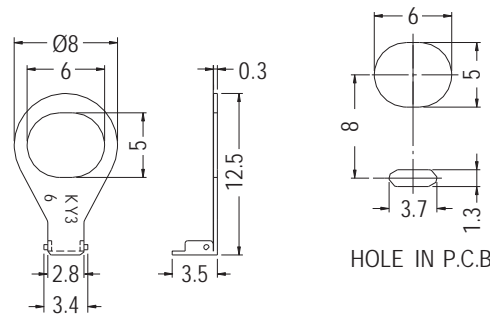

HOLE IN P.C.B

PART NO	PACKAGE
GND-36	1000

GROUND TERMINAL

- ◆ MATERIAL:NICKEL PLATED BRASS
- ◆ UNIT:mm

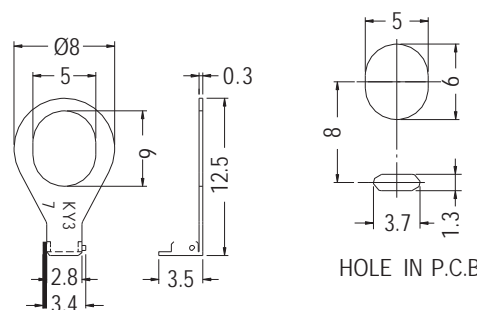

HOLE IN P.C.B

PART NO	PACKAGE
GND-37	1000



GROUND TERMINAL



- ◆ MATERIAL:SPCC
- ◆ FINISH:BRIGHT TIN PLATEDBARSS
- ◆ UNIT:mm

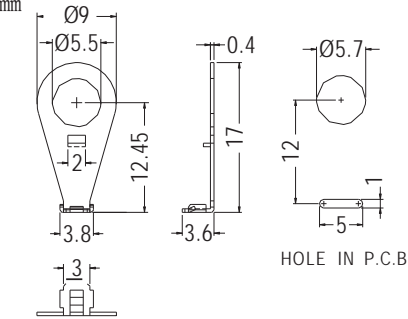

PART NO	PACKAGE
GND-96	1000

GROUND TERMINAL

- ◆ MATERIAL:TIN PLATED BRASS
- ◆ UNIT:mm

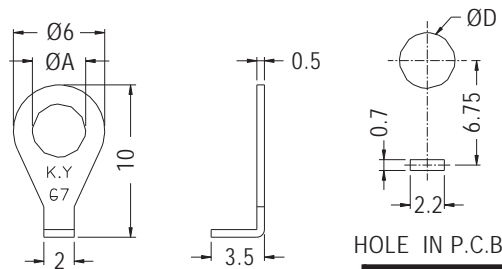

PART NO	A	D	PACKAGE
GND-67	3.5	3.6	1000
GND-67(4.0)	4.0	4.1	

GROUND TERMINAL

- ◆ MATERIAL:TIN PLATED BRASS
- ◆ UNIT:mm

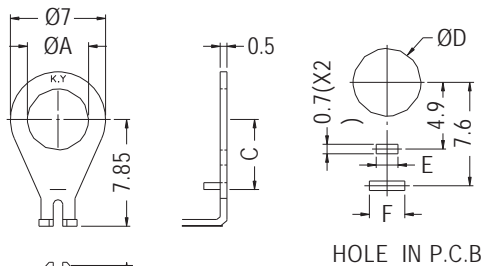

PART NO	A	B	C	D	E	F	PACKAGE
GND-15	3.5	4.6	5.1	4.0	1.5	2.7	2000
GND-35	4.5	4.6	5.1	4.5	1.5	2.7	
GND-39	4.5	3.3	5.15	5.0	1.6	2.6	1000
★ GND-99	4.5	3.3	5.15	5.0	1.6	2.6	

GROUND TERMINAL

- ◆ MATERIAL:TIN PLATED BRASS
- ◆ UNIT:mm

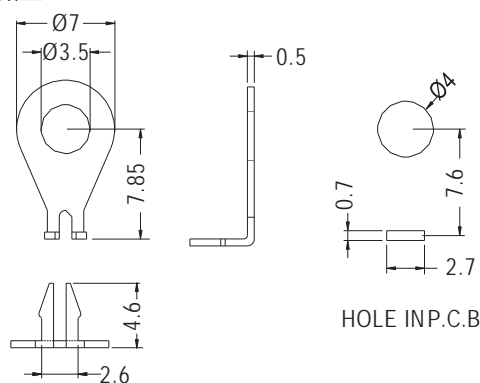

PART NO	PACKAGE
GND-23	2000



GROUND TERMINAL

- ◆ MATERIAL:TIN PLATED SPTE
- ◆ UNIT:mm

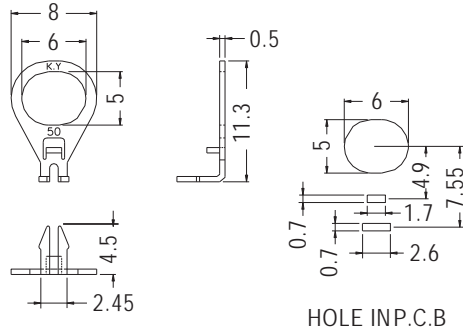

PART NO	PACKAGE
GND-50	1000

- ◆ MATERIAL: TIN PLATED BRASS
- ◆ UNIT:mm

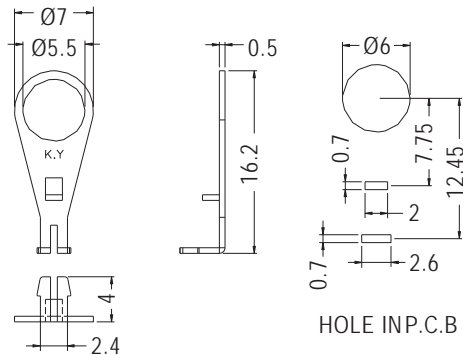

PART NO	PACKAGE
GND-55	1000

GROUND TERMINAL

- ◆ MATERIAL:NICKEL PLATED BRASS
- ◆ UNIT:mm

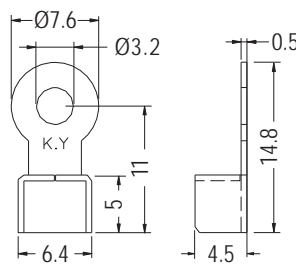

PART NO	PACKAGE
GND-27	1000

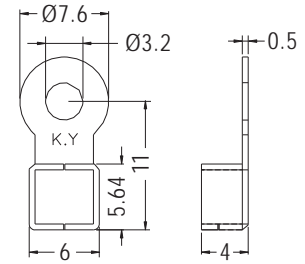

PART NO	PACKAGE
GND-48	1000

GROUND TERMINAL

- ◆ MATERIAL:BRASS
- ◆ FINISH:BRIGHT TIN PLATED
- ◆ UNIT:mm

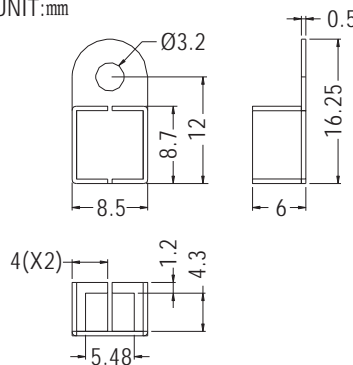

PART NO	PACKAGE
GND-75	1000



GROUND TERMINAL



- ◆ MATERIAL:PHOSPHOR BRONZE
TIN PLATED
- ◆ UNIT:mm

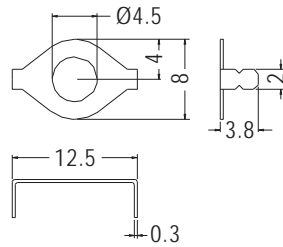

PART NO	PACKAGE
GND-44	1000

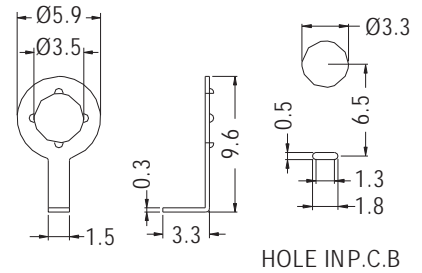

HOLE IN P.C.B

PART NO	PACKAGE
GND-49	1000

- ◆ MATERIAL:PHOSPHOR BRONZE
NICKEL PLATED

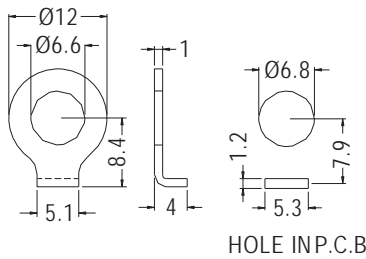

HOLE IN P.C.B

PART NO	PACKAGE
GND-52	1000

- ◆ MATERIAL:TIN PLATED BRASS

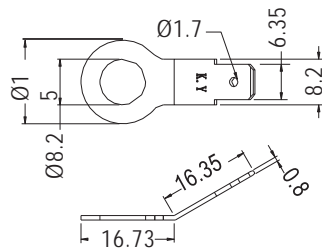

PART NO	PACKAGE
GND-54	1000

- ◆ MATERIAL:TIN PLATED SPCC

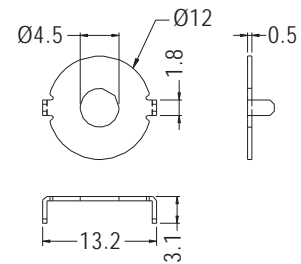

PART NO	PACKAGE
GND-56A	1000

GROUND TERMINAL



- ◆ MATERIAL:PHOSPHOR BRONZE
- ◆ FINISH:TIN PLATED
- ◆ UNIT:mm

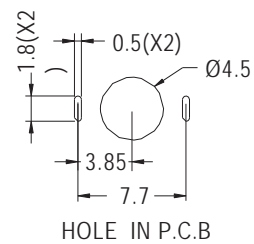
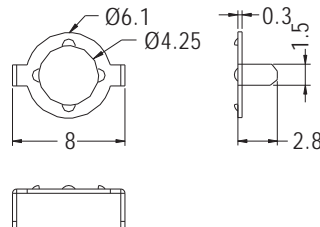

HOLE IN P.C.B

PART NO	PACKAGE
GND-74	1000

GROUND TERMINAL

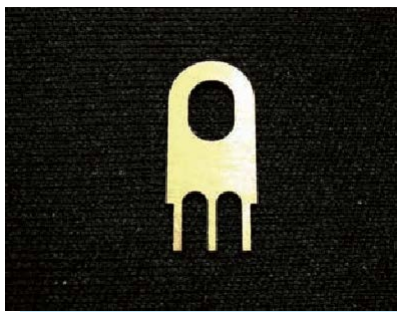

- ◆ MATERIAL:TIN PLATED BRASS
- ◆ UNIT:mm

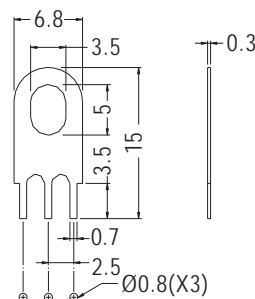

HOLE IN P.C.B

PART NO	PACKAGE
GND-34	1000



TR. CLAMP

◆ MATERIAL: SUS301
◆ UNIT: mm

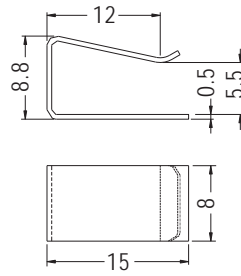

PART NO	PACKAGE
TRMC-7	1000

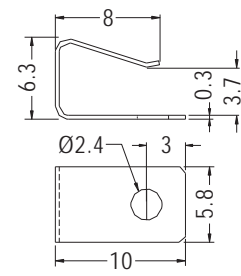

PART NO	PACKAGE
TRMC-20	1000

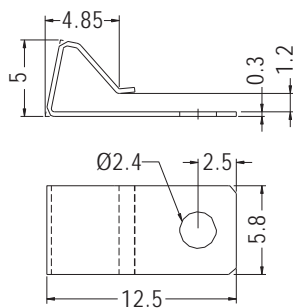

PART NO	PACKAGE
TRMC-23	1000

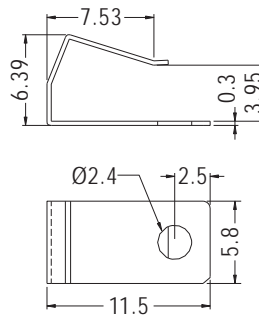

PART NO	PACKAGE
TRMC-26	1000

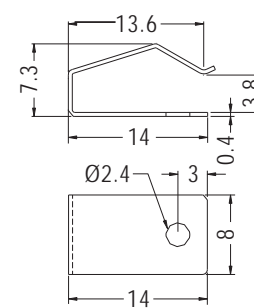

PART NO	PACKAGE
TRMC-34	1000

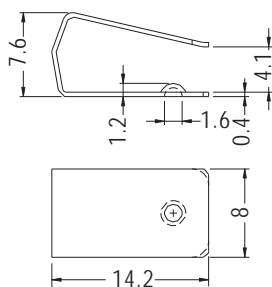

PART NO	PACKAGE
TRMC-35	1000

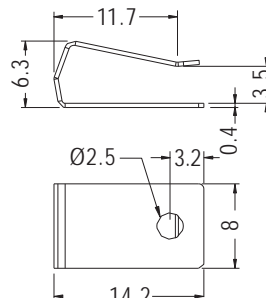

PART NO	PACKAGE
TRMC-40	1000

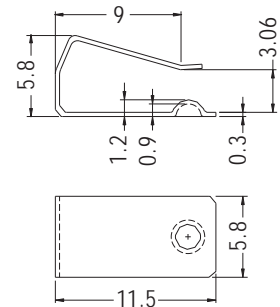

PART NO	PACKAGE
TRMC-49	1000

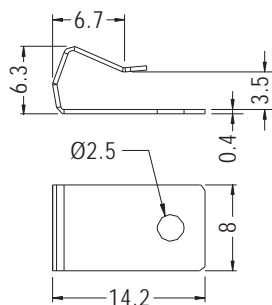

PART NO	PACKAGE
TRMC-59	1000

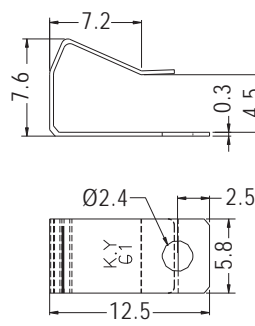

PART NO	PACKAGE
TRMC-61	1000

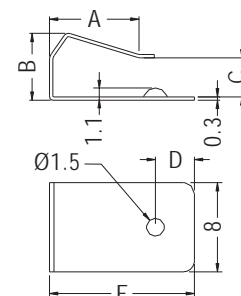

PART NO	A	B	C	D	E	PACKAGE
TRMC-76	8.0	6.1	3.5	3.5	13.0	1000
TRMC-77	6.9	7.5	4.5	4.0	11.0	
TRMC-78	6.9	8.5	5.8	4.0	11.0	



TR. CLAMP

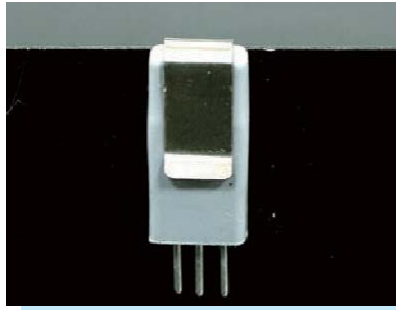

◆ MATERIAL: SUS301
◆ UNIT: mm

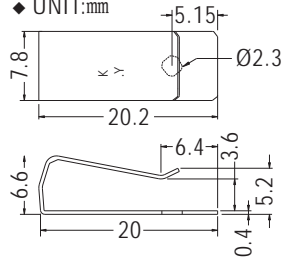

PART NO	PACKAGE
TRMC-9	1000

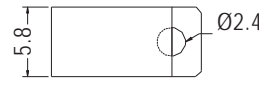

PART NO	PACKAGE
TRMC-17	1000

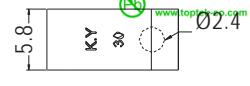

PART NO	PACKAGE
TRMC-30	1000

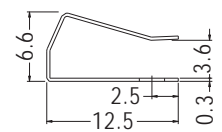
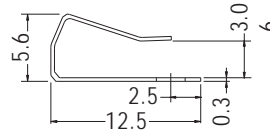

PART NO	PACKAGE
TRMC-1	1000

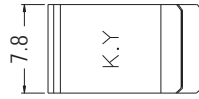
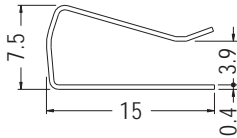

PART NO	PACKAGE
TRMC-2	1000

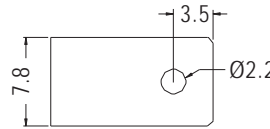
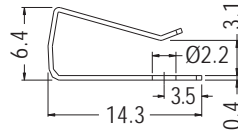

PART NO	PACKAGE
TRMC-5	1000

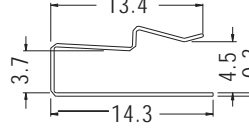

PART NO	PACKAGE
TRMC-6	1000

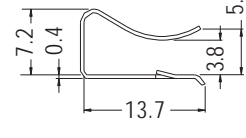

◆ MATERIAL: STAINLESS STEEL

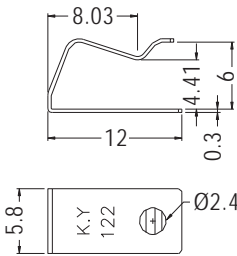

PART NO	PACKAGE
TRMC-122	1000

◆ MATERIAL: STAINLESS STEEL

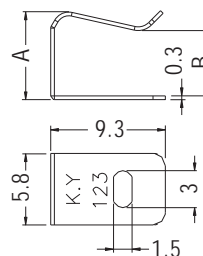

PART NO	A	B	PACKAGE
TRMC-123	7.1	5.3	1000
TRMC-124	7.22	5.35	

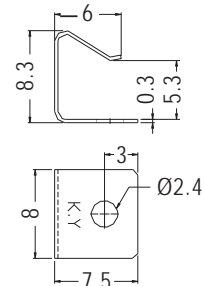

PART NO	PACKAGE
TRMC-141	1000

TRANSISTOR CLIP

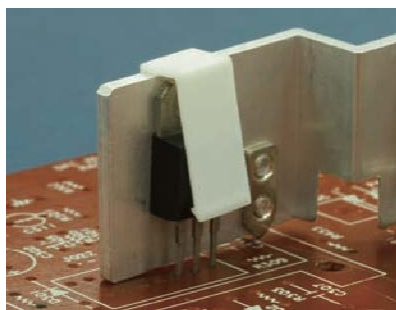

◆ MATERIAL: NYLON 66 (UL)/PBT (UL)
◆ FLAME CLASS: 94V-0
◆ COLOR: NATURAL
◆ UNIT: mm

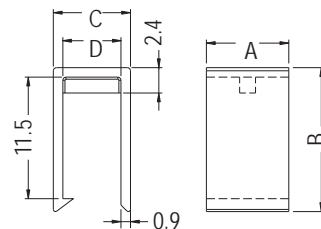

PART NO	A	B	C	D	PACKAGE
TRCMP-1	7.8	13.62	7.3	5.5	1000

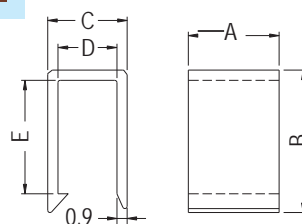

PART NO	A	B	C	D	E	PACKAGE
TRCMP-2	8.0	12.55	7.0	5.2	10.0	1000
TRCMP-5	8.0	12.6	7.5	5.7	10.0	
TRCMP-6	8.0	17.25	6.8	5.0	14.7	



TRANSISTOR CLIP

- ◆ MATERIAL:PBT (UL)
- ◆ FLAME CLASS:94V-0
- ◆ COLOR:NATURAL/BLACK
- ◆ UNIT:mm

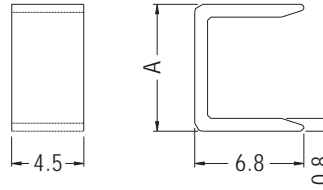

PART NO	A	PACKAGE
TRCMP-3	7.9	1000
TRCMP-4	8.6	

TR. CLAMP

- ◆ MATERIAL:SUS
- ◆ UNIT:mm

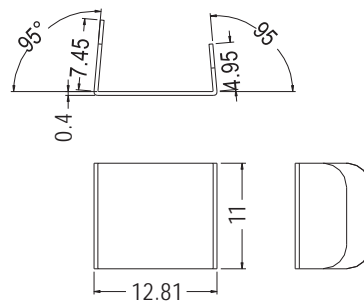
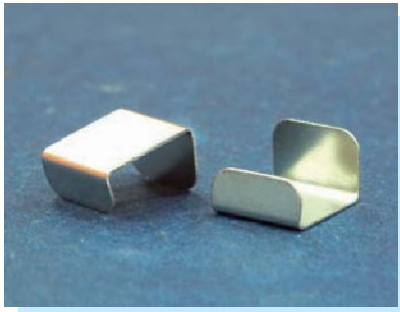

PART NO	PACKAGE
TRMC-135	1000

CLAMP

- ◆ MATERIAL:TIN PLATED BRASS
- ◆ UNIT:mm

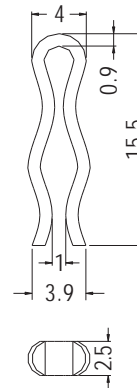

PART NO	PACKAGE
TRMC-53	1000

CLAMP

- ◆ MATERIAL:SK7
- ◆ FINISH:COATING-ZI
- ◆ UNIT:mm

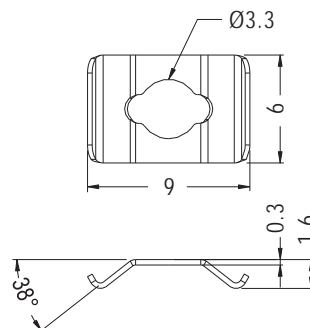

PART NO	PACKAGE
TRMC-68	1000



CLAMP

- ◆ MATERIAL:TIN PLATED SPCC
- ◆ UNIT:mm

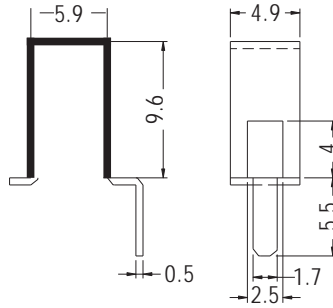
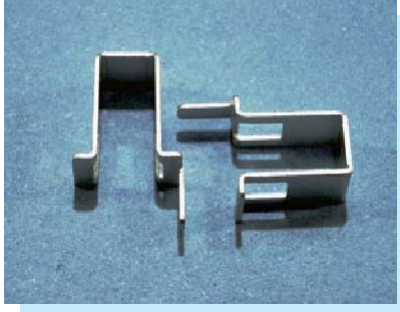

PART NO	PACKAGE
TRMC-10	1000

CLAMP

- ◆ MATERIAL:TIN PLATED PHOSPHOR BRONZE
- ◆ UNIT:mm

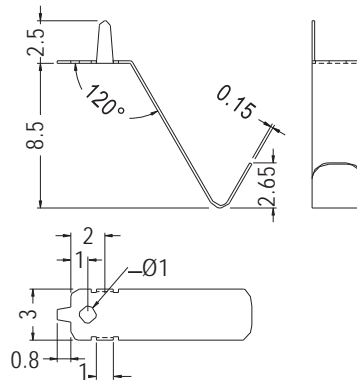
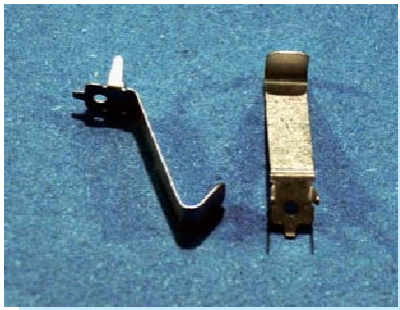

PART NO	PACKAGE
TRMC-11	2000

CLAMP

- ◆ MATERIAL:SUS301
- ◆ UNIT:mm

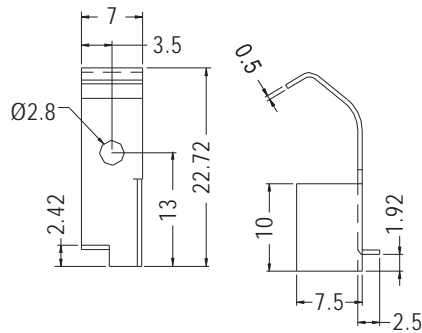
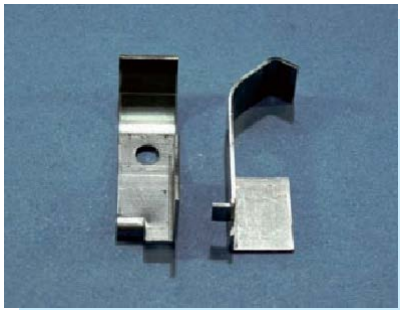

PART NO	PACKAGE
TRMC-12	1000

TR. CLAMP

- ◆ MATERIAL:SUS301
- ◆ UNIT:mm

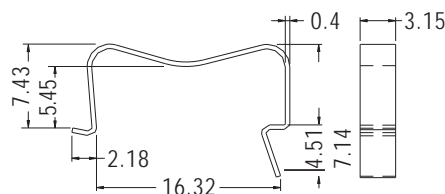
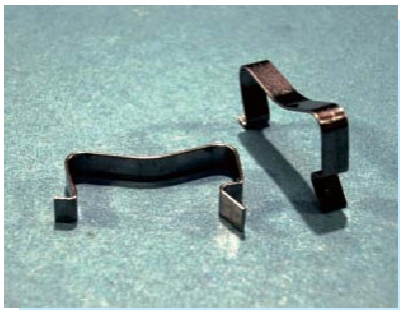

PART NO	PACKAGE
TRMC-8	1000



TR. CLAMP

- ◆ MATERIAL:SUS304
- ◆ UNIT:mm

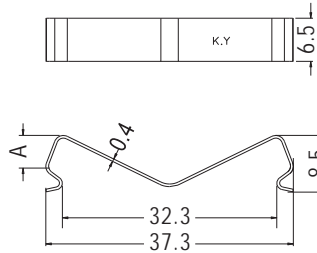

PART NO	A	PACKAGE
TRMC-121	5.0	1000
TRMC-126	4.72	

TR.SHEET CLAMP

- ◆ MATERIAL:SUS304
- ◆ COLOR:SILVER
- ◆ UNIT:mm

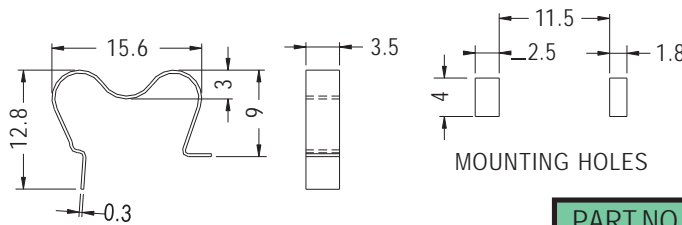
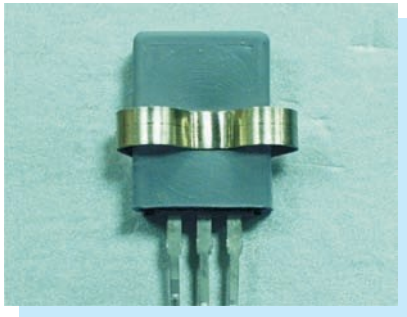

PART NO	PACKAGE
TO-220ST	1000

POSITIVE AA BATTERY CONTACT

- ◆ MATERIAL:SPRING STEEL
- ◆ FINISH:NI PLATED
- ◆ UNIT:mm

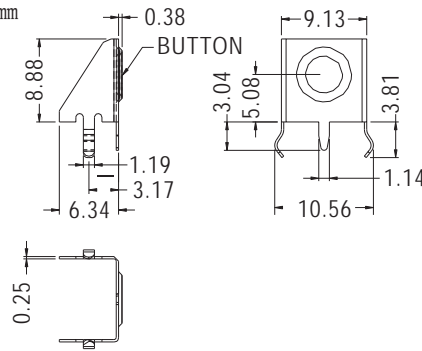
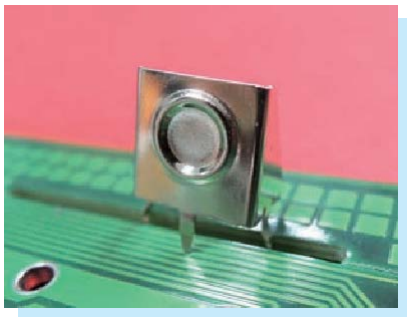

PART NO	PACKAGE
PCB-67	1000

POSITIVE AA BATTERY CONTACT

- ◆ MATERIAL:SPRING STEEL
- ◆ FINISH:NI PLATED
- ◆ UNIT:mm

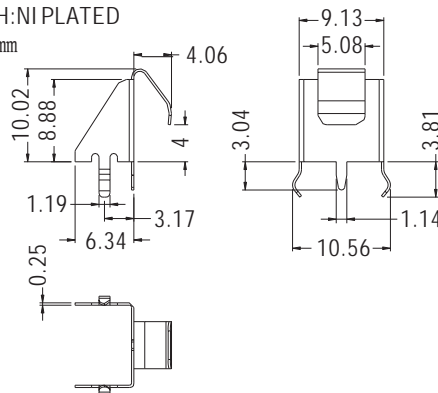
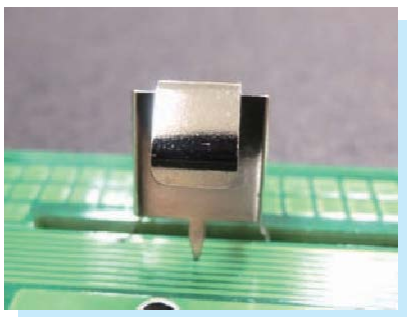

PART NO	PACKAGE
PCB-68	1000



POWER TRANSISTOR CLAMP DEPRESSOR

- ◆ MATERIAL:ZINC PLATED STEEL
- ◆ UNIT:mm

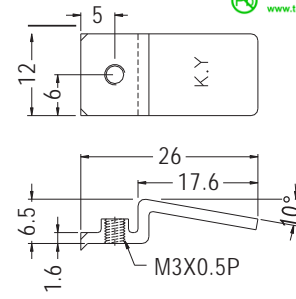
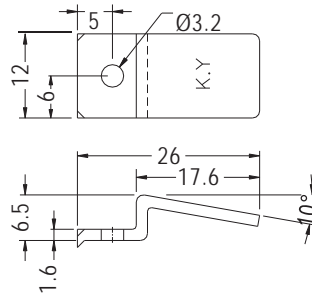

PART NO	PACKAGE
TRK-1	250

PART NO	PACKAGE
TRK-2	250

POWER TRANSISTOR CLAMP DEPRESSOR

- ◆ MATERIAL:STAINLESS-430
- ◆ UNIT:mm

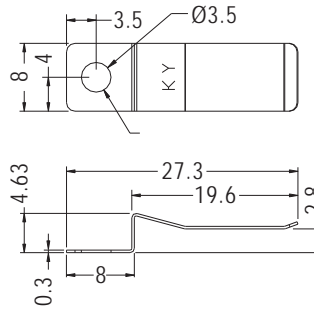

PART NO	PACKAGE
TRK-6	1000

POWER TRANSISTOR CLAMP DEPRESSOR

- ◆ MATERIAL:STEEL
- ◆ UNIT:mm

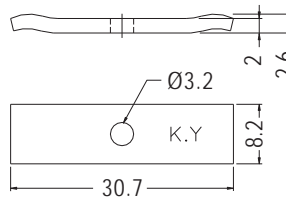
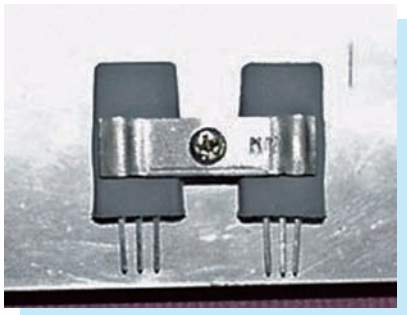

PART NO	PACKAGE
TRK-8	500

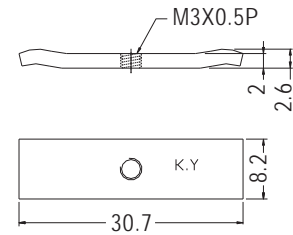

PART NO	PACKAGE
TRK-9	500

POWER TRANSISTOR CLAMP DEPRESSOR

- ◆ MATERIAL:STEEL
- ◆ UNIT:mm

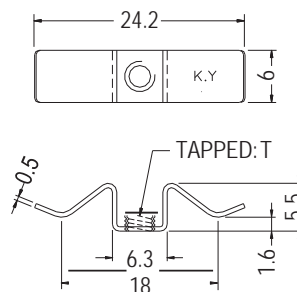
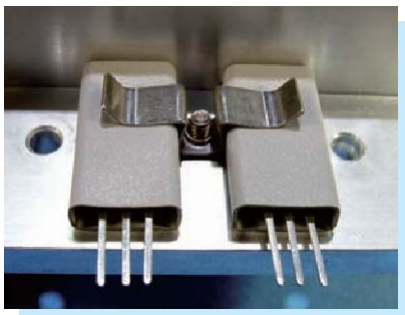

PART NO	T	PACKAGE
TRK-10	M3X0.5P	1000
TRK-10(M4)	M4X0.8P	
TRK-10(632)	6-32 UNC	

POWER TRANSISTOR CLAMP DEPRESSOR

- ◆ MATERIAL: ZINC PLATED SPCC
- ◆ UNIT: mm

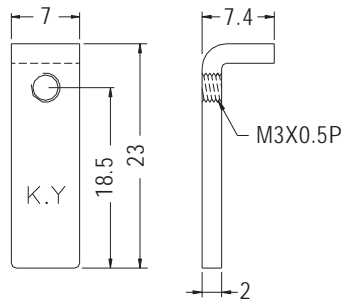
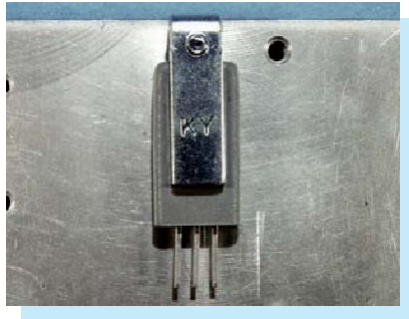

PART NO	PACKAGE
TRK-11	500

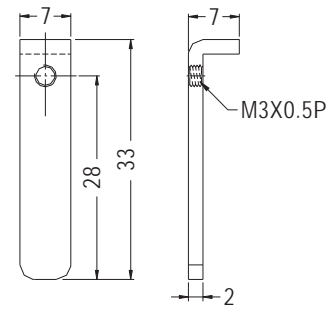

PART NO	PACKAGE
TRK-54	500

10

POWER TRANSISTOR CLAMP DEPRESSOR

- ◆ MATERIAL: ZINC PLATED K5
- ◆ UNIT: mm

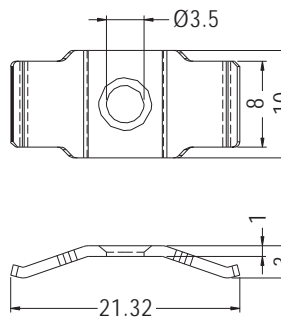

PART NO	PACKAGE
TRK-12	1000

POWER TRANSISTOR CLAMP DEPRESSOR

- ◆ MATERIAL: SUS
- ◆ UNIT: mm

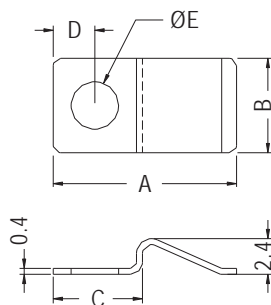

- ◆ MATERIAL: ZINC PLATED STEEL

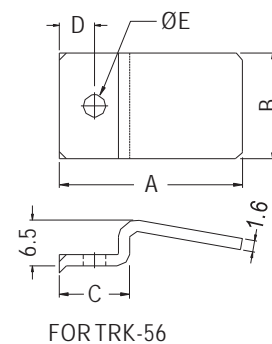

PART NO	A	B	C	D	E	PACKAGE
TRK-24	12.33	6.35	6.0	2.8	3.2	2000
TRK-52	12.73	6.35	6.8	3.2	3.4	
TRK-56	26.0	15.0	10.0	5.0	3.2	1000



POWER TRANSISTOR CLAMP DEPRESSOR

- ◆ MATERIAL:SUS301
- ◆ UNIT:mm

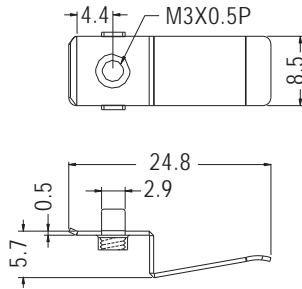

PART NO	PACKAGE
TRK-22	1000

DEPRESSOR

- ◆ MATERIAL:NYLON 66 (UL) 94V-2
- ◆ METAL MATERIAL:SUS
- ◆ COLOR:BLACK
- ◆ UNIT:mm

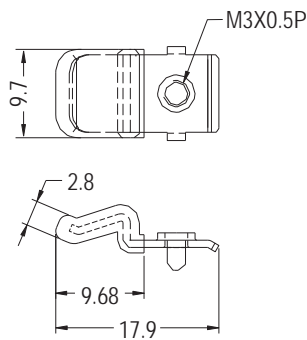

PART NO	PACKAGE
TRK-17AF	1000

DEPRESSOR

- ◆ MATERIAL:NYLON 66 (UL) 94V-2
- ◆ METAL MATERIAL:SUS
- ◆ COLOR:BLACK
- ◆ UNIT:mm

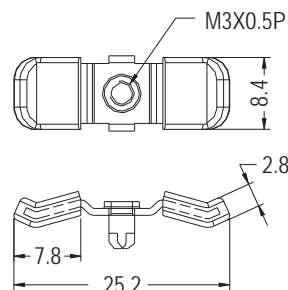

PART NO	PACKAGE
TRK-16F	1000

DAMPER GEAR



- ◆ GEAR MATERIAL:POM (UL) 94HB
- ◆ BODY MATERIAL:PC (UL) 94V-2
- ◆ COLOR:BLACK
- ◆ UNIT:mm

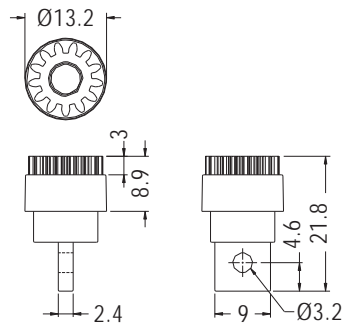

PART NO	PACKAGE
DP023A	500

MODULE	0.8
PITCH CIRCLE DIAMETER	Ø10.4
TEETH NUMBER	13
PRESSURE ANGLE	20°

10

PIN TERMINAL

- ◆ GEAR MATERIAL:POM (UL) 94HB
- ◆ BODY MATERIAL:ABS (UL) 94HB
- ◆ COLOR:BLACK
- ◆ UNIT:mm

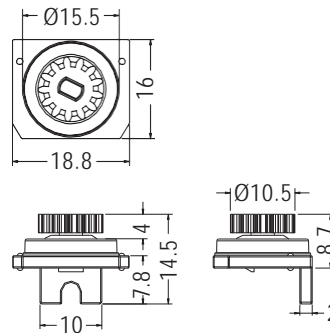

PART NO	PACKAGE
DP016A	500

DP016A MODULE	0.7
PITCH CIRCLE DIAMETER	Ø9.1
TEETH NUMBER	13
PRESSURE ANGLE	20°

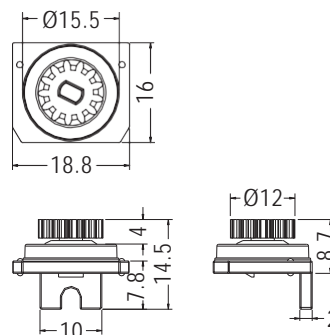

PART NO	PACKAGE
DP019A	500

DP019A MODULE	0.8
PITCH CIRCLE DIAMETER	Ø10.4
TEETH NUMBER	13
PRESSURE ANGLE	20°

DAMPER GEAR

- ◆ GEAR MATERIAL:POM(UL) 94HB
- ◆ BODY MATERIAL:ABS (UL) 94HB
- ◆ COLOR:BLACK
- ◆ UNIT:mm

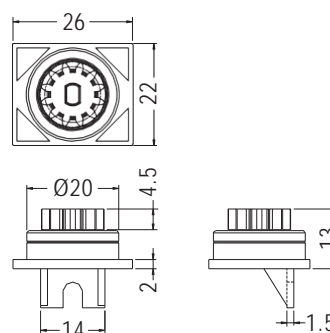

PART NO	PACKAGE
DP028A	500

MODULE	1.0
PITCH CIRCLE DIAMETER	Ø12.0
TEETH NUMBER	12
PRESSURE ANGLE	20°



DAMPER GEAR

- ◆ GEAR MATERIAL:POM (UL) 94HB
- ◆ BODY MATERIAL:ABS (UL) 94HB
- ◆ COLOR:BLACK
- ◆ UNIT:mm

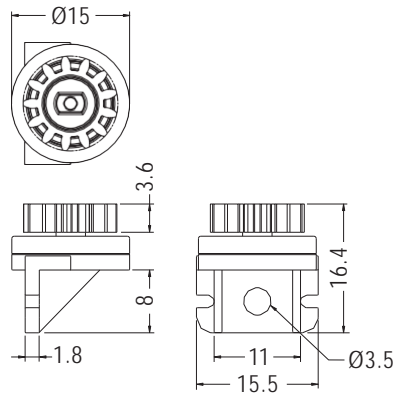

PART NO	PACKAGE
DP025A	500

MODULE	0.8
PITCH CIRCLE DIAMETER	Ø10.4
TEETH NUMBER	13
PRESSURE ANGLE	14.5°

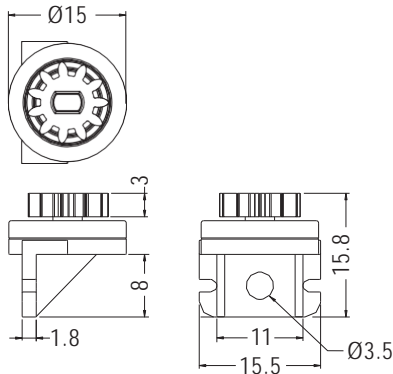

PART NO	PACKAGE
DP026A	500

MODULE	0.8
PITCH CIRCLE DIAMETER	Ø8.8
TEETH NUMBER	11
PRESSURE ANGLE	20°

DAMPER GEAR

- ◆ GEAR MATERIAL:POM (UL) 94HB
- ◆ BODY MATERIAL:ABS (UL) 94HB
- ◆ COLOR:BLACK
- ◆ UNIT:mm

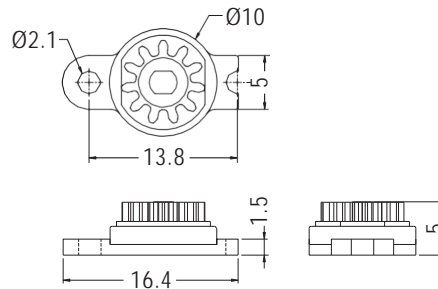

PART NO	PACKAGE
DP006A	500

MODULE	0.6
PITCH CIRCLE DIAMETER	Ø6.6
TEETH NUMBER	11
PRESSURE ANGLE	20°

DAMPER GEAR

NEW

- ◆ GEAR MATERIAL:POM (UL) 94HB
- ◆ BODY MATERIAL:ABS (UL) 94HB
- ◆ COLOR:BLACK
- ◆ UNIT:mm

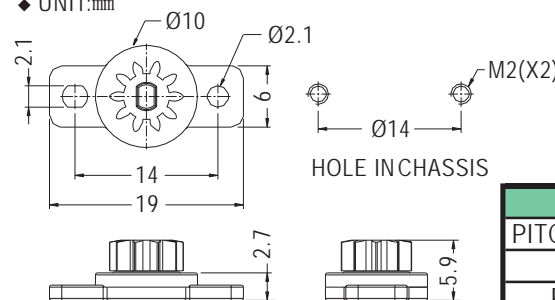

PART NO	PACKAGE
DP030A	500

MODULE	0.6
PITCH CIRCLE DIAMETER	Ø6.0
TEETH NUMBER	10
PRESSURE ANGLE	20°



DAMPER GEAR



- ◆ GEAR MATERIAL:POM (UL) 94HB
- ◆ BODY MATERIAL:ABS (UL) 94HB
- ◆ COLOR:BLACK
- ◆ UNIT:mm

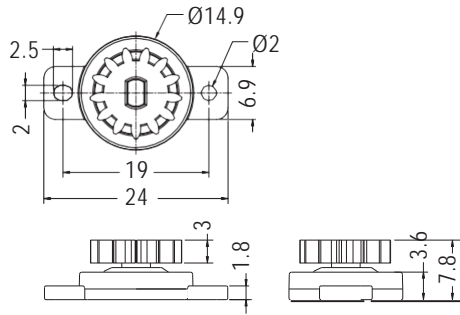

PART NO	PACKAGE
DP008A	500

MODULE	0.8
PITCH CIRCLE DIAMETER	Ø10.4
TEETH NUMBER	13
PRESSURE ANGLE	20°

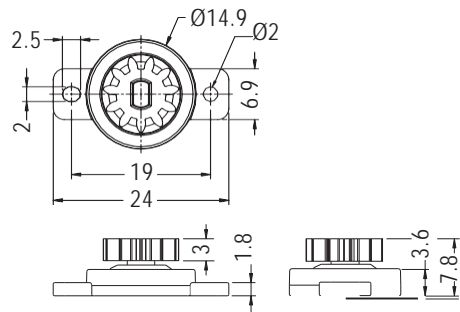

PART NO	PACKAGE
DP018A	500

MODULE	0.8
PITCH CIRCLE DIAMETER	Ø8.8
TEETH NUMBER	11
PRESSURE ANGLE	20°

DAMPER GEAR



- ◆ GEAR MATERIAL:POM (UL) 94HB
- ◆ BODY MATERIAL:ABS (UL) 94HB
- ◆ COLOR:BLACK
- ◆ UNIT:mm

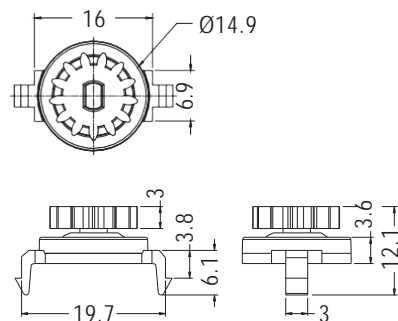

PART NO	PACKAGE
DP007A	500

MODULE	0.8
PITCH CIRCLE DIAMETER	Ø10.4
TEETH NUMBER	13
PRESSURE ANGLE	20°

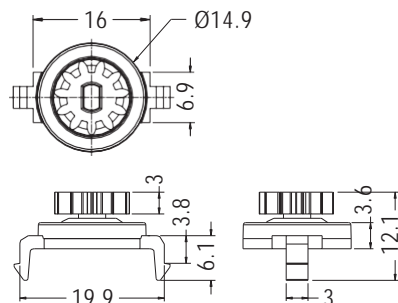

PART NO	PACKAGE
DP017A	500

MODULE	0.8
PITCH CIRCLE DIAMETER	Ø8.8
TEETH NUMBER	11
PRESSURE ANGLE	20°



DAMPER GEAR

- ◆ GEAR MATERIAL:POM(UL) 94HB
- ◆ BODY MATERIAL:ABS (UL) 94HB
- ◆ COLOR:BLACK
- ◆ UNIT:mm

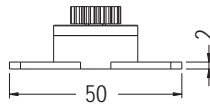
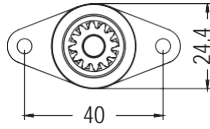

PART NO	PACKAGE
DP010A	500

MODULE	1.0
PITCH CIRCLE DIAMETER	Ø12.0
TEETH NUMBER	12
PRESSURE ANGLE	20°

10

DAMPER GEAR

- ◆ GEAR MATERIAL:POM (UL)94HB
- ◆ BODY MATERIAL:PC (UL) 94V-2
- ◆ COLOR:BLACK
- ◆ UNIT:mm

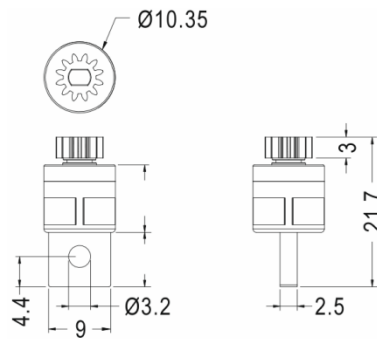

PART NO	PACKAGE
DP013A	500

MODULE	0.5
PITCH CIRCLE DIAMETER	Ø6.0
TEETH NUMBER	12
PRESSURE ANGLE	20°

PLASTIC GEAR

- ◆ MATERIAL:POM
- ◆ COLOR:BLACK
- ◆ UNIT:mm

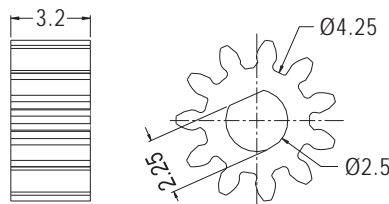

PART NO	PACKAGE
GRAP-1	1000



MINI JUMP



- ◆ HOUSING MATERIAL:PBT
- ◆ TERMINAL MATERIAL:BRASS
FINISH:GOLD PLATED
- ◆ UNIT:mm

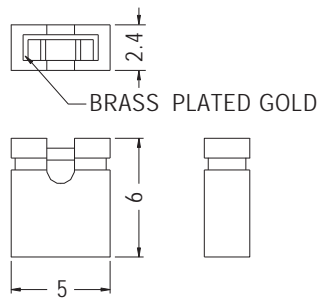

PARTNO	COLOR	PACKAGE
MINI-1	BLACK	1000
MINI-1(R)	RED	
MINI-1(Y)	YELLOW	
MINI-1(G)	GREEN	
MINI-1(BU)	BLUE	

MINI JUMP



- ◆ MATERIAL:NYLON 66(UL)
- ◆ FLAME CLASS:94V-2/94V-0
- ◆ TERMINAL MATERIAL:BRASS
- ◆ UNIT:mm

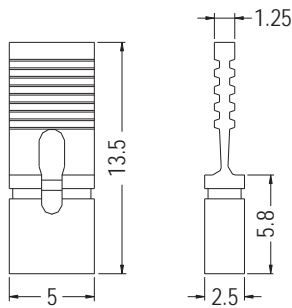

PARTNO	COLOR	PACKAGE
MINI-2(BK)	BLACK	1000
MINI-2(R)	RED	
MINI-2(Y)	YELLOW	
MINI-2(G)	GREEN	
MINI-2(BU)	BLUE	