

## P.C.B TERMINAL

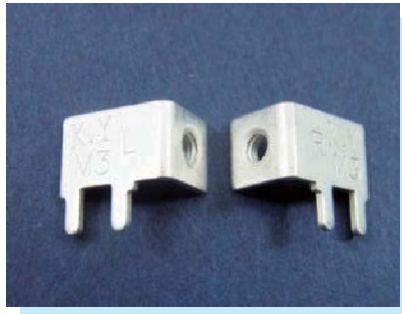

- ◆ MATERIAL:BRASS
- ◆ FINISH:NICKEL PLATED
- ◆ UNIT:mm

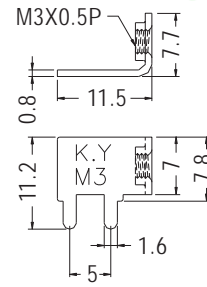
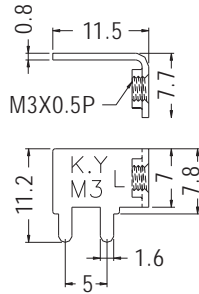

PART NO	PACKAGE
PCB-54L(M3)	1000

PART NO	PACKAGE
PCB-54R(M3)	1000

## P.C.B TERMINAL

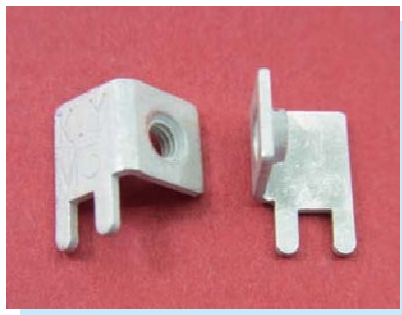

- ◆ MATERIAL:BRASS
- ◆ FINISH:NICKEL PLATED
- ◆ UNIT:mm

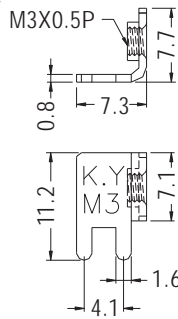

PART NO	PACKAGE
PCB-55(M3)	1000

## P.C.B TERMINAL



- ◆ MATERIAL:TIN PLATED BRASS
- ◆ UNIT:mm

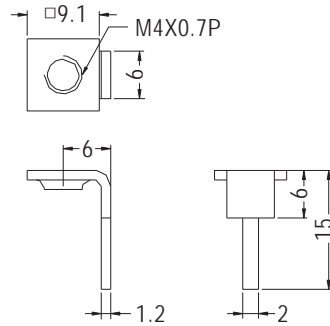

PART NO	PACKAGE
PCB-22(M4)	1000

HOLE IN P.C.B Ø2.5

## P.C.B TERMINAL



- ◆ MATERIAL:TIN PLATED BRASS
- ◆ UNIT:mm

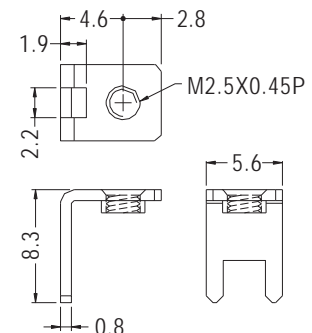
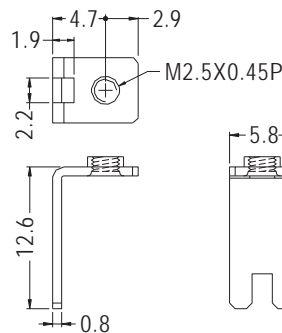

PART NO	PACKAGE
PCB-73	1000

PART NO	PACKAGE
PCB-74	1000