

PUSH-IN WIRE CONNECTOR

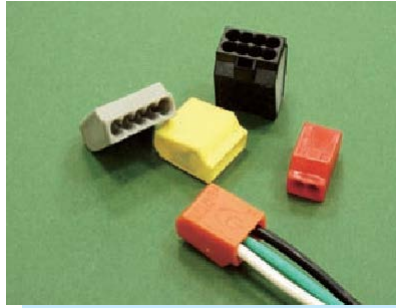

- ◆ MATERIAL:PA 66 (UL) 94V-2
- ◆ UNIT:mm

NOTE:

(Current):24A(VDE)
 (Voltage):600V
 (Working temp): 110C°
 (Wire Range): #12-22 AWG Solid conductor (Stripping Length): 11mm(0.43inch)
 (Color):(UL), (VDE), (Finko), (CE)

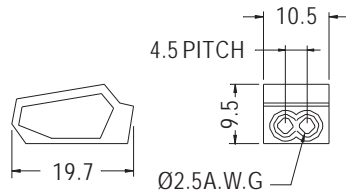

PC252

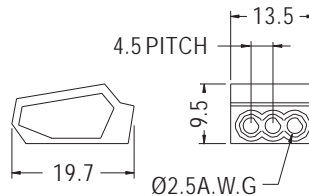

PC253

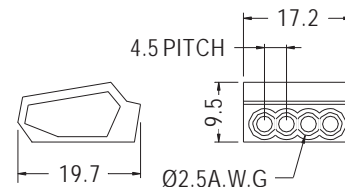

PC254

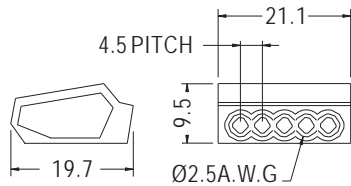

PC255

PART NO	COLOR	POLES	PACKAGE
PC252	RED	2	500
PC253	ORANGE	3	
PC254	YELLOW	4	
PC255	GRAY	5	

CABLE CONNECTOR

- ◆ MATERIAL:NYLON 66
- ◆ COLOR:GRAY
- ◆ UNIT:mm

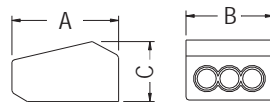

UC-3

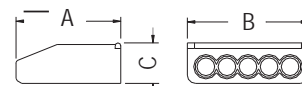

UC-5

PARTNO	A	B	C	SUITABLE ELECTRIC WIRE	THE HIGHEST VOLTAGE,CURRENT	LENGTH STRIPPED WIRE	PACKAGE
UC-3	19.6	13.8	9.7	3X1.2~2mm(d)	380V,27A	10.0~13.0mm	100
UC-5	19.3	21.9	10.1	5X1.2~2mm(d)			

