

SCREW

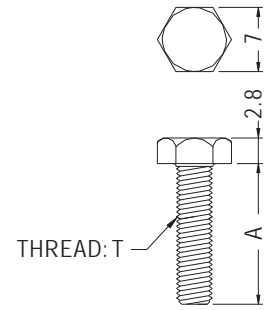

- ◆ MATERIAL: NYLON 66 (UL)
- ◆ FLAME CLASS: 94V-2/94V-0
- ◆ COLOR: NATURAL/BLACK
- ◆ UNIT: mm

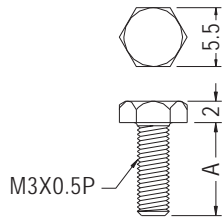

PART NO	A	PACKAGE
STM3-6	6.0	2000
STM3-8	8.0	
STM3-10	10.0	
STM3-12	12.0	

PART NO	A	T	PACKAGE
STM4-6	6.0	M4X0.7P	2000
STM4-8	8.0		
STM4-10	10.0		
STM4-12	12.0		
STM632-6	6.35	6-32 UNC	
STM632-8	8.0		
STM632-9	9.5		
STM632-12	12.7		

SCREW

- ◆ MATERIAL: NYLON 66 (UL)
- ◆ FLAME CLASS: 94V-2/94V-0
- ◆ COLOR: NATURAL/BLACK
- ◆ UNIT: mm

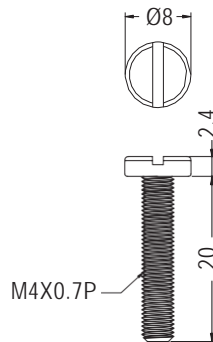

PART NO	PACKAGE
MIL4-20	1000

SCREW

- ◆ MATERIAL: NYLON 66 (UL)
- ◆ FLAME CLASS: 94V-2/94V-0
- ◆ COLOR: NATURAL/BLACK
- ◆ UNIT: mm

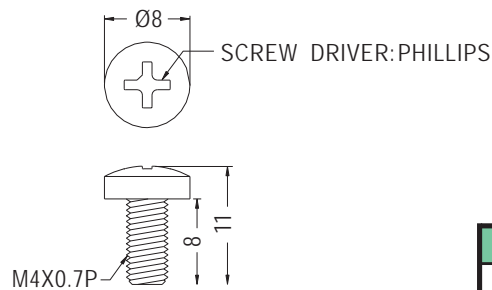

PART NO	PACKAGE
M4-8L	1000

