

FUSE HOLDER

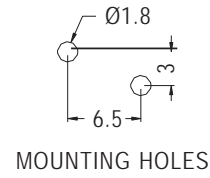

- ◆ MATERIAL:PHOSPHOR BROZNE
- ◆ FINISH:NICKEL PLATED
- ◆ UNIT:mm

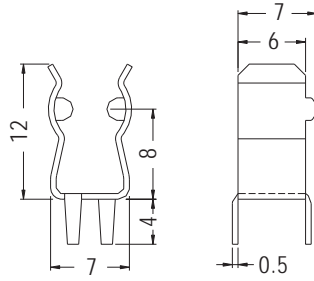

PART NO	PACKAGE
FUC-09	Ø5.2 1000

FUSE HOLDER

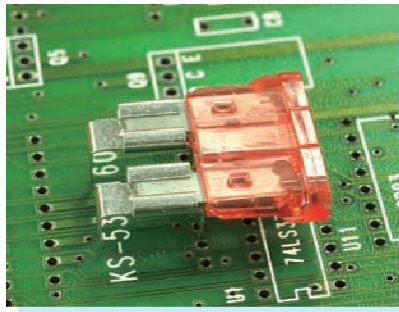

- ◆ MATERIAL:BRASS
- ◆ FINISH:TIN PLATED
- ◆ UNIT:mm

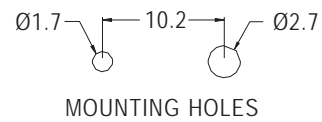
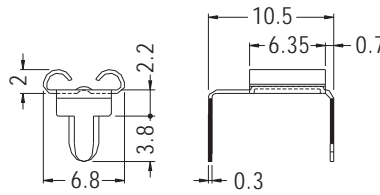

PART NO	PACKAGE
FUC-5A	1000

FUSE HOLDER



- ◆ MATERIAL:NYLON 66 (UL)
- ◆ FLAME CLASS:94V-2/94V-0
- ◆ COLOR:BLACK
- ◆ UNIT:mm

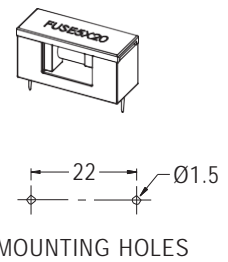
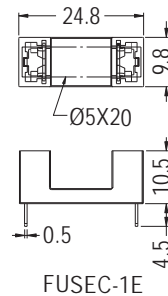
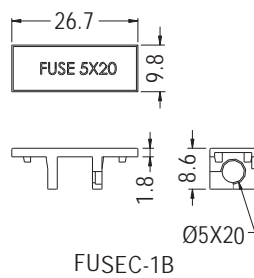

PART NO	PACKAGE
FUSEC-1	500

FUSE HOLDER

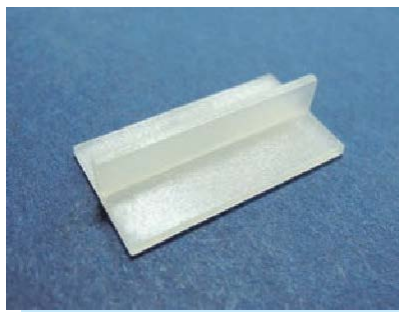

- ◆ MATERIAL:PC (UL)
- ◆ FLAME CLASS:94V-2/94V-0
- ◆ COLOR:NATURAL
- ◆ UNIT:mm

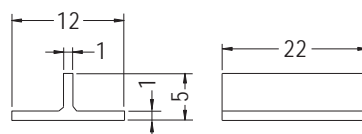

PART NO	PACKAGE
FHBBU-22	1000