

HANDLE

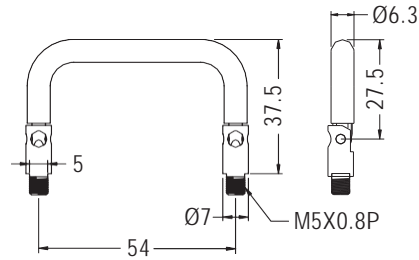

- ◆ BODY MATERIAL: NYLON 66 (UL)
- ◆ FLAME CLASS: 94V-2/94V-0
- ◆ SCREW MATERIAL: STEEL
- ◆ COLOR: BLACK
- ◆ UNIT: mm



| PART NO | PACKAGE |
|----------|---------|
| HANUL-2F | 100 |

HANDLE



- ◆ BODY MATERIAL: NYLON 66 (UL)
- ◆ FLAME CLASS: 94V-2/94V-0
- ◆ SCREW MATERIAL: STEEL
- ◆ COLOR: BLACK
- ◆ UNIT: mm

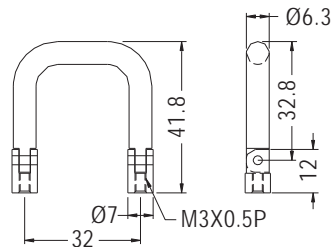

| PART NO | PACKAGE |
|-----------|---------|
| HANUL-3NF | 100 |

HANDLE



- ◆ MATERIAL: PC (UL)
- ◆ FLAME CLASS: 94V-2
- ◆ COLOR: BLACK
- ◆ UNIT: mm

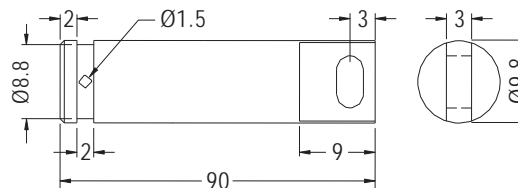

| PART NO | PACKAGE |
|---------|---------|
| HANI-90 | 100 |

HANDLE



- ◆ MATERIAL: PC+ABS (UL)
- ◆ FLAME CLASS: 94V-0
- ◆ COLOR: BLACK
- ◆ UNIT: mm

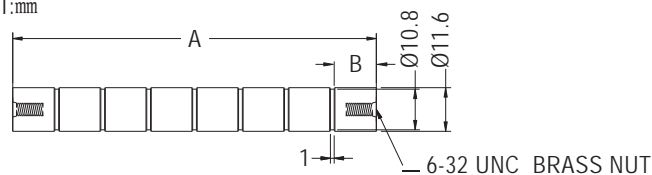

| PART NO | A | B | PACKAGE |
|----------|-------|-------|---------|
| HANI-96 | 97.0 | 11.4 | 100 |
| HANI-119 | 118.7 | 10.05 | 50 |

