

SQUARE SNAP BUSHING

- ◆ MATERIAL: NYLON 66 (UL)
- ◆ FLAME CLASS: 94V-2/94V-0
- ◆ COLOR: NATURAL/BLACK
- ◆ UNIT: mm

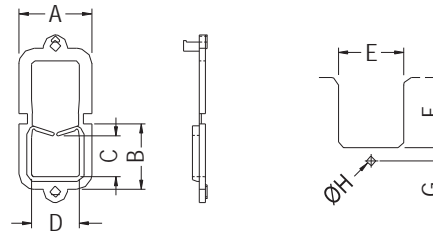

MOUNTING HOLE THICKNESS: T

PARTNO	A	B	C	D	E	F	G	H	T	PACKAGE
SQB-1	18.4	14.5	8.9	11.0	14.0	12.3	2.7	2.7	0.8~2.0	500
SQB-2	21.5	18.8	11.9	13.9	17.2	18.5	3.5	3.0		

SQUARE SNAP BUSHING

- ◆ MATERIAL: NYLON 66 (UL)
- ◆ FLAME CLASS: 94V-2/94V-0
- ◆ COLOR: NATURAL/BLACK
- ◆ UNIT: mm

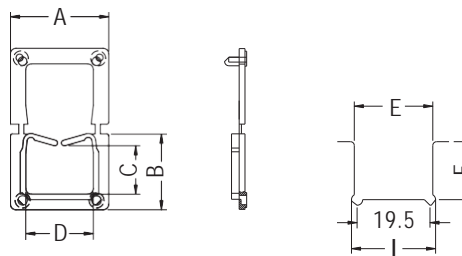

MOUNTING HOLE THICKNESS: T

PARTNO	A	B	C	D	E	F	I	T	PACKAGE
SQB-3	26.0	20.2	12.9	17.9	21.0	15.5	22.5	0.8~2.0	500

SQUARE SNAP BUSHING

- ◆ MATERIAL: NYLON 66 (UL)
- ◆ FLAME CLASS: 94V-2/94V-0
- ◆ COLOR: NATURAL/BLACK
- ◆ UNIT: mm

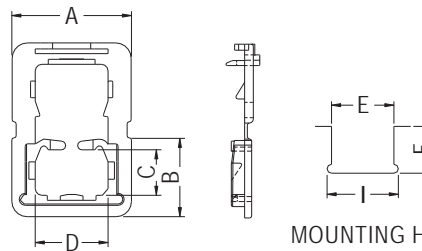
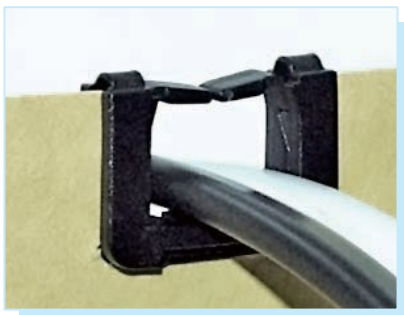

MOUNTING HOLE THICKNESS: T

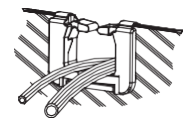

UNIT FOLDED VIEW

PARTNO	A	B	C	D	E	F	I	T	PACKAGE
SQB-4	22.0	14.2	9.0	14.0	17.0	13.5	19.0	0.8~2.0	500
SQB-5	17.9	11.8	6.8	10.9	14.0	10.5	16.0		100

