

WIRE MOUNT

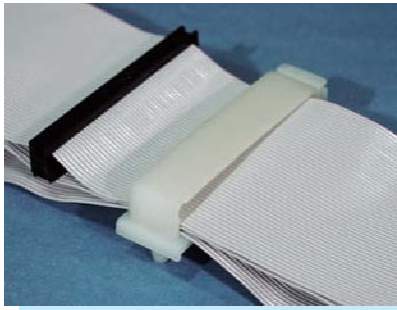

- ◆ MATERIAL: NYLON 66 (UL)
- ◆ FLAME CLASS: 94V-2/94V-0
- ◆ COLOR: NATURAL/BLACK
- ◆ UNIT: mm

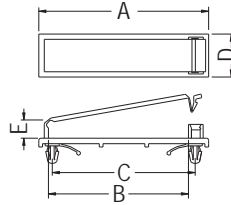

CHASSIS: ØG
THICKNESS: T

PART NO	A	B	C	D	E	G	T	PACKAGE
FCT-1	77.4	64.0	64.5	19.6	7.8	4.8	0.8~2.2	100
FCT-1L	77.0	64.0	64.5	20.0	12.9	4.8	0.8~2.2	

WIRE MOUNT



- ◆ MATERIAL: NYLON 66 (UL)
- ◆ FLAME CLASS: 94V-2/94V-0
- ◆ COLOR: NATURAL/BLACK
- ◆ UNIT: mm

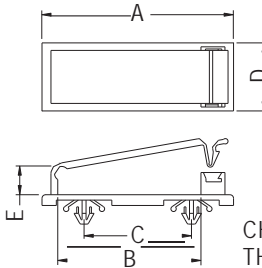

CHASSIS: ØG
THICKNESS: T

PART NO	A	B	C	D	E	G	T	PACKAGE
FCT-2	53.8	40.0	30.0	19.0	8.9	4.0	0.8~2.2	100
FCT-3	45.8	32.0	25.0	19.0	8.9	4.0	0.8~2.2	

WIRE MOUNT



- ◆ MATERIAL: NYLON 66 (UL)
- ◆ FLAME CLASS: 94V-2/94V-0
- ◆ COLOR: NATURAL/BLACK
- ◆ UNIT: mm

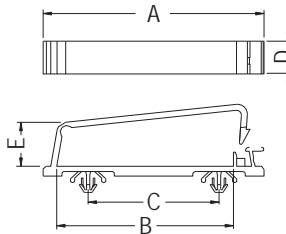

40 ØG
MOUNTING HOLES
THICKNESS: T

PART NO	A	B	C	D	E	G	T	PACKAGE
FCT-4	67.5	54.0	40.0	10.0	13.2	4.0	2.0	100
FCT-4S	67.5	54.0	40.0	10.0	13.2	4.0	0.8~1.0	
FCT-4M	67.5	54.0	40.0	10.0	13.2	4.0	0.8~2.0	

WIRE MOUNT



- ◆ MATERIAL: NYLON 66 (UL)
- ◆ FLAME CLASS: 94V-2/94V-0
- ◆ COLOR: NATURAL/BLACK
- ◆ UNIT: mm

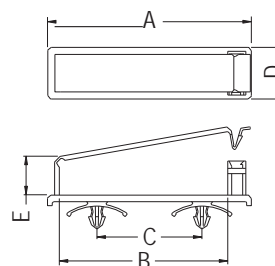

40 ØG
MOUNTING HOLES
THICKNESS: T

PART NO	A	B	C	D	E	G	T	PACKAGE
FCT-5	77.7	64.2	40.0	19.7	14.8	4.8	0.8~3.2	100

