

WIRE MOUNT

- ◆ MATERIAL:NYLON 66 (UL)
- ◆ FLAME CLASS:94V-2/94V-0
- ◆ COLOR:NATURAL/BLACK
- ◆ UNIT:mm

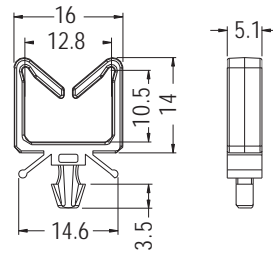
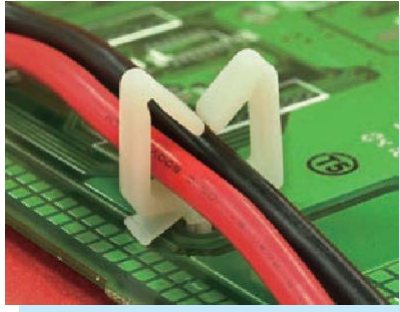

MOUNTING HOLE Ø3.4-Ø3.5
THICKNESS 2.5 MAX.

PART NO	PACKAGE
CHPB-1	1000

WIRE MOUNT

- ◆ MATERIAL:NYLON 66 (UL)
- ◆ FLAME CLASS:94V-2/94V-0
- ◆ COLOR:NATURAL/BLACK
- ◆ UNIT:mm

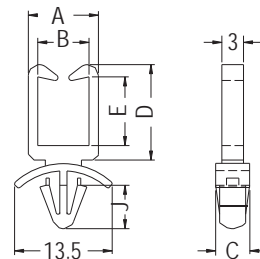
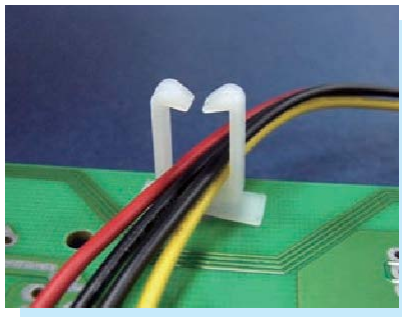

CHASSIS: ØG
THICKNESS: T

PART NO	A	B	C	D	E	G	J	T	PACKAGE
CHAD-1	9.7	7.1	4.7	13.2	9.5	4.8	6.0	0.8~1.6	1000

WIRE MOUNT

- ◆ MATERIAL:NYLON 66 (UL)
- ◆ FLAME CLASS:94V-2/94V-0
- ◆ COLOR:NATURAL/BLACK
- ◆ UNIT:mm

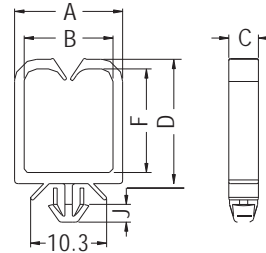
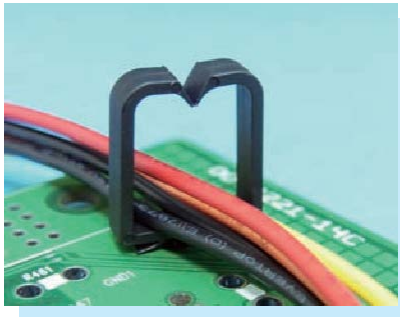

CHASSIS: ØG
THICKNESS: T

PART NO	A	B	C	D	F	G	J	T	PACKAGE
MWS-34	14.6	12.0	4.0	16.8	14.0	4.0	2.4	0.8~2.0	500

WIRE MOUNT

- ◆ MATERIAL:NYLON 66 (UL)
- ◆ FLAME CLASS:94V-2/94V-0
- ◆ COLOR:NATURAL/BLACK
- ◆ UNIT:mm

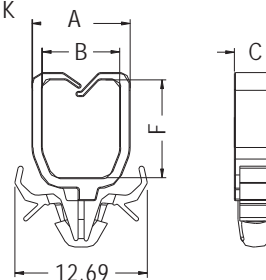
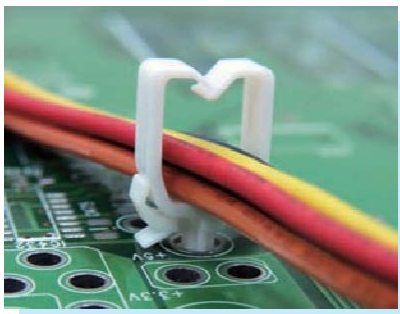

P.C.B: ØG
THICKNESS: T

PART NO	A	B	C	F	G	T	PACKAGE
MWSB-1	9.4	7.4	4.04	9.37	3.5	0.6~1.6	2000

