

# WIRE MOUNT

- ◆ MATERIAL: NYLON 66 (UL)
- ◆ FLAME CLASS: 94V-2/94V-0
- ◆ COLOR: NATURAL/BLACK
- ◆ UNIT: mm

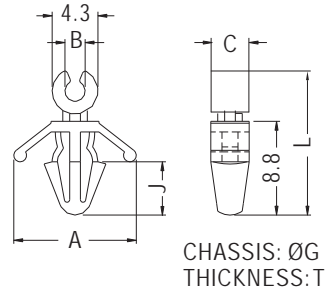

PART NO	A	B	C	G	J	L	T	PACKAGE
THV-11	11.5	1.9	3.6	4.0	5.0	13.5	0.8~2.5	1000

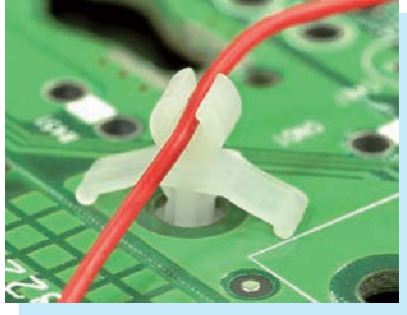
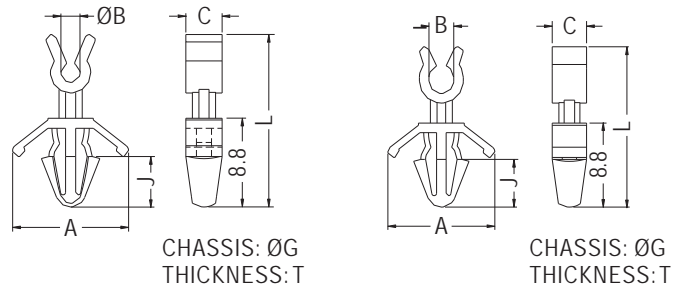

FOR THV-3, THV-4

PART NO	A	B	C	G	J	L	T	PACKAGE
THV-1	11.5	1.9	3.6	4.0	5.0	17.1	0.8~2.5	500
THV-7	11.5	1.9	3.6	4.0	5.0	25.1	0.8~2.5	
THV-3	11.2	2.6	3.6	4.0	5.0	16.8	0.8~2.5	
THV-4	11.2	2.6	3.6	4.0	5.0	20.7	0.8~2.5	

# WIRE MOUNT

- ◆ MATERIAL: NYLON 66 (UL)
- ◆ FLAME CLASS: 94V-2/94V-0
- ◆ COLOR: NATURAL/BLACK
- ◆ UNIT: mm

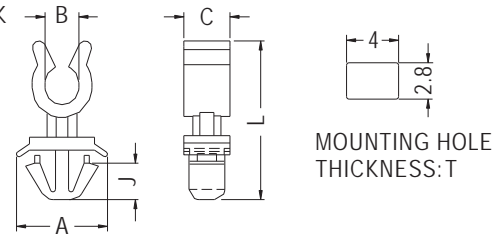

PART NO	A	B	C	J	L	T	PACKAGE
THV-5	7.0	2.6	3.6	5.0	12.4	0.6	500

# WIRE MOUNT

- ◆ MATERIAL: NYLON 66 (UL)
- ◆ FLAME CLASS: 94V-2/94V-0
- ◆ COLOR: NATURAL/BLACK
- ◆ UNIT: mm

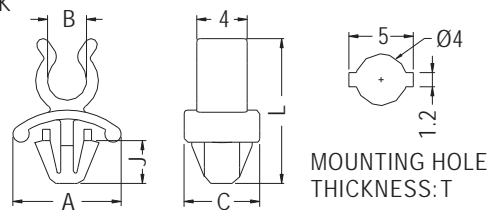

PART NO	A	B	C	J	L	T	PACKAGE
THV-6	8.6	3.3	6.0	3.4	11.6	0.8~1.2	1000

