

LED HOLDER

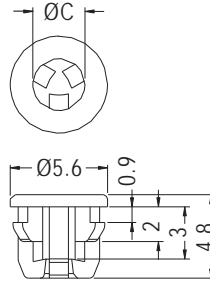

- ◆ MATERIAL: NYLON 66 (UL)
- ◆ FLAME CLASS: 94V-2/94V-0
- ◆ COLOR: BLACK
- ◆ UNIT: mm



MOUNTING HOLE Ø5.0
CHASSIS THICKNESS 0.8

PART NO	C	PACKAGE
LED3-37	3.0	2000
LED3-38	2.8	

LED HOLDER



- ◆ MATERIAL: NYLON 66 (UL)
- ◆ FLAME CLASS: 94V-2/94V-0
- ◆ COLOR: BLACK
- ◆ UNIT: mm

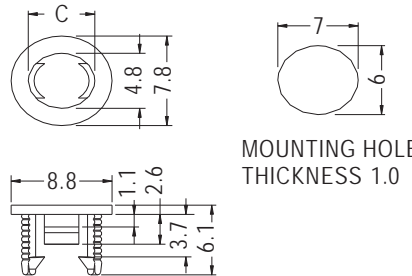

MOUNTING HOLE THICKNESS 1.0

PART NO	C	PACKAGE
LED5-6	5.8	2000

LED HOLDER



- ◆ MATERIAL: NYLON 66 (UL)
- ◆ FLAME CLASS: 94V-2/94V-0
- ◆ COLOR: BLACK
- ◆ UNIT: mm

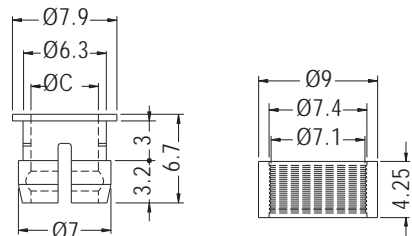

FOR LED5-2A
CHASSIS Ø6.4
THICKNESS 3.0

FOR LED5-2B

PART NO	C	PACKAGE
LED5-2	5.1	1000

LED HOLDER

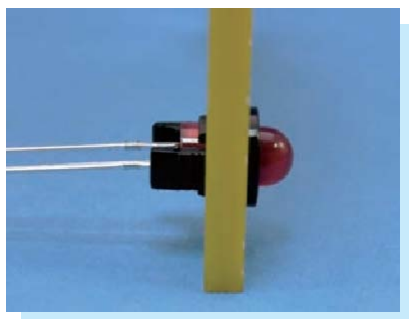

- ◆ MATERIAL: NYLON 66 (UL)
- ◆ FLAME CLASS: 94V-2/94V-0
- ◆ COLOR: BLACK
- ◆ UNIT: mm



CHASSIS Ø6.35

CHASSIS Ø7.0
THICKNESS: E

PART NO	C	PACKAGE
LED5-8	5.0	2000

PART NO	A	C	E	PACKAGE
LED5-9	1.5	5.1	0.8~1.4	1000
LED5-9S	1.0	5.1	0.8	

