

# SPACER SUPPORT

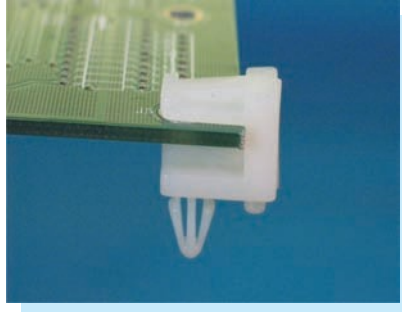

MATERIAL: NYLON 66 (UL)  
FLAME CLASS: 94V-2/94V-0  
COLOR: NATURAL/BLACK  
UNIT:

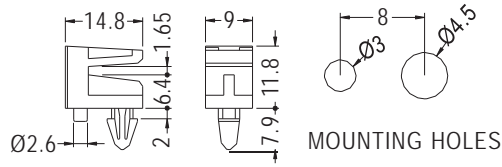

PART NO	PACKAGE
UB-6D	1000

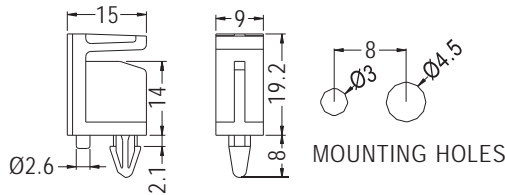

PART NO	PACKAGE
UB-14D	1000

# SPACER SUPPORT

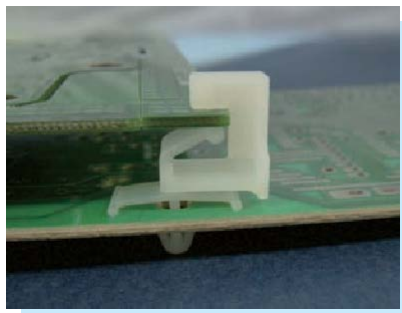

MATERIAL: NYLON 66 (UL)  
FLAME CLASS: 94V-2/94V-0  
COLOR: NATURAL/BLACK  
UNIT:

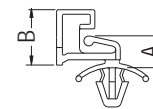
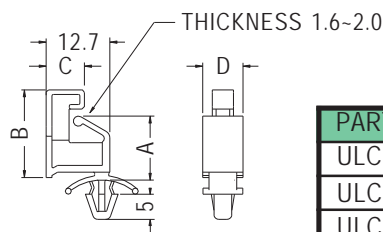

FOR ULCF-6~ULCF-8S

PART NO	A	B	C	D	PACKAGE
ULCF-6	6.3	11.0	9.0	8.0	1000
ULCF-8	8.0	12.7	9.0	8.0	
ULCF-8S	8.0	12.7	7.6	6.0	
ULCF-9	9.5	14.2	9.0	8.0	
ULCF-12	12.7	17.4	9.0	8.0	
ULCF-16	15.9	20.6	9.0	8.0	

# SPACER SUPPORT

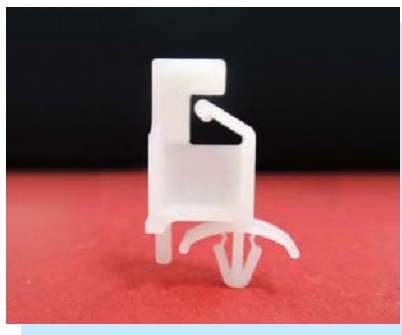

MATERIAL: NYLON 66 (UL)  
FLAME CLASS: 94V-2/94V-0  
COLOR: NATURAL/BLACK  
UNIT:

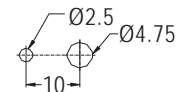
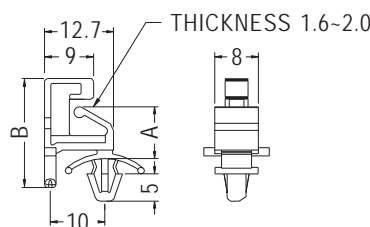

MOUNTING HOLES

PART NO	A	B	PACKAGE
WLCF-6	6.3	16.8	1000
WLCF-8	8.0	18.5	
WLCF-9	9.5	20.0	
WLCF-12	12.7	23.2	
WLCF-16	15.9	26.4	

# SPACER SUPPORT

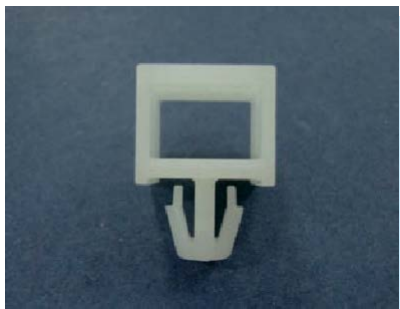

MATERIAL: NYLON 66 (UL)  
FLAME CLASS: 94V-2/94V-0  
COLOR: NATURAL/BLACK  
UNIT:

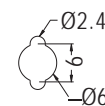
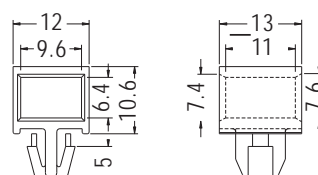

MOUNTING HOLE  
THICKNESS: E

PART NO	E	PACKAGE
LDD-10	1.6~1.8	500
LDD-10(2)	1.8~2.0	