

SPACER SUPPORT

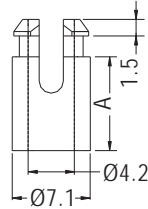

- ◆ MATERIAL: NYLON 66 (UL)
- ◆ FLAME CLASS: 94V-2/94V-0
- ◆ COLOR: NATURAL/BLACK
- ◆ UNIT: mm

P.C.B Ø5.9
THICKNESS 1.2~1.7



FOR M3.5 OR M4 SCREW

PART NO	A	PACKAGE
SS4-3	3.0	1000
SS4-4	4.0	
SS4-4.6	4.6	
SS4-5	5.0	
SS4-6	6.4	
SS4-8	7.9	
SS4-9	9.5	
SS4-11	11.1	
SS4-12S	12.0	
SS4-12	12.7	
SS4-16	15.9	
SS4-17	17.0	
SS4-19	19.1	
SS4-22	22.2	
SS4-25	25.4	
SS4-30	30.0	

1

SPACER SUPPORT

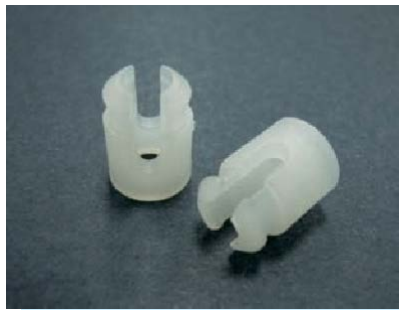

- ◆ MATERIAL: NYLON 66 (UL)
- ◆ FLAME CLASS: 94V-2/94V-0
- ◆ COLOR: NATURAL/BLACK
- ◆ UNIT: mm

P.C.B Ø5.9
THICKNESS 1.2~1.7

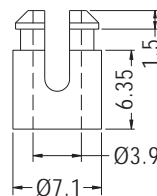

PART NO	PACKAGE
SSU4-6.3	1000

SPACER SUPPORT



- ◆ MATERIAL: NYLON 66 (UL)
- ◆ FLAME CLASS: 94V-2/94V-0
- ◆ COLOR: NATURAL/BLACK
- ◆ UNIT: mm

P.C.B Ø5.9
THICKNESS 1.8

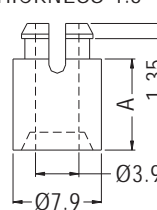

FOR M3.5 SCREW

PART NO	A	PACKAGE
SS3.5-6.3	6.3	1000
SS3.5-9.5	9.5	
SS3.5-12.7	12.7	
SS3.5-15	15.9	

SPACER SUPPORT



- ◆ MATERIAL: NYLON 66 (UL)
- ◆ FLAME CLASS: 94V-2/94V-0
- ◆ COLOR: NATURAL/BLACK
- ◆ UNIT: mm

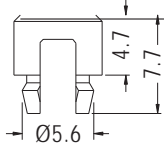

CHASSIS Ø5.0
THICKNESS 0.8

PART NO	PACKAGE
CUS-5	2000

