

SPACER SUPPORT

- ◆ MATERIAL: NYLON 66 (UL)
- ◆ FLAME CLASS: 94V-2/94V-0
- ◆ COLOR: NATURAL/BLACK
- ◆ UNIT: mm

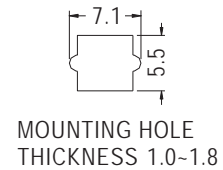
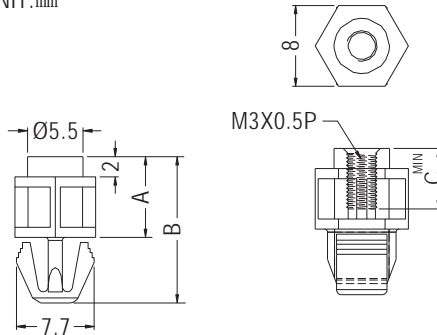

MOUNTING HOLE THICKNESS 1.0-1.8

PARTNO	A	B	C	PACKAGE
KVLM3-5	5.0	11.5	3.0	1000
KVLM3-6	6.0	12.5	4.0	
KVLM3-6.35	6.35	12.85	4.35	
KVLM3-8	8.0	14.5	6.0	
KVLM3-9.5	9.5	16.0	8.0	
KVLM3-10	10.0	16.5	8.0	

PARTNO	A	B	C	PACKAGE
KVLM3-12	12.0	18.5	8.0	1000
KVLM3-12.7	12.7	19.2	8.0	
KVLM3-15.9	15.9	22.4	8.0	
KVLM3-18	18.0	24.5	8.0	
KVLM3-20	20.0	26.5	8.0	
KVLM3-22	22.0	28.5	8.0	
KVLM3-25.4	25.4	31.9	8.0	

SPACER SUPPORT

- ◆ MATERIAL: NYLON 66 (UL)
- ◆ FLAME CLASS: 94V-2/94V-0
- ◆ COLOR: NATURAL/BLACK
- ◆ UNIT: mm



P.C.B Ø3.0 THICKNESS: E

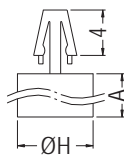

FOR DCB-2-DCB-4

P.C.B Ø3.0 THICKNESS: E

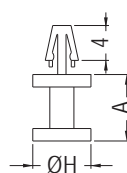

PARTNO	A	E	H	PACKAGE
DCB-2	2.0	1.6	6.5	2000
DCB-2.5	2.5	1.6	6.5	
DCB-3	3.0	1.6	6.8	
DCB-3.5	3.5	1.6	6.8	
DCB-4	4.0	1.6	6.8	
DCB-5	5.0	1.6	6.0	
DCB-5.8	5.8	1.6	6.9	
DCB-6	6.0	1.6	6.8	
DCB-6.5	6.5	1.6	6.0	1000
DCB-7	7.0	1.6	6.0	
DCB-8	8.0	1.6	6.8	
DCB-8(2)	8.0	2.1	6.8	
DCB-10	10.0	1.6	6.8	
DCB-15	15.0	1.6	6.0	
DCB-15L	15.0	1.6	15.0	

P.C.B Ø3.0 THICKNESS: E

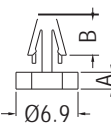

FOR DCB-2D~DCB-3.5D

P.C.B Ø3.0 THICKNESS: E

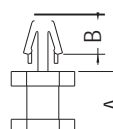

P.C.B Ø3.0 THICKNESS 3.0

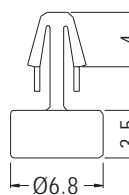

DCBA-3.5	1000
----------	------

PARTNO	A	B	E	PACKAGE
DCB-2D	2.0	3.5	1.2~1.7	2000
DCB-3D	3.0	3.7	1.2~1.6	
DCB-3.5D	3.5	4.0	1.2~1.6	
DCB-4D	4.0	3.6	1.2~1.7	1000
DCB-4.5D	4.5	3.6	1.2~1.7	
DCB-5D	5.0	3.6	1.2~1.7	
DCB-5.5D	5.5	4.0	1.2~1.6	
DCB-7D	7.0	4.0	1.2~1.6	
DCB-8D	8.0	3.85	1.2~1.7	
DCB-8.5D	8.5	4.0	1.2~1.7	
DCB-9D	9.0	4.0	1.2~1.6	
DCB-11D	11.0	3.7	1.2~1.6	
DCB-12D	12.0	4.0	1.2~1.6	
DCB-13D	13.0	4.0	1.2~1.6	

