

SPACER SUPPORT

NEW



- ◆ MATERIAL: NYLON 66 (UL)
- ◆ FLAME CLASS: 94V-2/94V-0
- ◆ COLOR: NATURAL/BLACK
- ◆ UNIT: mm

P.C.B Ø3.9
THICKNESS 1.6

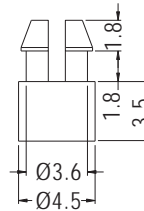

PART NO	PACKAGE
MSMA-3.5	2000

1

SPACER SUPPORT



- ◆ MATERIAL: NYLON 66 (UL)
- ◆ FLAME CLASS: 94V-2/94V-0
- ◆ COLOR: NATURAL/BLACK
- ◆ UNIT: mm

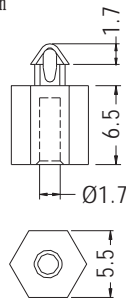

P.C.B Ø2.5
THICKNESS 1.6

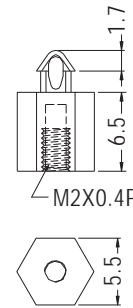

P.C.B Ø2.5
THICKNESS 1.6

- ◆ MAE-XT M2X0.4P

PART NO	PACKAGE
MAE2.5-6.5	2000

PART NO	PACKAGE
MAE2.5-6.5T	2000

SPACER SUPPORT

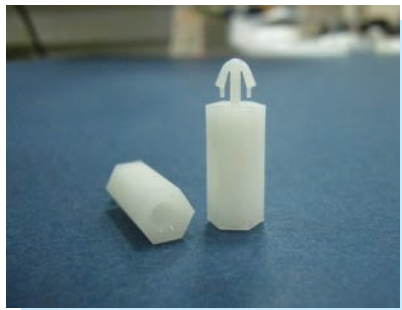

- ◆ MATERIAL: NYLON 66 (UL)
- ◆ FLAME CLASS: 94V-2/94V-0
- ◆ COLOR: NATURAL/BLACK
- ◆ UNIT: mm

P.C.B Ø3.0
THICKNESS 1.6

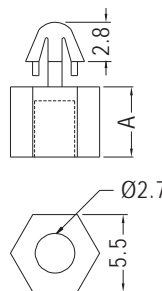

PART NO	A	PACKAGE
MAE-5	5.0	2000
MAE-6	6.0	
MAE-7	7.0	
MAE-8	8.0	
MAE-9	9.0	
MAE-10	10.0	1000
MAE-11	11.0	
MAE-12	12.0	
MAE-13	13.0	

PART NO	A	PACKAGE
MAE-14	14.0	1000
MAE-15	15.0	
MAE-16	16.0	
MAE-17	17.0	
MAE-18	18.0	
MAE-19	19.0	
MAE-20	20.0	
MAE-22	22.0	
MAE-23.5	23.5	
MAE-26	26.0	

P.C.B Ø3.0
THICKNESS 1.6

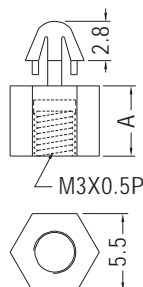

- ◆ MAE-XT M3X0.5P

PART NO	A	PACKAGE
MAE-5T	5.0	2000
MAE-6T	6.0	
MAE-7T	7.0	
MAE-8T	8.0	
MAE-9T	9.0	
MAE-10T	10.0	1000
MAE-11T	11.0	
MAE-12T	12.0	
MAE-13T	13.0	
MAE-14T	14.0	

PART NO	A	PACKAGE
MAE-15T	15.0	1000
MAE-16T	16.0	
MAE-17T	17.0	
MAE-18T	18.0	
MAE-19T	19.0	
MAE-20T	20.0	
MAE-22T	22.0	
MAE-23.5T	23.5	
MAE-26T	26.0	
MAE-27T	27.0	

