

SPACER SUPPORT

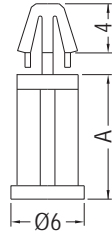

- ◆ MATERIAL: NYLON 66 (UL)
- ◆ FLAME CLASS: 94V-2/94V-0
- ◆ COLOR: NATURAL/BLACK
- ◆ UNIT: mm

P.C.B Ø3.5
 THICKNESS 0.8-1.6



PARTNO	A	PACKAGE
MCM-8	8.0	1000
MCM-1 4.5	14.5	

SPACER SUPPORT



- ◆ MATERIAL: NYLON 66 (UL)
- ◆ FLAME CLASS: 94V-2/94V-0
- ◆ COLOR: NATURAL/WHITE/BLACK
- ◆ UNIT: mm

P.C.B Ø4.0
 THICKNESS 1.2-1.6

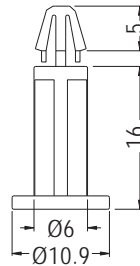

PARTNO	PACKAGE
MCO-16	1000

SPACER SUPPORT



- ◆ MATERIAL: NYLON 66 (UL)
- ◆ FLAME CLASS: 94V-2/94V-0
- ◆ COLOR: NATURAL/BLACK
- ◆ UNIT: mm

P.C.B Ø2.0
 THICKNESS: E

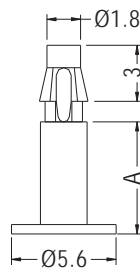

PARTNO	A	E	PACKAGE
MAST-6	6.0	1.0	1000
MAST-18	18.8	1.6	

SPACER SUPPORT



- ◆ MATERIAL: NYLON 66 (UL)
- ◆ FLAME CLASS: 94V-2/94V-0
- ◆ COLOR: NATURAL/BLACK
- ◆ UNIT: mm

P.C.B Ø2.0
 THICKNESS 2.4

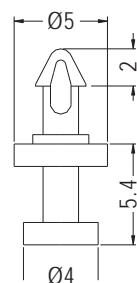

PARTNO	PACKAGE
MASL-5.4	1000

