

## SPACER SUPPORT

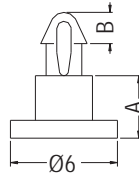

- ◆ MATERIAL: NYLON 66 (UL)
- ◆ FLAME CLASS: 94V-2/94V-0
- ◆ COLOR: NATURAL/BLACK
- ◆ UNIT: mm

P.C.B Ø2.0  
THICKNESS 1.6



PART NO	A	B	PACKAGE
MA-2.7DL	2.7	1.9	2000
MA-3.5DL	3.5	1.75	
MA-3.85DL	3.85	1.9	
MA-4.5DL	4.5	1.9	
MA-5DL	5.0	1.9	
MA-6.5DL	6.5	1.9	

## SPACER SUPPORT



- ◆ MATERIAL: NYLON 66 (UL)
- ◆ FLAME CLASS: 94V-2/94V-0
- ◆ COLOR: NATURAL/BLACK
- ◆ UNIT: mm

P.C.B Ø2.5  
THICKNESS 1.0

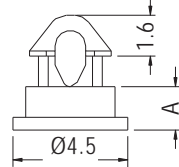

PART NO	A	PACKAGE
MAMS-1.7	1.7	2000
MAMS-5	5.0	

## SPACER SUPPORT



- ◆ MATERIAL: NYLON 66 (UL)
- ◆ FLAME CLASS: 94V-2/94V-0
- ◆ COLOR: NATURAL/BLACK
- ◆ UNIT: mm

P.C.B Ø2.5  
THICKNESS 1.6-1.8

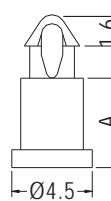

P.C.B Ø2.5  
THICKNESS 1.6-1.8

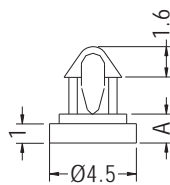

FOR MAM-1.5L

P.C.B Ø2.5  
THICKNESS 1.6

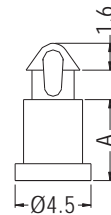

FOR MAM-4.8, MAM-6.4

PART NO	A	PACKAGE
MAM-1.5	1.5	2000
MAM-1.5L	1.5	
MAM-2.5	2.5	
MAM-2.7	2.7	
MAM-3	3.0	
MAM-3.2	3.2	
MAM-3.5	3.5	
MAM-4	4.0	
MAM-4.5	4.5	
MAM-4.8	4.8	
MAM-5	5.0	
MAM-5.7	5.7	
MAM-6	6.0	
MAM-6.4	6.4	

## SPACER SUPPORT



- ◆ MATERIAL: NYLON 66 (UL)
- ◆ FLAME CLASS: 94V-2/94V-0
- ◆ COLOR: NATURAL/BLACK
- ◆ UNIT: mm

**NEW**

P.C.B Ø2.7  
THICKNESS 1.6

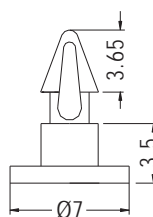

PART NO	PACKAGE
MAMA-3.5	1000