

SPACERSUPPORT

- ◆ MATERIAL: NYLON 66 (UL)
- ◆ FLAME CLASS: 94V-2/94V-0
- ◆ COLOR: NATURAL/BLACK
- ◆ UNIT: mm

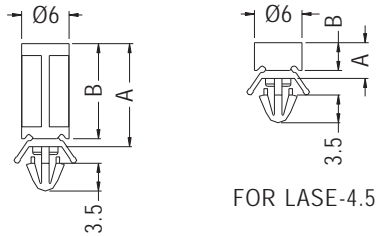

MOUNTING HOLE Ø3.5
 THICKNESS 1.2-1.6

| PART NO | A | B | PACKAGE |
|----------|------|------|---------|
| LASE-4.5 | 4.5 | 3.5 | 1000 |
| LASE-7 | 7.0 | 6.0 | |
| LASE-12 | 12.0 | 11.0 | |

SPACERSUPPORT

- ◆ MATERIAL: NYLON 66 (UL)
- ◆ FLAME CLASS: 94V-2/94V-0
- ◆ COLOR: NATURAL/BLACK
- ◆ UNIT: mm

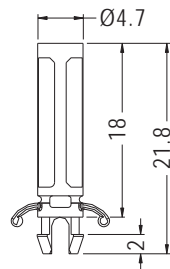
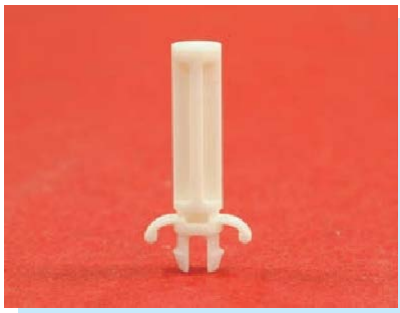

MOUNTING HOLE Ø4.0
 THICKNESS 1.2-1.6

| PART NO | PACKAGE |
|---------|---------|
| LASF-18 | 1000 |

SPACERSUPPORT

- ◆ MATERIAL: NYLON 66 (UL)
- ◆ FLAME CLASS: 94V-2/94V-0
- ◆ COLOR: NATURAL/WHITE/BLACK
- ◆ UNIT: mm

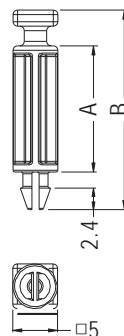

MOUNTING HOLE Ø3.0
 THICKNESS 1.6

| PART NO | A | B | PACKAGE |
|----------|------|------|---------|
| MSA-14.1 | 14.1 | 22.3 | 1000 |
| MSA-24.3 | 24.3 | 32.5 | |

