

# SPACER SUPPORT

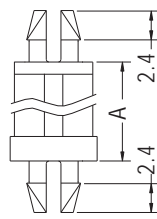

- ◆ MATERIAL: NYLON 66 (UL)
- ◆ FLAME CLASS: 94V-2/94V-0
- ◆ COLOR: NATURAL/BLACK
- ◆ UNIT: mm



P.C.B Ø4.0  
THICKNESS 1.6

P.C.B Ø4.0  
THICKNESS 1.6

PART NO	A	PACKAGE
MSPM-5	4.8	1000
MSPM-2.4	23.8	

# SPACERSUPPORT



- ◆ MATERIAL: NYLON 66 (UL)
- ◆ FLAME CLASS: 94V-2/94V-0
- ◆ COLOR: NATURAL/BLACK
- ◆ UNIT: mm

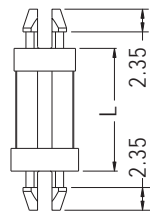

P.C.B Ø4.0  
THICKNESS 1.6

P.C.B Ø4.0  
THICKNESS 1.6

PART NO	L	PACKAGE
MSP1-6.4	6.4	1000
MSP1-9.5	9.5	
MSP1-10	10.0	
MSP1-12.7	12.7	
MSP1-15.9	15.9	
MSP1-19.1	19.1	
MSP1-22.2	22.2	
MSP1-25.4	25.4	

# SPACER SUPPORT



- ◆ MATERIAL: NYLON 66 (UL)
- ◆ FLAME CLASS: 94V-2/94V-0
- ◆ COLOR: NATURAL/BLACK
- ◆ UNIT: mm

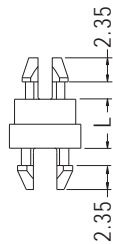

P.C.B Ø4.0  
THICKNESS 1.6

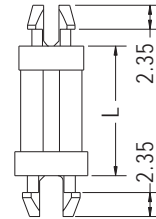

P.C.B Ø4.8  
THICKNESS 1.6

PART NO	L	PACKAGE
MSPK45-4.8	4.8	2000
MSPK45-6.4	6.4	
MSPK45-9.5	9.5	
MSPK45-12.7	12.7	1000
MSPK45-15.9	15.9	
MSPK45-19.1	19.1	
MSPK45-22.2	22.2	
MSPK45-25.4	25.4	

FOR MSPK45-4.8

# SPACERSUPPORT



- ◆ MATERIAL: NYLON 66 (UL)
- ◆ FLAME CLASS: 94V-2/94V-0
- ◆ COLOR: NATURAL/BLACK
- ◆ UNIT: mm

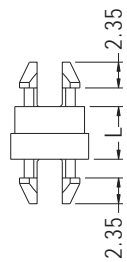

FOR MSPK4.8-4.8

P.C.B Ø4.8  
THICKNESS 1.6

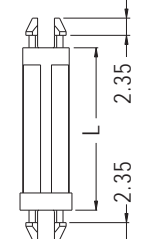

P.C.B Ø4.8  
THICKNESS 1.6

PART NO	L	PACKAGE
MSPK4.8-4.8	4.8	2000
MSPK4.8-6.4	6.4	
MSPK4.8-9.5	9.5	
MSPK4.8-12.7	12.7	1000
MSPK4.8-15.9	15.9	
MSPK4.8-19.1	19.1	
MSPK4.8-22.2	22.2	
MSPK4.8-25.4	25.4	
MSPK4.8-31.7	31.75	

